

G100 Series

Pneumatic Parallel Grippers



Robohand

www.comoso.com

G100 Series Pneumatic Grippers

Robohand Gripping Solutions

Delivering better performance, lower maintenance, faster operation without added costs to machine builders.



The Industry Standard for Machine Builders

- **Low Maintenance:** Shielded design ensures continuous operation in variety of manufacturing environments.
- **Compact Design:** High force, low profile, with a variety of stroke ranges.
- **Easy Commissioning:** Simple quick installation kits.
- **Globally Supported:** Global application support and service teams.
- **Economical:** Cost effective solutions with short delivery times.

G100 Series At-a-Glance

- 20 different models sized to match your application needs.
- Fast actuations from 60mS.
- Multiple stroke options from 5mm to 50mm.
- High grip force, small package from 56N to 558N (13 to 125 lbf).
- Shielded design for clean to moderate manufacturing environments.
- Interchangeable gripper fingers with competitive units using extended jaw option.

G100 Series Pneumatic Grippers

Accelerated Productivity: Twice the actuation speed of competing units reducing manufacturing cycle times.

Low Maintenance: Shielded design ensures continuous operation in variety of manufacturing environments.

Performance: High grip force, low profile, with strokes from 5mm to 50mm.

Smooth Operation: Rack and pinion design provides consistent gripping actuation.

Space Saving: Compact design minimizes height profile for constrained application space.

Interchangeable Finger Design: Re-use gripper fingers used on competing units with G100 series extended jaw option.



shown with extended jaw option

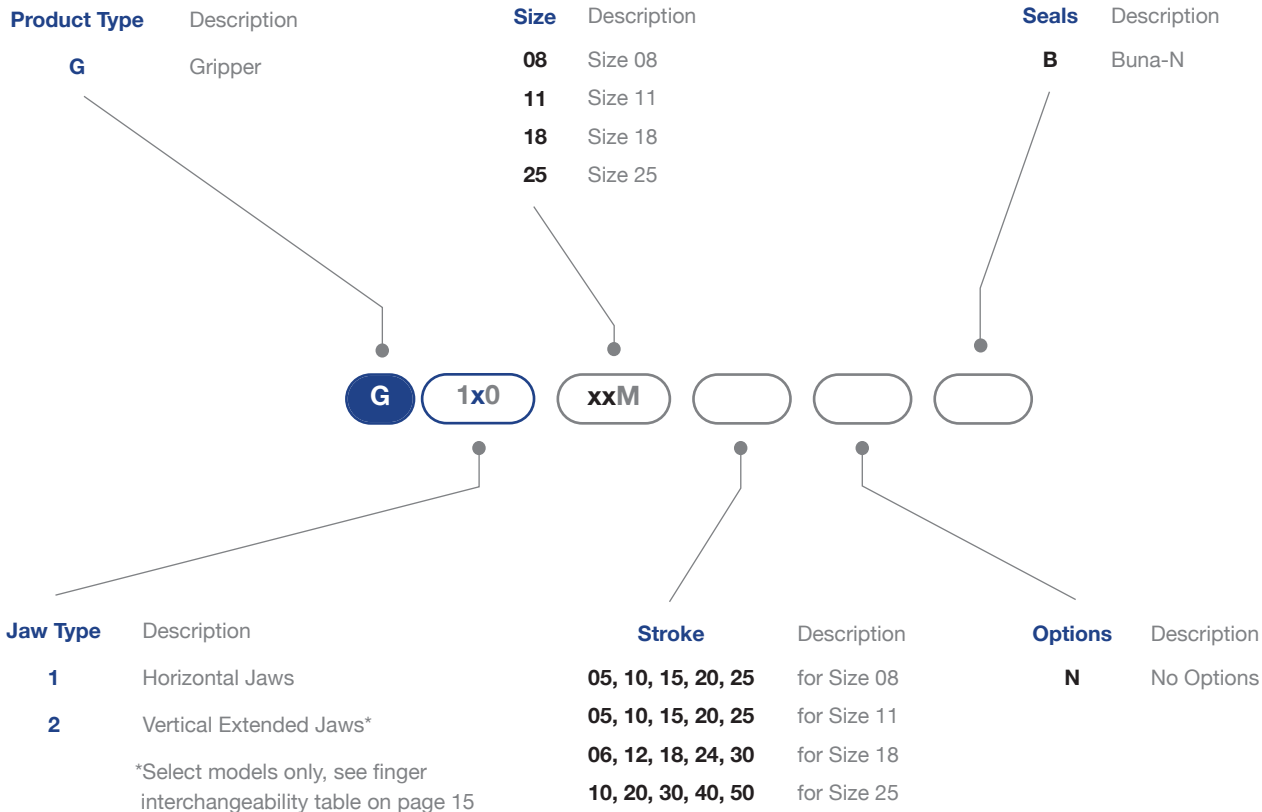

G110-08M Dimensions



Dimensions & Specs Common to All Strokes

Total Rated Grip Force	56 N	13 lbf
Pressure Range	3-7 Bar	40-100 psi
Cylinder Bore Diameter	8 mm	0.31 in
Temperature Range, Buna Seals	-35°C~80°C	-30°F~180°F
Accuracy	+/- .08 mm	+/- .003 in
Repeatability	+/- .08 mm	+/- .003 in
Valve Required to Actuate	4 way 2 position	

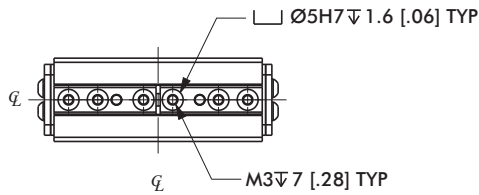
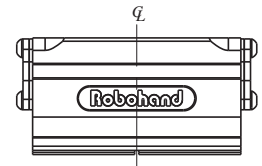
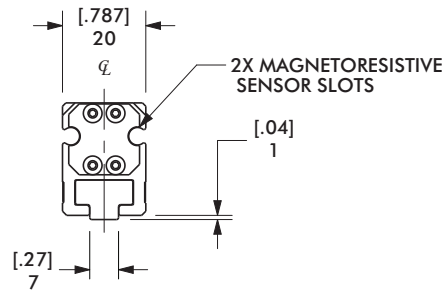
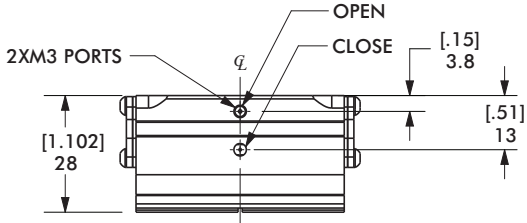
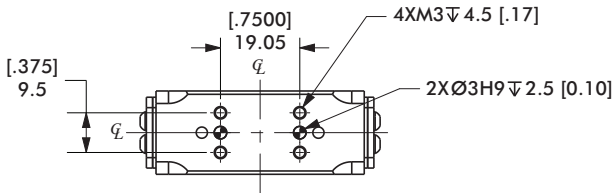

UNLESS OTHERWISE NOTED ALL TOLERANCES ARE AS SHOWN BELOW

Dimensions are symmetrical about centerline	Third Angle Projection	All Dowel Holes are SF (Slip Fit). Local Tolerance: ±.0005" or ±.013mm	Metric Threads Course Pitch	Imperial in. 0.00 = ±.01 0.000 = ±.005 0.0000 = ±.0005	Metric (mm) [0.] = ±.25 [0.0] = ±.13 [0.00] = ±.013
---	------------------------	---	--------------------------------	--	---

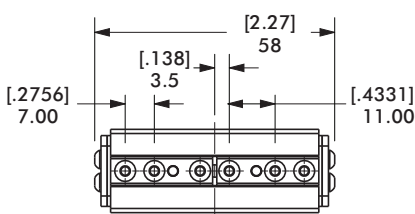

G110-08M-10

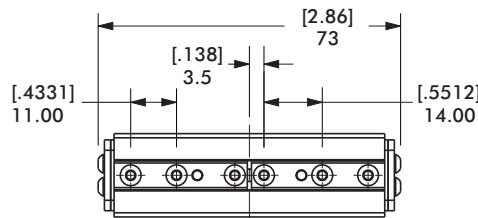

G110-08M-15

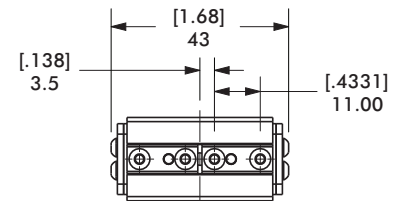

G110-08M-05

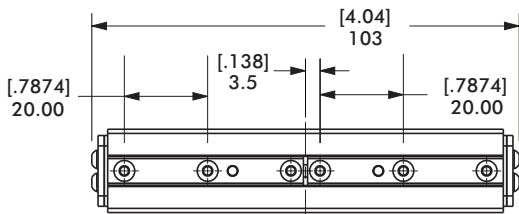

G110-08M-25

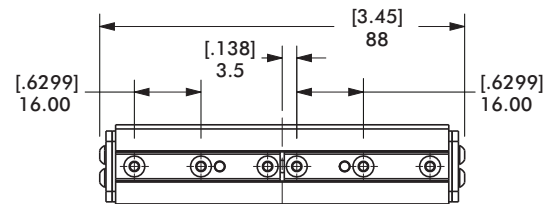

G110-08M-20

G110-08M Technical Data

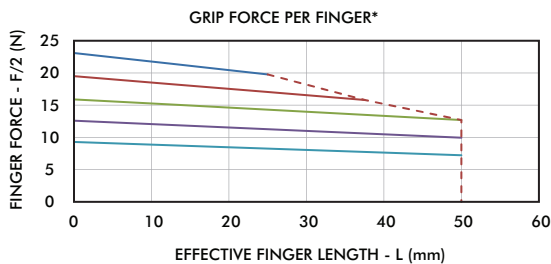

G110-08M-05-N-B

Stroke	5 mm	0.20 in
Weight	0.06 Kg	0.13 lbf
Displacement	0.3 cc	0.02 cu-in
Actuation	0.06 sec	0.06 sec
Max Tensile Load on Jaws	156 N	35 lbf
Max Compressive Load on Jaws	356 N	80 lbf
Max Moment on Jaws	3.4 Nm	30 in-lbs

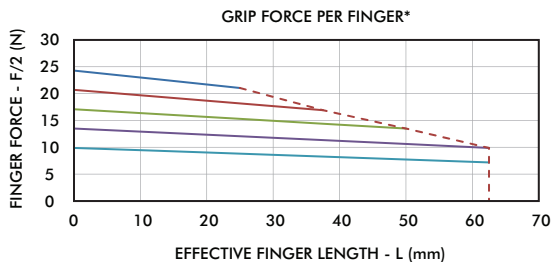

G110-08M-10-N-B

Stroke	10 mm	0.39 in
Weight	0.09 Kg	0.20 lbf
Displacement	0.5 cc	0.03 cu-in
Actuation	0.07 sec	0.07 sec
Max Tensile Load on Jaws	178 N	40 lbf
Max Compressive Load on Jaws	378 N	86 lbf
Max Moment on Jaws	4 Nm	35 in-lbs

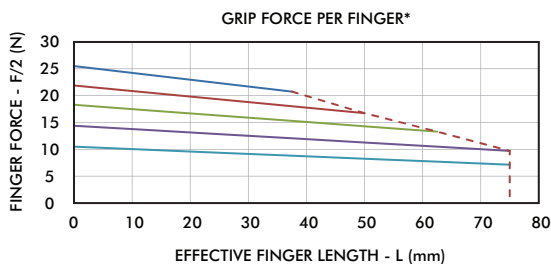

G110-08M-15-N-B

Stroke	15 mm	0.59 in
Weight	0.11 Kg	0.24 lbf
Displacement	0.7 cc	0.05 cu-in
Actuation	0.08 sec	0.08 sec
Max Tensile Load on Jaws	200 N	45 lbf
Max Compressive Load on Jaws	400 N	90 lbf
Max Moment on Jaws	4.6 Nm	40 in-lbs

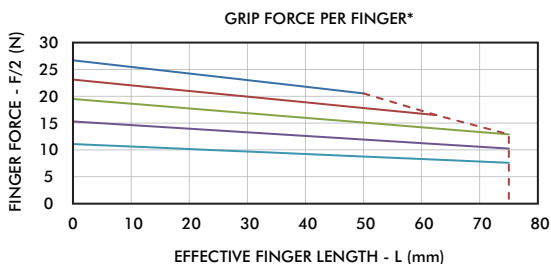

G110-08M-20-N-B

Stroke	20 mm	0.79 in
Weight	0.14 Kg	0.31 lbf
Displacement	1.0 cc	0.06 cu-in
Actuation	0.09 sec	0.09 sec
Max Tensile Load on Jaws	222 N	50 lbf
Max Compressive Load on Jaws	423 N	95 lbf
Max Moment on Jaws	5.0 Nm	45 in-lbs

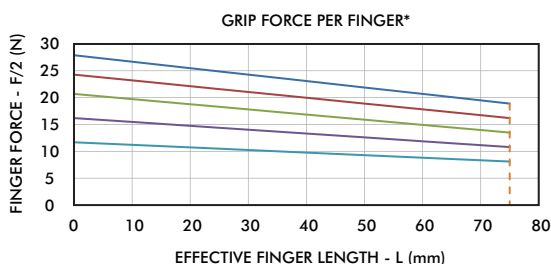

G110-08M-25-N-B

Stroke	25 mm	0.98 in
Weight	0.17 Kg	0.37 lbf
Displacement	1.2 cc	0.08 cu-in
Actuation	0.10 sec	0.10 sec
Max Tensile Load on Jaws	245 N	55 lbf
Max Compressive Load on Jaws	445 N	100 lbf
Max Moment on Jaws	5.6 Nm	50 in-lbs

WARNING! DO NOT EXCEED MAXIMUM EFFECTIVE FINGER LENGTH

- 7 bar (102 psi)
- 6 bar (87 psi)
- 5 bar (73 psi)
- 4 bar (58 psi)
- 3 bar (44 psi)
- - - MAX FINGER LENGTH

G110-11M Dimensions

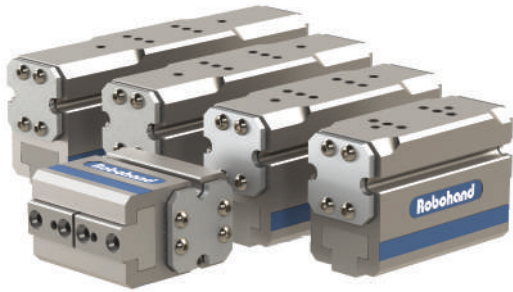

Dimensions & Specs Common to all Strokes

Total Rated Grip Force	104 N	23 lbf
Pressure Range	3-7 Bar	40-100 psi
Cylinder Bore Diameter	11 mm	0.44 in
Temperature Range, Buna Seals	-35°C~80°C	-30°F~180°F
Accuracy	+/- .08 mm	+/- .003 in
Repeatability	+/- .08 mm	+/- .003 in
Valve Required to Actuate	4 way 2 position	

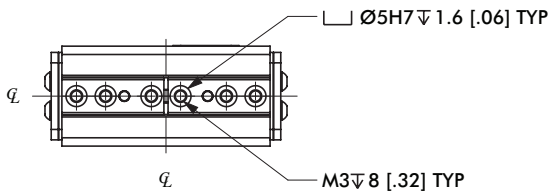
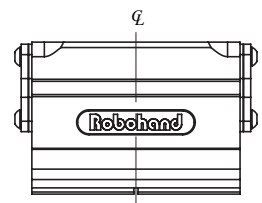
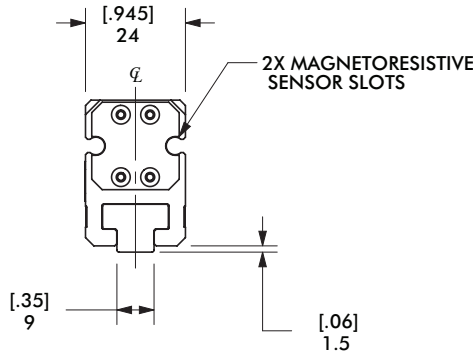
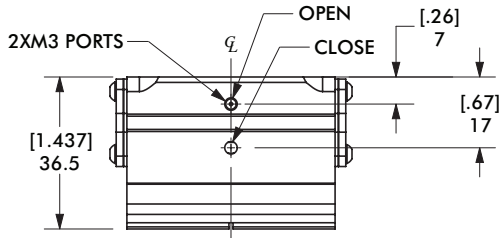
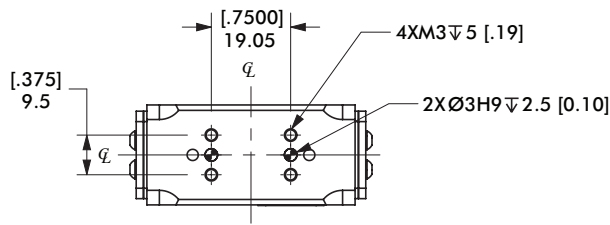

UNLESS OTHERWISE NOTED ALL TOLERANCES ARE AS SHOWN BELOW

Dimensions are symmetrical about centerline	Third Angle Projection	All Dowel Holes are SF (Slip Fit). Locational Tolerance ±.0005" or ±.013mm	Metric Threads Course Pitch	Imperial in. 0.00 = ±.01 0.000 = ±.005 0.0000 = ±.0005	Metric [mm] [0.] = ±.25 [0.0] = ±.13 [0.00] = ±.013
---	------------------------	---	--------------------------------	--	---

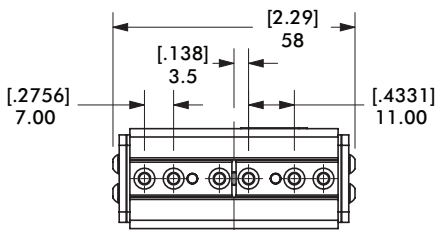

G110-11M-10

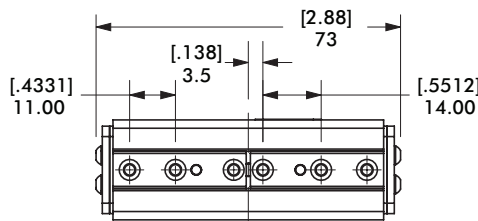

G110-11M-15

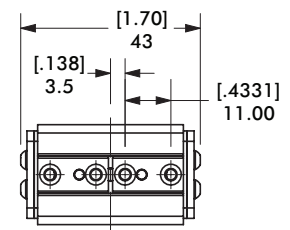

G110-11M-05

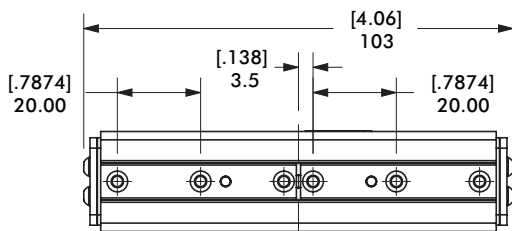

G110-11M-25

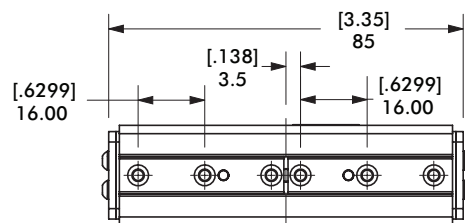

G110-11M-20

G110-11M Technical Data

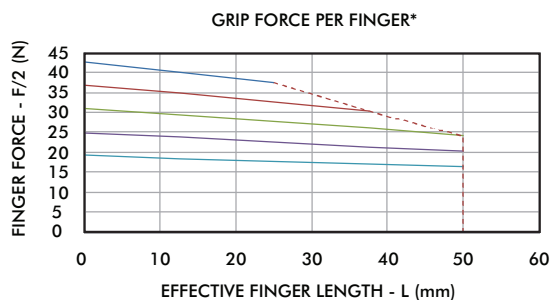

G110-11M-05-N-B

Stroke	5 mm	0.20 in
Weight	0.09 Kg	0.20 lbf
Displacement	0.5 cc	0.03 cu-in
Actuation	0.08 sec	0.08 sec
Max Tensile Load on Jaws	311 N	70 lbf
Max Compressive Load on Jaws	712 N	160 lbf
Max Moment on Jaws	7 Nm	60 in-lbs

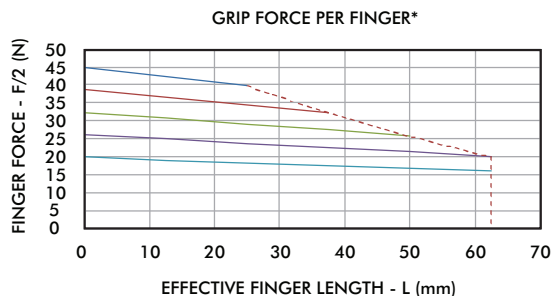

G110-11M-10-N-B

Stroke	10 mm	0.39 in
Weight	0.13 Kg	0.29 lbf
Displacement	1.0 cc	0.06 cu-in
Actuation	0.09 sec	0.09 sec
Max Tensile Load on Jaws	350 N	80 lbf
Max Compressive Load on Jaws	750 N	170 lbf
Max Moment on Jaws	8 Nm	70 in-lbs

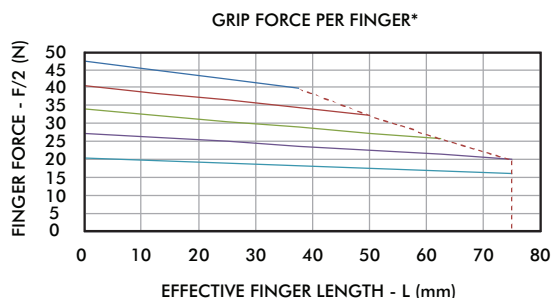

G110-11M-15-N-B

Stroke	15 mm	0.59 in
Weight	0.17 Kg	0.37 lbf
Displacement	1.5 cc	0.09 cu-in
Actuation	0.10 sec	0.10 sec
Max Tensile Load on Jaws	400 N	90 lbf
Max Compressive Load on Jaws	800 N	180 lbf
Max Moment on Jaws	9 Nm	80 in-lbs

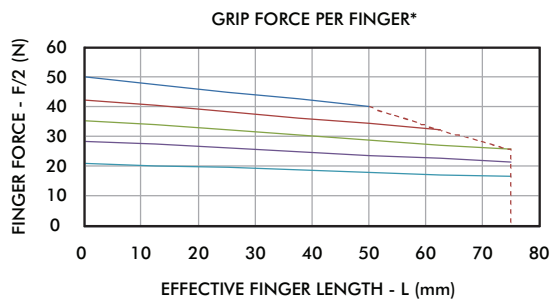

G110-11M-20-N-B

Stroke	20 mm	0.79 in
Weight	0.21 Kg	0.46 lbf
Displacement	1.9 cc	0.12 cu-in
Actuation	0.11 sec	0.11 sec
Max Tensile Load on Jaws	445 N	100 lbf
Max Compressive Load on Jaws	845 N	190 lbf
Max Moment on Jaws	10 Nm	90 in-lbs

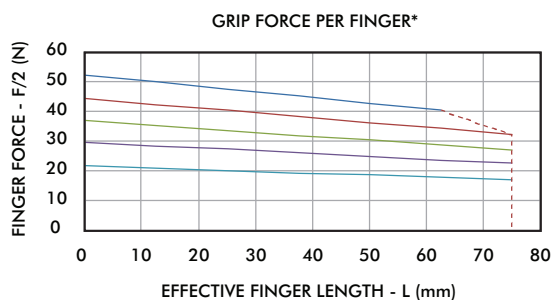

G110-11M-25-N-B

Stroke	25 mm	0.98 in
Weight	0.25 Kg	0.55 lbf
Displacement	1.2 cc	0.15 cu-in
Actuation	0.12 sec	0.12 sec
Max Tensile Load on Jaws	490 N	110 lbf
Max Compressive Load on Jaws	890 N	200 lbf
Max Moment on Jaws	11 Nm	100 in-lbs

WARNING! DO NOT EXCEED MAXIMUM EFFECTIVE FINGER LENGTH

- 7 bar (102 psi)
- 6 bar (87 psi)
- 5 bar (73 psi)
- 4 bar (58 psi)
- 3 bar (44 psi)
- - - MAX FINGER LENGTH

G110-18M Dimensions



Dimensions & Specs Common to all Strokes

Total Rated Grip Force	260 N	58 lbf
Pressure Range	3-7 Bar	40-100 psi
Cylinder Bore Diameter	17.5 mm	0.69 in
Temperature Range, Buna Seals	-35°C~80°C	-30°F~180°F
Accuracy	+/- .08 mm	+/- .003 in
Repeatability	+/- .08 mm	+/- .003 in
Valve Required to Actuate	4 way 2 position	

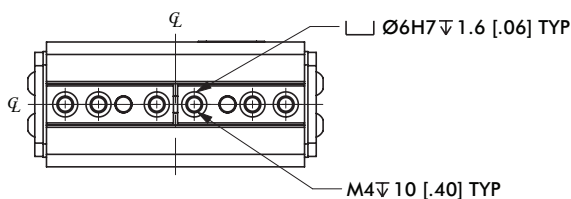
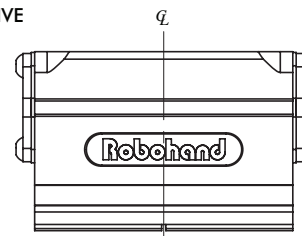
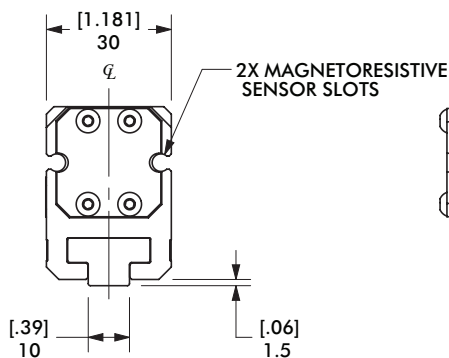
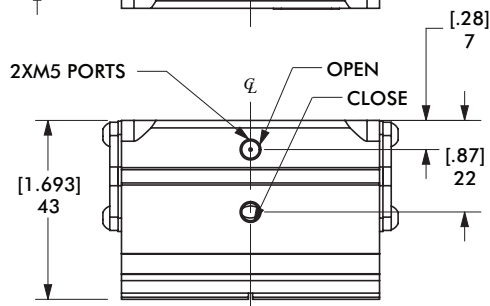
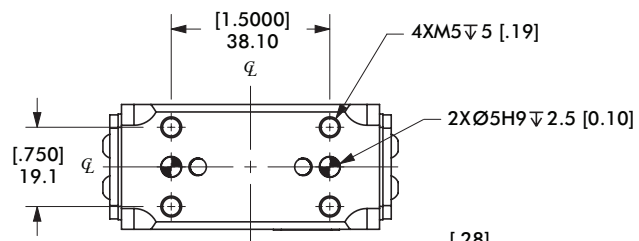

UNLESS OTHERWISE NOTED ALL TOLERANCES ARE AS SHOWN BELOW

	Imperial in.	Metric [mm]
\varnothing Dimensions are symmetrical about centerline	0.00 = ±.01	[0.] = [±.25]
\triangle Third Angle Projection	0.000 = ±.005	[0.0] = [±.13]
\odot All Dowel Holes are SF (Slip Fit). Locational Tolerance ±.0005" or [±.013mm]	0.0000 = ±.0005	[0.00] = [±.013]
\oplus Metric Threads Course Pitch		

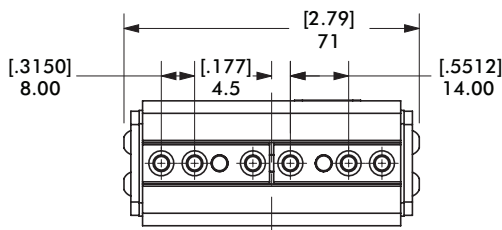

G110-18M-12

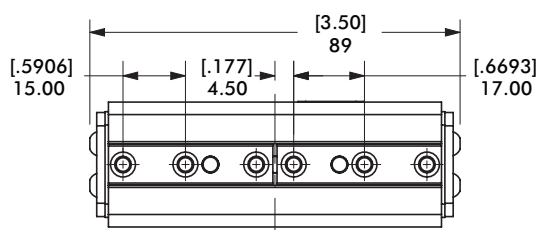

G110-18M-18

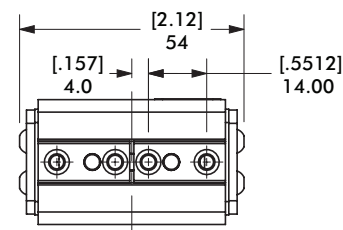

G110-18M-06

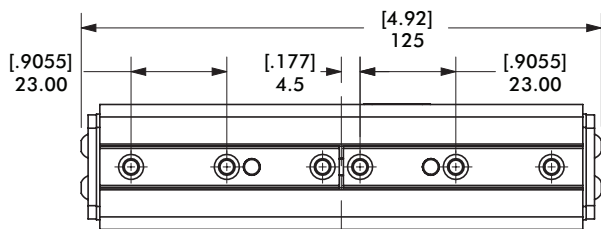

G110-18M-30

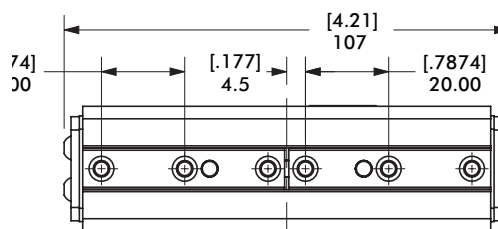

G110-18M-24

G110-18M Technical Data

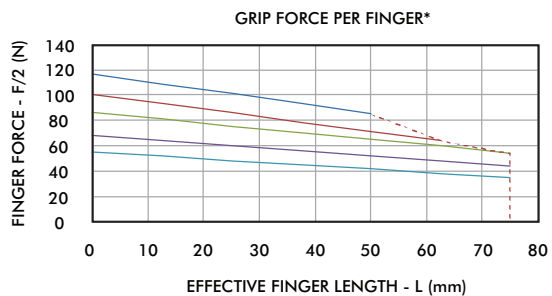

G110-18M-06-N-B		
Stroke	6 mm	0.24 in
Weight	0.20 Kg	0.44 lbf
Displacement	1.5 cc	0.09 cu-in
Actuation	0.09 sec	0.09 sec
Max Tensile Load on Jaws	778 N	175 lbf
Max Compressive Load on Jaws	1779 N	400 lbf
Max Moment on Jaws	17 Nm	150 in-lbs

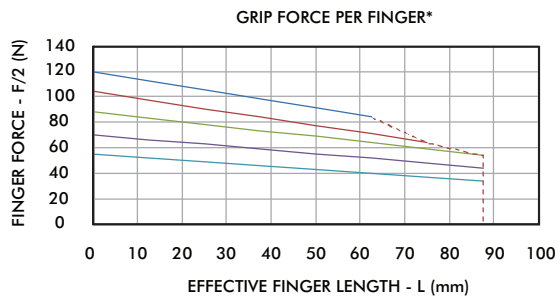

G110-18M-12-N-B		
Stroke	12 mm	0.47 in
Weight	0.22 Kg	0.48 lbf
Displacement	2.9 cc	0.18 cu-in
Actuation	0.13 sec	0.13 sec
Max Tensile Load on Jaws	890 N	200 lbf
Max Compressive Load on Jaws	1890 N	425 lbf
Max Moment on Jaws	20 Nm	175 in-lbs

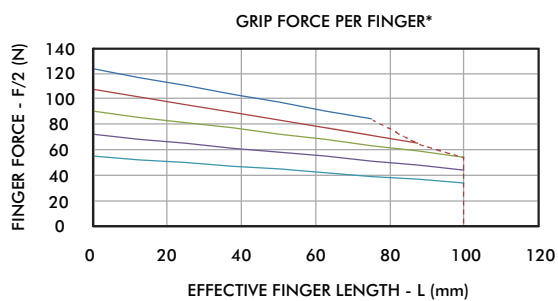

G110-18M-18-N-B		
Stroke	18 mm	0.71 in
Weight	0.28 Kg	0.62 lbf
Displacement	4.3 cc	0.26 cu-in
Actuation	0.17 sec	0.17 sec
Max Tensile Load on Jaws	1000 N	225 lbf
Max Compressive Load on Jaws	2000 N	450 lbf
Max Moment on Jaws	23 Nm	200 in-lbs

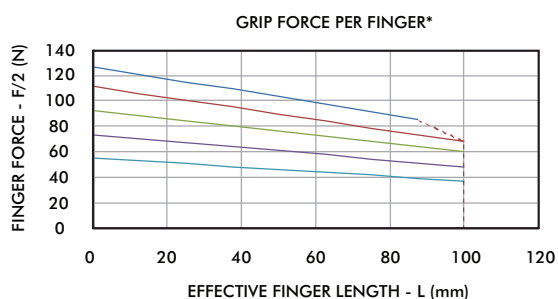

G110-18M-24-N-B		
Stroke	24 mm	0.94 in
Weight	0.34 Kg	0.75 lbf
Displacement	5.8 cc	0.35 cu-in
Actuation	0.21 sec	0.21 sec
Max Tensile Load on Jaws	1112 N	250 lbf
Max Compressive Load on Jaws	2113 N	475 lbf
Max Moment on Jaws	25 Nm	225 in-lbs

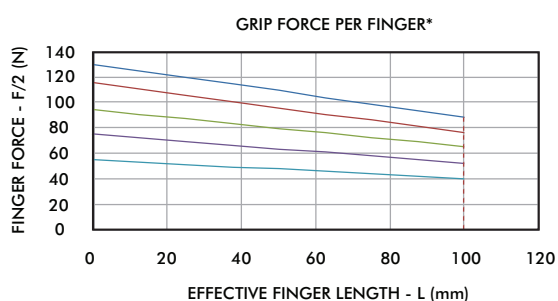

G110-18M-30-N-B		
Stroke	30 mm	1.18 in
Weight	0.41 Kg	0.90 lbf
Displacement	7.2 cc	0.44 cu-in
Actuation	0.25 sec	0.25 sec
Max Tensile Load on Jaws	1223 N	275 lbf
Max Compressive Load on Jaws	2225 N	500 lbf
Max Moment on Jaws	28 Nm	250 in-lbs

WARNING! DO NOT EXCEED MAXIMUM EFFECTIVE FINGER LENGTH

- 7 bar (102 psi)
- 6 bar (87 psi)
- 5 bar (73 psi)
- 4 bar (58 psi)
- 3 bar (44 psi)
- - - MAX FINGER LENGTH

G110-25M Dimensions

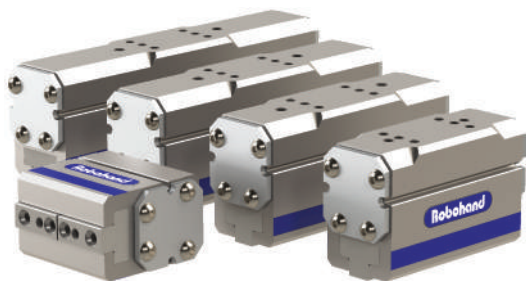

Dimensions & Specs Common to all Strokes

Total Rated Grip Force	558 N	125 lbf
Pressure Range	3-7 Bar	40-100 psi
Cylinder Bore Diameter	25 mm	1.00 in
Temperature Range, Buna Seals	-35°C~80°C	-30°F~180°F
Accuracy	+/- .08 mm	+/- .003 in
Repeatability	+/- .08 mm	+/- .003 in
Valve Required to Actuate	4 way 2 position	

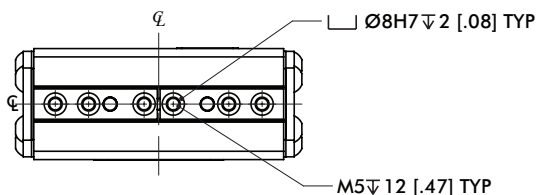
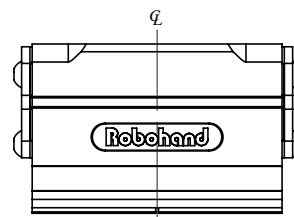
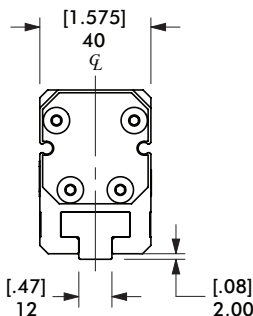
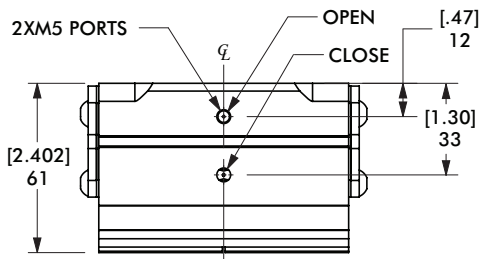
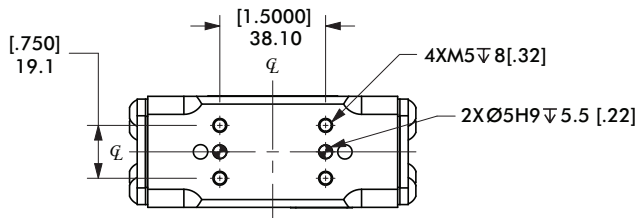

UNLESS OTHERWISE NOTED ALL TOLERANCES ARE AS SHOWN BELOW

				Imperial in. 0.00 = ±.01 0.000 = ±.005 0.0000 = ±.0005	Metric [mm] [0.] = ±.25 [0.0] = ±.13 [0.00] = ±.013
--	--	--	--	--	---

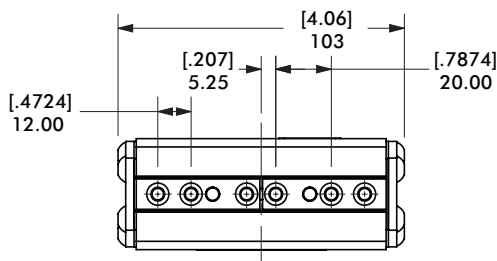

G110-25M-20

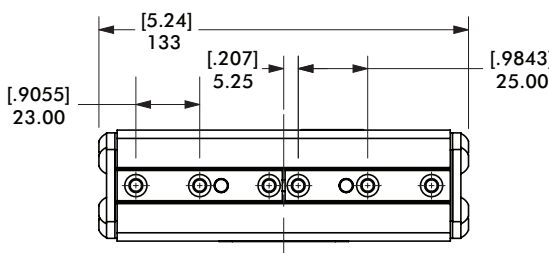

G110-25M-30

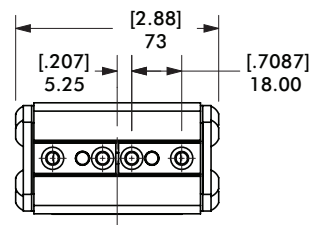

G110-25M-10

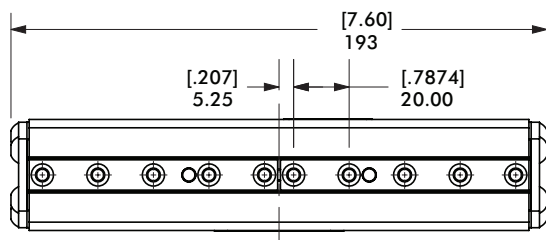

G110-25M-50

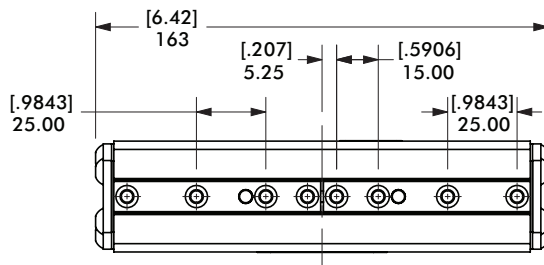

G110-25M-40

G110-25M Technical Data

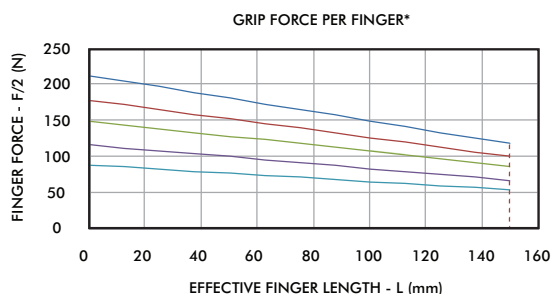

G110-25M-10-N-B

Stroke	10 mm	0.39 in
Weight	0.42 Kg	0.92 lbf
Displacement	5.06 cc	0.31 cu-in
Actuation	0.28 sec	0.28 sec
Max Tensile Load on Jaws	1550 N	350 lbf
Max Compressive Load on Jaws	3550 N	800 lbf
Max Moment on Jaws	35 Nm	300 in-lbs

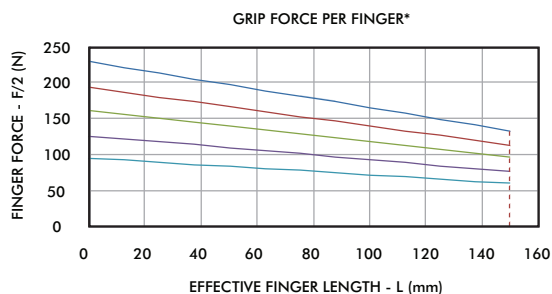

G110-25M-20-N-B

Stroke	20 mm	0.79 in
Weight	0.64 Kg	1.41 lbf
Displacement	10.12 cc	0.62 cu-in
Actuation	0.36 sec	0.36 sec
Max Tensile Load on Jaws	1750 N	400 lbf
Max Compressive Load on Jaws	3775 N	850 lbf
Max Moment on Jaws	40 Nm	350 in-lbs

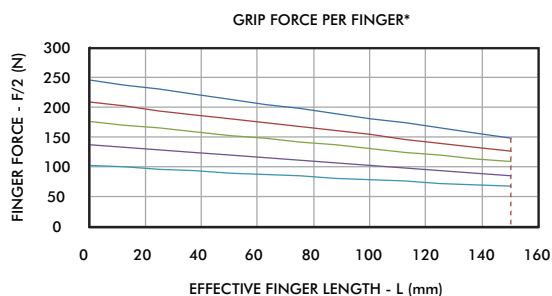

G110-25M-30-N-B

Stroke	30 mm	1.18 in
Weight	0.85 Kg	1.87 lbf
Displacement	15.19 cc	0.93 cu-in
Actuation	0.44 sec	0.44 sec
Max Tensile Load on Jaws	2000 N	450 lbf
Max Compressive Load on Jaws	4000 N	900 lbf
Max Moment on Jaws	45 Nm	400 in-lbs

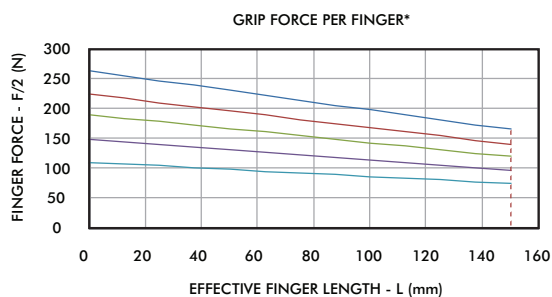

G110-25M-40-N-B

Stroke	40 mm	1.57 in
Weight	1.03 Kg	2.27 lbf
Displacement	20.3 cc	1.24 cu-in
Actuation	0.52 sec	0.52 sec
Max Tensile Load on Jaws	2225 N	500 lbf
Max Compressive Load on Jaws	4225 N	950 lbf
Max Moment on Jaws	50 Nm	450 in-lbs

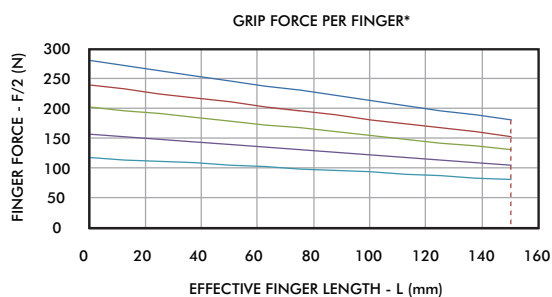

G110-25M-50-N-B

Stroke	50 mm	1.97 in
Weight	1.22 Kg	2.68 lbf
Displacement	25.31 cc	1.55 cu-in
Actuation	0.61 sec	0.61 sec
Max Tensile Load on Jaws	2450 N	550 lbf
Max Compressive Load on Jaws	4450 N	1000 lbf
Max Moment on Jaws	55 Nm	500 in-lbs

WARNING! DO NOT EXCEED MAXIMUM EFFECTIVE FINGER LENGTH

- 7 bar (102 psi)
- 6 bar (87 psi)
- 5 bar (73 psi)
- 4 bar (58 psi)
- 3 bar (44 psi)
- - - MAX FINGER LENGTH

G100 Series Accessories

G100 Series Common Accessories

Part Number	Description	Qty Required
OHSN-021	Sensor, NPN magneto resistive type, 4mm Barrel	1, 2, 3 or 4
OHSP-021	Sensor, PNP magneto resistive type, 4mm Barrel	1, 2, 3 or 4
CABL-010	Cable straight, quick disconnect, socket, 3 conductor, 2M length	1, 2, 3 or 4



Cable Straight, Quick Disconnect,
Socket, 3 Conductor, 2M Length

OHSP-021

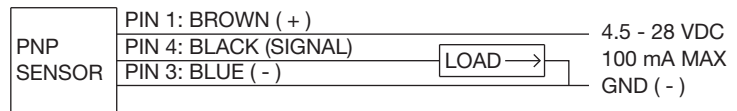

OHSN-021

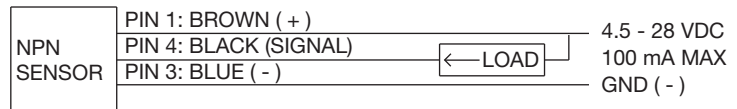

Long Barrel 4mm Straight Sensor

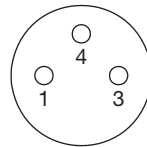

PIN 1: BROWN (+)

PIN 3: BLUE (-)

PIN 4: BLACK (SIGNAL)

G110-08M, G120-08M Accessories

Part Number	Description	Qty Required
PLFT-021	Pneumatic air fitting, straight M3 screw to 3mm tube push-in	2
20961-11	Jaw locating sleeve for precise finger mounting	4
SLKT-244	Includes: End gasket G110-08M (Qty 2) Seal: U-cup buna replacement seal (Qty 4) Button head socket cap screws (Qty 8)	1

G110-11M , G120-11M Accessories

Part Number	Description	Qty Required
PLFT-021	Pneumatic air fitting, straight M3 screw to 3mm tube push-in	2
20961-11	Jaw locating sleeve for precise finger mounting	4
SLKT-245	Includes: End gasket G110-11M (Qty 2) Seal: U-cup buna replacement seal (Qty 4) Button head socket cap screws (Qty 8)	1

G100 Series Accessories

G110-18M, G120-18M Accessories

Part Number	Description	Qty Required
PLFT-041	Pneumatic air fitting, right angle, M5 screw to 6mm tube push-in	2
OFSV-004	Valve kit, failsafe, M5 ports	1
20962-11	Jaw locating sleeve for precise finger mounting	4
SLKT-246	Includes: End gasket G110-18M (Qty 2) Seal: U-cup buna replacement seal (Qty 4) Button head socket cap screws (Qty 8)	1

G110-25M, G120-25M Accessories

Part Number	Description	Qty Required
PLFT-041	Pneumatic air fitting, right angle, M5 screw to 6mm tube push-in	2
OFSV-004	Valve kit, failsafe, M5 ports	1
20963-11	Jaw locating sleeve for precise finger mounting	4
SLKT-247	Includes: End gasket G110-25M (Qty 2) Seal: U-cup bunareplacement seal (Qty 4) Button head socket cap screws (Qty 8)	1



Pneumatic Air Fittings



End Gasket



Jaw Locating Sleeve for Precise Finger Mounting



Valve Kit, Failsafe, M5 Ports



U-cup Buna Replacement Seal



Button Head Socket Cap Screws

G100 Series Quick Installation Kits

Commissioning Kits for Easy Ordering

- Includes just what you need for easy installation.
- One quick installation kit required per gripper.
- Fast, simple convenient ordering.



2 Sensors



2 Air Fittings



4 Jaw Locating Finger Sleeves



4 Finger Mounting Screws

G110-08M, G120-08M Quick Installation Kits

Part Number	Includes	Quantity	Description
G110-QKST-101	OHSP-021	2	Sensor, PNP magneto resistive type, 4mm barrel
	PLFT-021	2	Pneumatic air fitting, M3 screw to 3mm tube push-in
	20961-11	4	Jaw locating sleeve for precise finger mounting
	SHSM02.5C10	4	Finger mounting screws

G110-11M, G120-11M Quick Installation Kits

zPart Number	Includes	Quantity	Description
G110-QKST-102	OHSP-021	2	Sensor, PNP magneto Resistive type, 4mm barrel
	PLFT-021	2	Pneumatic air fitting, M3 screw to 3mm tube push-in
	20961-11	4	Jaw locating sleeve for precise finger mounting
	SHSM03C10	4	Finger mounting screws

G110-18M, G120-18M Quick Installation Kits

Part Number	Includes	Quantity	Description
G110-QKST-103	OHSP-021	2	Sensor, PNP magneto resistive type, 4mm Barrel
	PLFT-041	2	Pneumatic air fitting, right angle, M5 screw to 6mm tube push-in
	20962-11	4	Jaw locating sleeve for precise finger mounting
	SHSM04C12	4	Finger mounting screws

G110-25M, G120-25M Quick Installation Kits

Part Number	Includes	Quantity	Description
G110-QKST-104	OHSP-021	2	Sensor, PNP magneto resistive type, 4mm barrel
	PLFT-041	2	Pneumatic air fitting, right angle, M5 screw to 6mm tube push-in
	20963-11	4	Jaw locating sleeve for precise finger mounting
	SHSM05C16	4	Finger mounting screws

G100 Series Interchangeable Fingers with Extended Gripper Jaw Option. Fast Gripper Commissioning

- Re-use your existing gripper fingers.
- Same finger mounting hole pattern as competitive units.
- G100 Series Grippers Deliver:
 - Low Maintenance Shielded Design
 - Smooth Rack and Pinion Operation
 - Fast cycle times down to 0.06 seconds
 - Low height profile
 - All-in-one Commissioning Kits

100% Finger Compatible



competitive model

G110 Extended Jaw Option, Finger Interchangeability Table* (G120 units ship with extended jaw option installed)

Extended Jaw Option Part Number	Mounts to G110 Series Part Number	Finger Compatible with SMC Part Number	Application Notes (Ref: 6 Bar, 20mm finger length, ext. grip)
G110-FNGR-08M-05	G110-08M-05-N-B	MHZ2-10	G110 has 1mm extra stroke, 9N extra total force
G110-FNGR-08M-10	G110-08M-10-N-B	MHZL2-10	G110 has 2mm extra stroke, 10N extra total force
G110-FNGR-11M-05	G110-11M-05-N-B	MHZ2-16	G110 has 1mm less stroke, 13N less total force
G110-FNGR-11M-10	G110-11M-10-N-B	MHZL2-16	G110 has 2mm less stroke, 11N less total force
G110-FNGR-18M-12	G110-18M-12-N-B	MHZ2-25	G110 has 2mm less stroke, 24N extra total force
G110-FNGR-18M-24	G110-18M-24-N-B	MHZL2-25	G110 has 2mm extra stroke, 46N extra total force
G110-FNGR-25M-20	G110-25M-20-N-B	MHZ2-32	G110 has 2mm less stroke, 20N less total force

*Verify acceptable stroke and force changes in the table above for your application.

G120 units are shipped with the extended jaw option mounted from factory.

SMC is a registered trademark of SMC Corporation.



A DOVER COMPANY

Workholding

- Widest variety of workholding products
- High durability and reliability
- Flexible solutions for all applications
- Custom products for unique requirements

Automation

- Broad range of engineered automation products
- Complementary products for modular integration
- Unmatched accuracy, reliability and performance
- Unparalleled global sales, service and engineering support

GLOBAL LOCATIONS

NORTH AMERICA

DE-STA-CO Headquarters
 Auburn Hills, Michigan
 Tel: 1.248.836.6700
 Toll Free: 1.888.DESTACO
 Marketing: marketing@destaco.com
 Customer Service: customerservice@destaco.com

Charlevoix, Michigan
 Tel: 1.888.DESTACO
 Customer Service: customerservice@destaco.com

Wheeling, Illinois
 Tel: 1.800.645.5207
 Customer Service: camco@destaco.com

Red Wing, Minnesota (Central Research Laboratories)
 Tel: 651.385.2142
 Customer Service: sales@centres.com

SOUTH AMERICA

Brazil
 Tel: 0800-124070
 Customer Service: samerica@destaco.com

ASIA

Thailand
 Tel: +66-2-326-0812
 Customer Service: info@destaco.com

China
 Tel: +86-21-2411-2600
 Customer Service: china@destaco.com

India
 Tel: +91-80-41123421-426
 Customer Service: india@destaco.com

EUROPE

Germany
 Tel: +49-6171-705-0
 Customer Service: europa@destaco.com

France
 Tel: +33-1-3996-5000
 Customer Service: france@destaco.com

UK
 Tel: +44-1902-797980
 Customer Service: uk@destaco.com

Spain
 Tel: +34-936361680
 Customer Service: spain@destaco.com

Netherlands
 Tel: +31-297285332
 Customer Service: benelux@destaco.com

Robohand

1025 Doris Road
 Auburn Hills, MI 48326 USA
 Tel 1.888.DESTACO
 Fax 1.248.836.6901
 Email grippers@destaco.com
destaco.com



© Copyright, 2014 DE-STA-CO. All rights for layout, photos and text rest with the publisher DE-STA-CO. All photomechanical or other reproductions only with our express permission. All sales are based on our terms and conditions of sale, delivery and payment.

RBH-GSG-C-0414-US