



# Parallel Grippers - DPW DIRECTCONNECT™ Wide Body Series

**NO  
ADAPTER  
PLATES!**



**DIRECTCONNECT™**

- **DIRECTCONNECT™ Connectivity:** DIRECTCONNECT™ Tapped and Dowel mounting on body.
- **Large or Wide Parts:** Wide body design provides secure gripping of large & wide parts.
- **Multiple air port positions:** Tapped air ports on top and front are standard.
- **Manifold Air Porting:** Top air ports can be manifold o-ring sealed.
- **Inductive Sensor Flexibility:** Mount either 3mm or 4mm Inductive sensors with the same bracket (3mm only on DPW-250).
- **Magnetoresistive Sensing:** Full range adjustable Magnetoresistive Sensors. Magnet supplied standard.
- **Long Finger Applications:** Jaw support thru the length of the body allows for long fingers to be attached to jaws.
- **Thru Jaw Mounting:** Offers a wider variety of mounting applications for jaws.
- **Shaft Wiper Option:** Rugged urethane shaft wipers seal the unit against harsh environments. Designed to be used in machine coolant and metal chip environment applications.
- **Multiple Strokes:** All gripper sizes are available in 2 different strokes.
- **Non-synchronous motion:** The unit can be made non-synchronous providing independent jaw motion allowing the gripper to pick or place at a point other than its center.

## Mounting Information:

Grippers can be mounted & operated in any direction

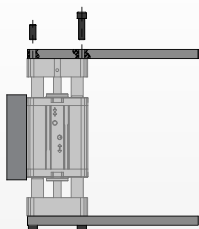

Fingers attach with screws and locate on jaws with dowel pins

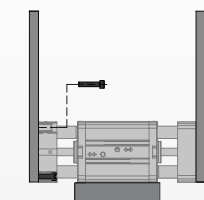

Thru mounting on inside of jaws to allow for alternate finger mounting

Jaw design allows for simplified mounting of fingers

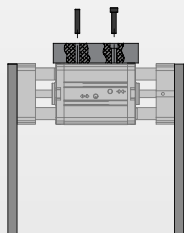

Body mounts on top with screws and locates with slip fit dowel pin holes for accuracy

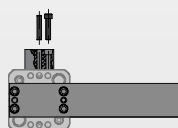

Symmetrical mounting pattern on jaws allows for multiple finger orientation

## Technical Specifications:

### Pneumatic Specifications

Pressure Operating Range  
Cylinder Type  
Dynamic Seals  
Valve Required to Operate

### Air Quality Requirements

Air Filtration  
Air Lubrication  
Air Humidity

### Temperature Operating Range

Buna-N Seals (standard)  
Viton® Seals (optional)

### Maintenance Specifications

Expected Life  
Normal Application  
w/ Preventative Maintenance  
Field Repairable  
Seal Repair Kits Available

### -W Option Shaft Wiper Specifications

Wiper Material  
Temperature Rating (Wiper Only)  
Compatible Chemicals  
Non-Compatible Chemicals  
Example Applications

### Application Restrictions

Applications where mechanism lubricant could cause contamination (use -W Shaft Wiper Option in this case)

\*Addition of lubrication will greatly increase service life

**Imperial**  
40-100 psi

**Metric**  
3-7 bar  
Double Acting  
Internally Lubricated Buna-N  
4-way, 2-position

40 Micron or Better  
Not Necessary\*  
Low Moisture Content (dry)

-30°~180° F  
-20°~300° F

5 million cycles  
10+ million cycles\*  
Yes  
Yes

90 Durometer Urethane  
-65°~275° F -54°~135° C

water, coolant, petroleum oils,  
silicone, lubricants, dilute acids &  
alkalis, hydraulic fluid, transmission fluid  
Ozone, ketones, strong acids,  
brake fluid  
Grinding dust, machine chips &  
coolant, paper dust, washdown

## Product Features

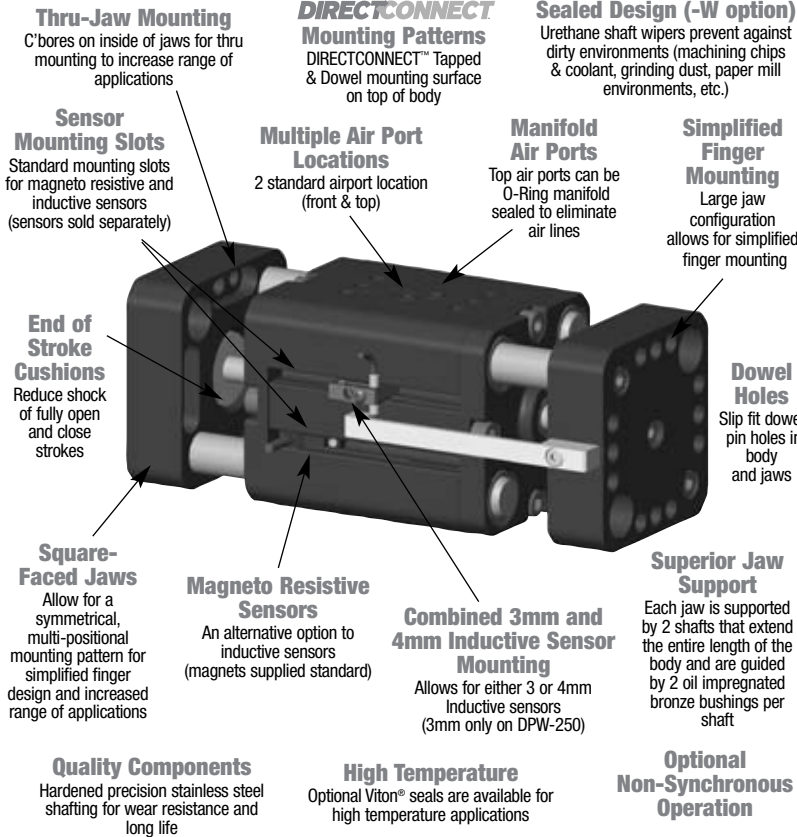

## Operating Principle

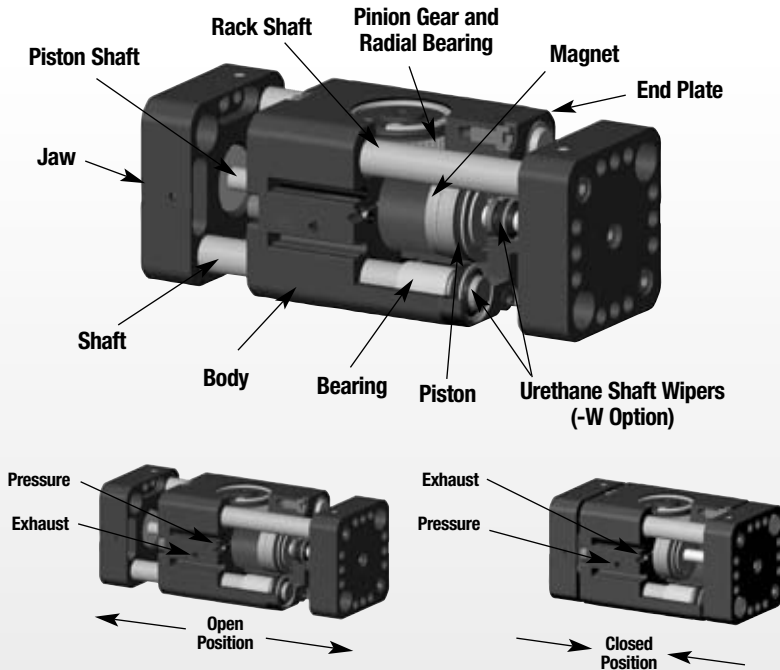

- Two shafts, one with a rack cut into it, are securely fastened to each of the jaws and supported through the length of the body.
- Two double acting opposed pistons provide power to the jaws.
- The rack shafts of each jaw slide in opposite directions of one another and are synchronized by a piston gear.
- This gripper is suitable for internal or external gripping and can be mounted in any orientation.

**U.S Patent #5,163,729 Designed, manufactured and assembled in the USA**

## Style -DPW Parallel Gripper

### Size -250M-1

	250M-1	250M-1
Stroke:	0.75 in.	19.1 mm
Grip Force:	50 lbs.	222 N
Weight:	0.662 lbs.	0.30 Kg



Shown with -W Shaft Wiper Option

See Page **1.198**

## Style -DPW Parallel Gripper

### Size -250M-2

	250M-2	250M-2
Stroke:	1.25 in.	31.8 mm
Grip Force:	50 lbs.	222 N
Weight:	0.856 lbs.	0.39 Kg



Shown with -W Shaft Wiper Option

See Page **1.200**

## Style -DPW Parallel Gripper

### Size -375M-1

	375M-1	375M-1
Stroke:	1.00 in.	25.4 mm
Grip Force:	100 lbs.	445 N
Weight:	1.80 lbs.	0.81 Kg



Shown with -W Shaft Wiper Option

See Page **1.202**

## Style -DPW Parallel Gripper

### Size -375M-2

	375M-2	375M-2
Stroke:	2.00 in.	50.8 mm
Grip Force:	100 lbs.	445 N
Weight:	2.66 lbs.	1.20 Kg



Shown with -W Shaft Wiper Option

See Page **1.204**

## Style -DPW Parallel Gripper

### Size -500M-1

	500M-1	500M-1
Stroke:	1.50 in.	38.1 mm
Grip Force:	180 lbs.	800 N
Weight:	3.27 lbs.	1.48 Kg



Shown with -W Shaft Wiper Option

See Page **1.206**

## Style -DPW Parallel Gripper

### Size -500M-2

	500M-2	500M-2
Stroke:	2.50 in.	63.5 mm
Grip Force:	180 lbs.	800 N
Weight:	4.39 lbs.	2.0 Kg



Shown with -W Shaft Wiper Option

See Page **1.208**



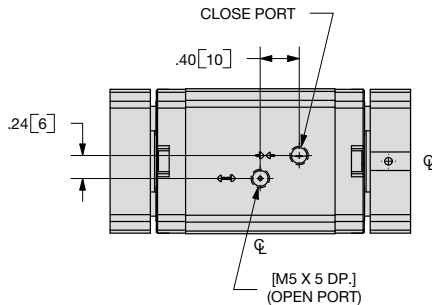
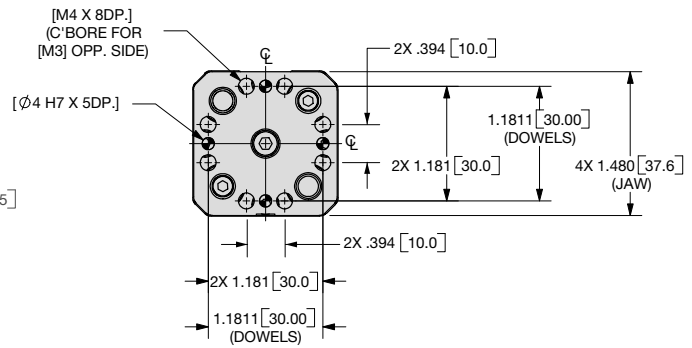
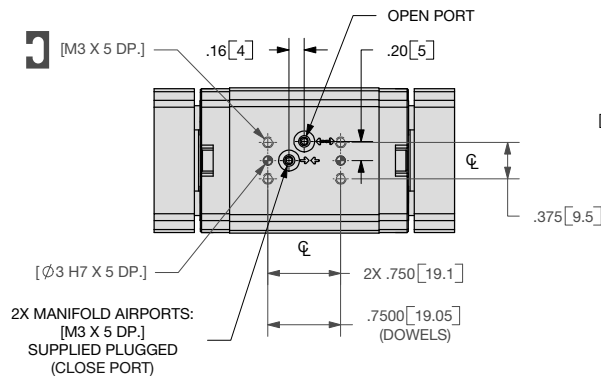
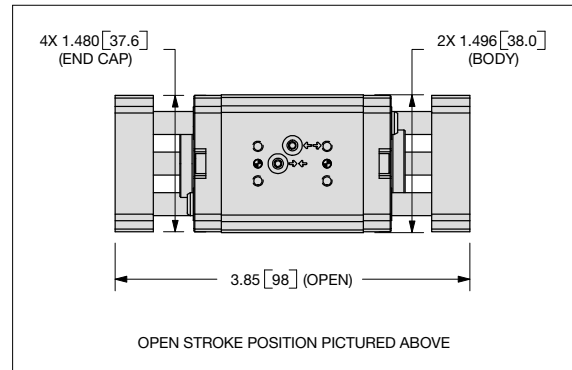
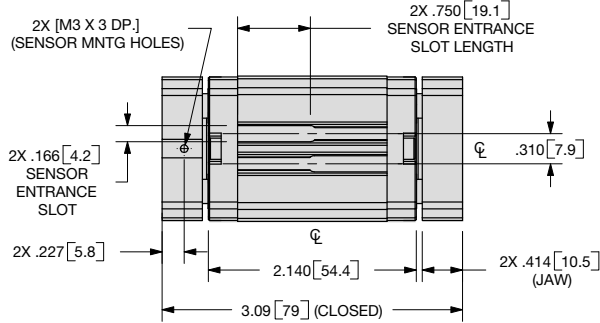

# PARALLEL GRIPPERS DPW-250M-1 DIRECTCONNECT WIDE BODY SERIES

1.198



NOTE: DIRECTCONNECT™ DIMENSIONS ARE SHOWN IN BLUE

UNLESS OTHERWISE NOTED ALL TOLERANCES ARE AS SHOWN BELOW

		
Dimensions are symmetrical about centerline	Third Angle Projection	All Dowel Holes are SF (Slip Fit). Locational Tolerance ±.0005" or (±.013mm)
	Imperial in. 0.00 = ±.01 0.000 = ±.005 0.0000 = ±.0005	Metric [mm] [0.] = (±.25) [0.0] = (±.13) [0.00] = (±.013)
Metric Threads Course Pitch		

## How to Order: (Order Accessories separately from Basic Model)

BASIC MODEL STROKE WIPERS VITON SEALS

DPW-250M - 1 - NS - W - V

NON-SYNCHRONOUS

JAW SYNCHRONIZATION **NS** Non-Synchronous Operation  
Leave Blank for Synchronous (standard)WIPERS **W** Shaft Wipers  
VITON® SEALS **V**

### SENSOR ACCESSORIES

	ORDER #	QTY/UNIT
PNP Magneto Resistive Sensor Short Barrel (with Qk. Disc.)*	<b>OHSP-017</b>	<b>1 or 2</b>
NPN Magneto Resistive Sensor Short Barrel (with Qk. Disc.)*	<b>OHSN-017</b>	<b>1 or 2</b>
PNP Magneto Resistive Sensor 90° Barrel (with Qk. Disc.)*	<b>OHSP-011</b>	<b>1 or 2</b>
NPN Magneto Resistive Sensor 90° Barrel (with Qk. Disc.)*	<b>OHSN-011</b>	<b>1 or 2</b>
Quick Disconnect Cable (2 meters long)*	<b>CABL-010</b>	<b>1 or 2</b>
Quick Disconnect Cable (5 meters long)*	<b>CABL-013</b>	<b>1 or 2</b>
PNP Inductive Sensor 3mm (with Qk. Disc.)*	<b>OISP-019</b>	<b>1 or 2</b>
NPN Inductive Sensor 3mm (with Qk. Disc.)*	<b>OISN-019</b>	<b>1 or 2</b>
Sensor Mounting Kit for 3mm Inductive Sensor	<b>OSMK-116</b>	<b>1</b>

### PNEUMATIC ACCESSORIES

	ORDER #	QTY/UNIT
Seal Repair Kit (Standard Buna-N)	<b>SLKT-337</b>	<b>1</b>
Seal Repair Kit (Viton®)	<b>SLKT-337V</b>	<b>1</b>
Manifold Seal Kit (Viton®)	<b>SLKT-197V</b>	<b>1</b>
Shaft Wiper Seal Kit	<b>SLKT-338</b>	<b>1</b>
Fail Safe Valve M5	<b>OFSV-004</b>	<b>1</b>
Adjustable Flow Control	<b>VLVF-008</b>	<b>1 or 2</b>

\*Sensor and cable sold separately

### SAMPLE ORDER: DPW-250M-1-W-V

Ex: DPW-250M Gripper, 19.1mm Stroke, Shaft Wipers, Viton Seals

Specifications	DPW-250M-1	
Total Rated Grip Force <b>F</b> @ 100 psi, 7 bar .....	50 lbs.	222 N
Stroke .....	0.75 in.	19.1 mm
Pressure Range .....	40-100 psi	3-7 bar
Cylinder Bore Ø .....	0.625 in.	15.9 mm
Displacement .....	0.023 in³	3.8 cm³
Weight .....	0.662 lbs.	0.30 Kg
Temperature Range: Standard Seals .....	-30°~180° F	-35°~80° C
Viton® Seals .....	-20°~300° F	-30°~150° C
Actuation .....	0.12 sec.	0.12 sec.
Accuracy .....	±0.003 in.	±0.08 mm
Repeatability .....	±0.001 in.	±0.03 mm
Valve required to actuate .....	4-way, 2-position	

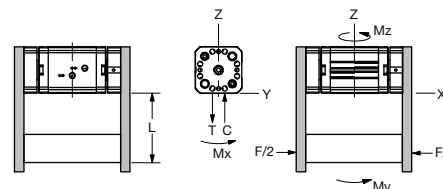
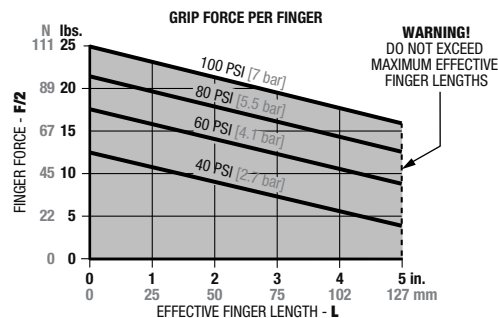

## Loading Capacity†

	Static	Dynamic
Maximum Tensile <b>T</b>	60 lbs. [267 N]	12 lbs. [53 N]
Maximum Compressive <b>C</b>	60 lbs. [267 N]	12 lbs. [53 N]
Maximum Moment <b>M<sub>x</sub></b>	120 in.-lbs. [14 Nm]	24 in.-lbs. [3 Nm]
Maximum Moment <b>M<sub>y</sub></b>	180 in.-lbs. [20 Nm]	36 in.-lbs. [4 Nm]
Maximum Moment <b>M<sub>z</sub></b>	120 in.-lbs. [14 Nm]	24 in.-lbs. [3 Nm]

†Capacities are per set of jaws and are not simultaneous

## Accessory Mounting Technical Data

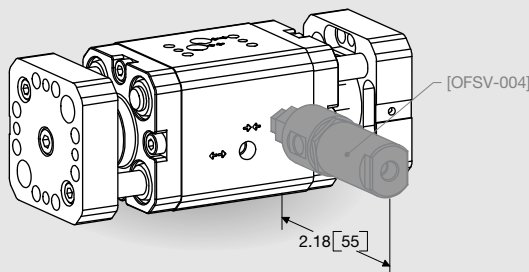

### Failsafe Valves

- Used in applications where it is critical that the part being gripped not be dropped if air pressure is lost
- Mounts directly to gripper
- M5 air port

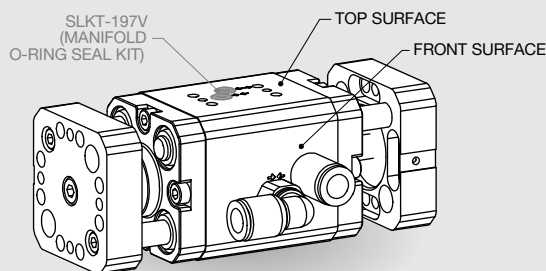

### Multiple Air Port Locations

- 2 standard air port locations (top and front surface)
- Top manifold air ports are supplied plugged
- Seals in manifold kit are Viton®
- Front air ports are tapped for M5 fittings

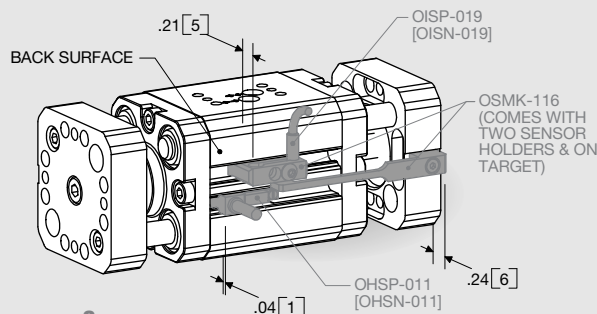

### Sensors

- PNP and NPN Magneto Resistive available
- Sensors are slot mounted, no mounting Kits required
- Low profile underflush sensor version or 90° wire exit sensor version
- Simple adjustment with slotted screw driver
- PNP and NPN inductive available
- Inductive sensor bracket mounts 3mm sensor
- Available with 2M or 5M Quick Disconnect mating cable (order separately)

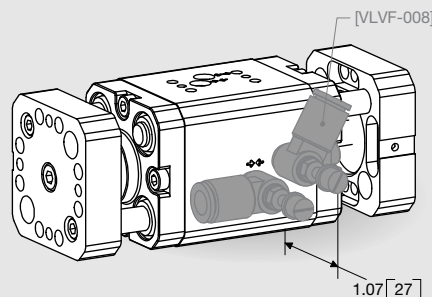

### Flow Controls

- Thumb screw adjust with locking nut for adjusting actuation time
- Available for 6mm OD tubing

# PARALLEL GRIPPERS DPW-250M-2 DIRECTCONNECT WIDE BODY SERIES

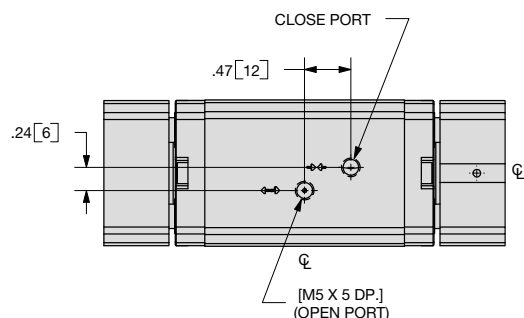
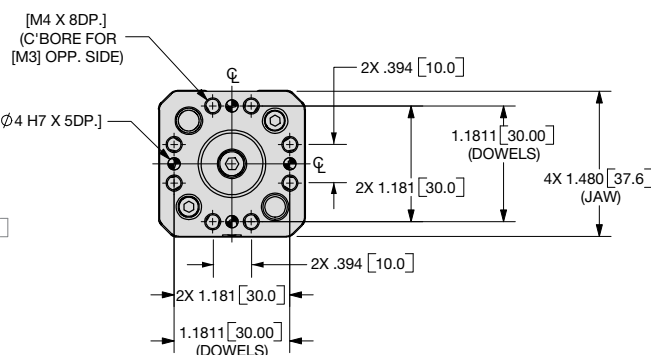
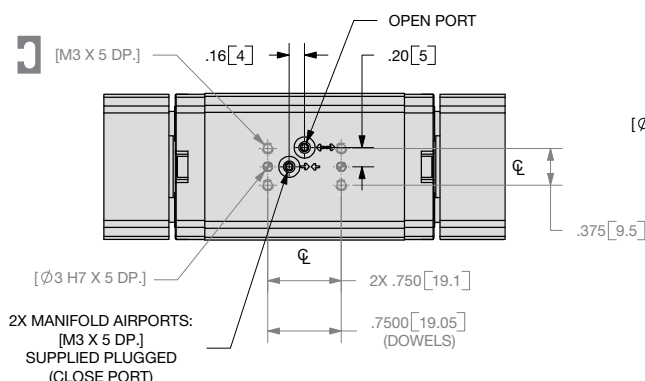
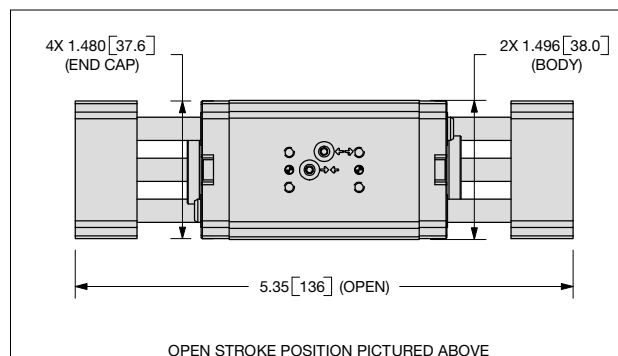
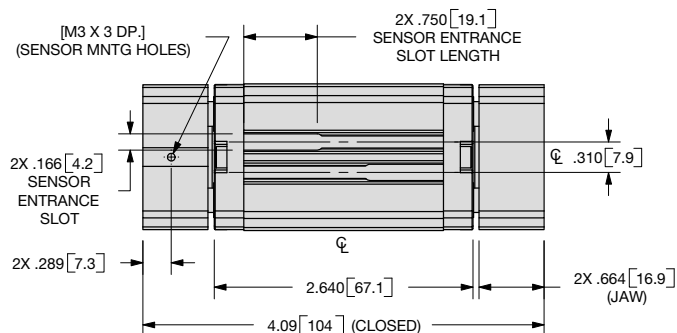

DPW SERIES

1.200

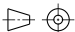

NOTE: DIRECTCONNECT™ DIMENSIONS ARE SHOWN IN BLUE

UNLESS OTHERWISE NOTED ALL TOLERANCES ARE AS SHOWN BELOW

		
Dimensions are symmetrical about centerline	Third Angle Projection	All Dowel Holes are SF (Slip Fit). Locational Tolerance ±.0005" or (±.013mm)
	<b>Imperial in.</b> 0.00 = ±.01 0.000 = ±.005 0.0000 = ±.0005	<b>Metric (mm)</b> [0.] = (±.25) [0.0] = (±.13) [0.00] = (±.013)
Metric Threads Course Pitch		

**How to Order:** (Order Accessories separately from Basic Model)

**BASIC MODEL** **STROKE** **WIPERS** **VITON SEALS**

**DPW-250M - 2 - NS - W - V**

**NON-SYNCHRONOUS**

**JAW SYNCHRONIZATION** **NS** Non-Synchronous Operation  
Leave Blank for Synchronous (standard)

**WIPERS** **W** Shaft Wipers  
**VITON® SEALS** **V**

## SENSOR ACCESSORIES

	ORDER #	QTY/UNIT
PNP Magneto Resistive Sensor Short Barrel (with Qk. Disc.)*	<b>OHSP-017</b>	<b>1 or 2</b>
NPN Magneto Resistive Sensor Short Barrel (with Qk. Disc.)*	<b>OHSN-017</b>	<b>1 or 2</b>
PNP Magneto Resistive Sensor 90° Barrel (with Qk. Disc.)*	<b>OHSP-011</b>	<b>1 or 2</b>
NPN Magneto Resistive Sensor 90° Barrel (with Qk. Disc.)*	<b>OHSN-011</b>	<b>1 or 2</b>
Quick Disconnect Cable (2 meters long)*	<b>CABL-010</b>	<b>1 or 2</b>
Quick Disconnect Cable (5 meters long)*	<b>CABL-013</b>	<b>1 or 2</b>
PNP Inductive Sensor 3mm (with Qk. Disc.)*	<b>OISP-019</b>	<b>1 or 2</b>
NPN Inductive Sensor 3mm (with Qk. Disc.)*	<b>OISN-019</b>	<b>1 or 2</b>
Sensor Mounting Kit for 3mm Inductive Sensor	<b>OSMK-116</b>	<b>1</b>

## PNEUMATIC ACCESSORIES

	ORDER #	QTY/UNIT
Seal Repair Kit (Standard Buna-N)	<b>SLKT-337</b>	<b>1</b>
Seal Repair Kit (Viton®)	<b>SLKT-337V</b>	<b>1</b>
Manifold Seal Kit (Viton®)	<b>SLKT-197V</b>	<b>1</b>
Shaft Wiper Seal Kit	<b>SLKT-338</b>	<b>1</b>
Fail Safe Valve M5	<b>OFSV-004</b>	<b>1</b>
Adjustable Flow Control	<b>VLVF-008</b>	<b>1 or 2</b>

\*Sensor and cable sold separately

**SAMPLE ORDER: DPW-250M-2-W-V**

Ex: DPW-250M Gripper, 31.8mm Stroke, Shaft Wipers, Viton Seals

Please see back cover for DE-STA-CO Global Locations. [www.destaco.com](http://www.destaco.com)

[www.comoso.com](http://www.comoso.com)

DIRECTCONNECT™





# PARALLEL GRIPPERS DPW-250M-2 DIRECT CONNECT WIDE BODY SERIES

DPW SERIES

1.201



Specifications	DPW-250M-2	
Total Rated Grip Force <b>F</b> @ 100 psi, 7 bar .....	50 lbs.	222 N
Stroke .....	1.25 in.	31.8 mm
Pressure Range .....	40-100 psi	3-7 bar
Cylinder Bore Ø .....	0.625 in.	15.9 mm
Displacement .....	0.383 in³	6.3 cm³
Weight .....	0.856 lbs.	0.39 Kg
Temperature Range: Standard Seals .....	-30°~180° F	-35°~80° C
Viton® Seals .....	-20°~300° F	-30°~150° C
Actuation .....	0.14 sec.	0.14 sec.
Accuracy .....	±0.003 in.	±0.08 mm
Repeatability .....	±0.001 in.	±0.03 mm
Valve required to actuate .....	4-way, 2-position	

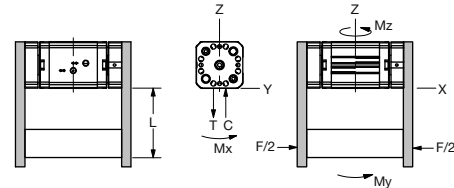
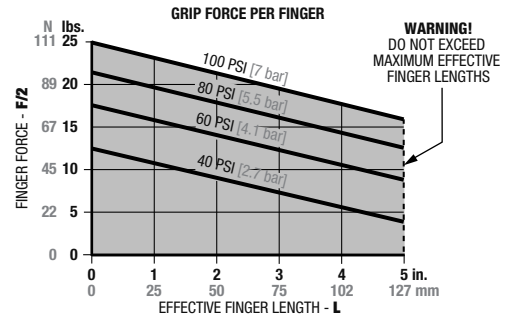

## Loading Capacity†

	Static	Dynamic
Maximum Tensile <b>T</b>	60 lbs. [267 N]	12 lbs. [53 N]
Maximum Compressive <b>C</b>	60 lbs. [267 N]	12 lbs. [53 N]
Maximum Moment <b>M<sub>x</sub></b>	120 in.-lbs. [14 Nm]	24 in.-lbs. [3 Nm]
Maximum Moment <b>M<sub>y</sub></b>	180 in.-lbs. [20 Nm]	36 in.-lbs. [4 Nm]
Maximum Moment <b>M<sub>z</sub></b>	120 in.-lbs. [14 Nm]	24 in.-lbs. [3 Nm]

†Capacities are per set of jaws and are not simultaneous

## Accessory Mounting Technical Data

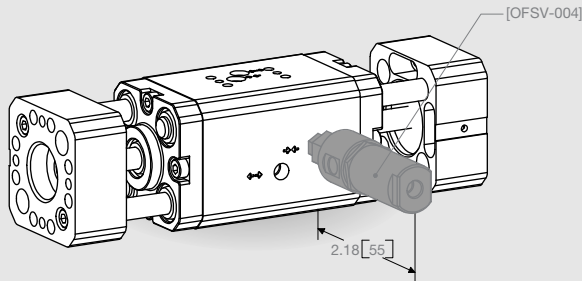

### Failsafe Valves

- Used in applications where it is critical that the part being gripped not be dropped if air pressure is lost
- Mounts directly to gripper
- M5 air port

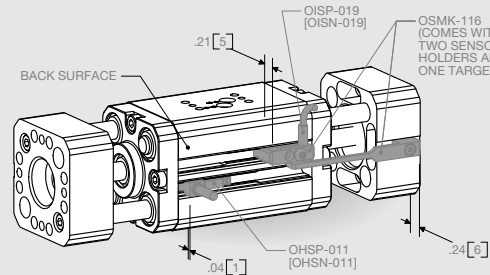

### Sensors

- PNP and NPN Magneto Resistive available
- Sensors are slot mounted, no mounting Kits required
- Low profile underflush sensor version or 90° wire exit sensor version
- Simple adjustment with slotted screw driver
- PNP and NPN inductive available
- Inductive sensor bracket mounts 3mm sensor
- Available with 2M or 5M Quick Disconnect mating cable (order separately)

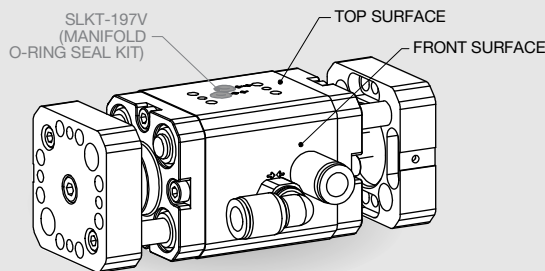

### Multiple Air Port Locations

- 2 standard air port locations (top and front surface)
- Top manifold air ports are supplied plugged
- Seals in manifold kit are Viton®
- Front air ports are tapped for M5 fittings

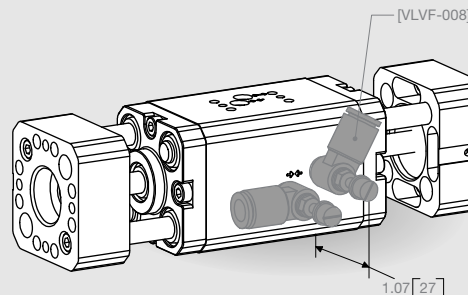

### Flow Controls

- Thumb screw adjust with locking nut for adjusting actuation time
- Available for 6mm OD tubing

# PARALLEL GRIPPERS DPW-375M-1 DIRECTCONNECT WIDE BODY SERIES

DPW SERIES

1.202

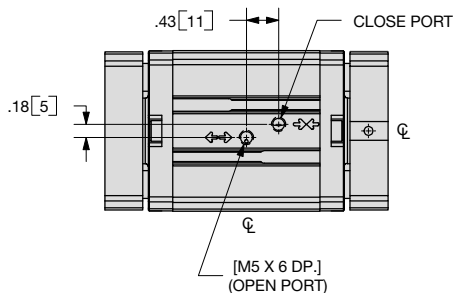
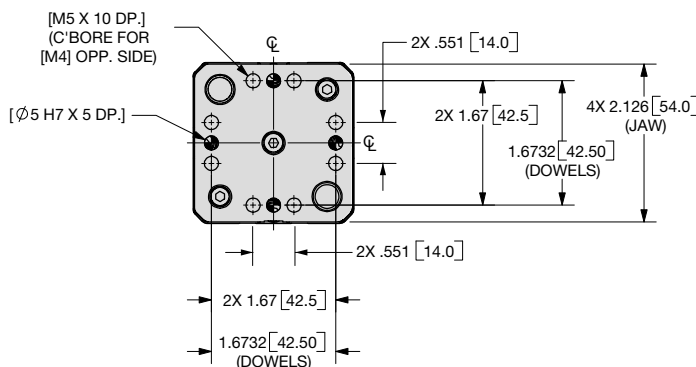
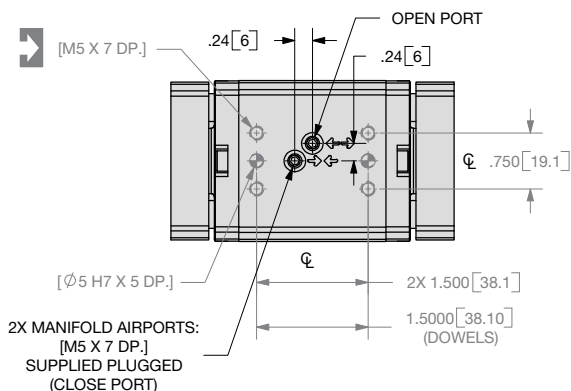
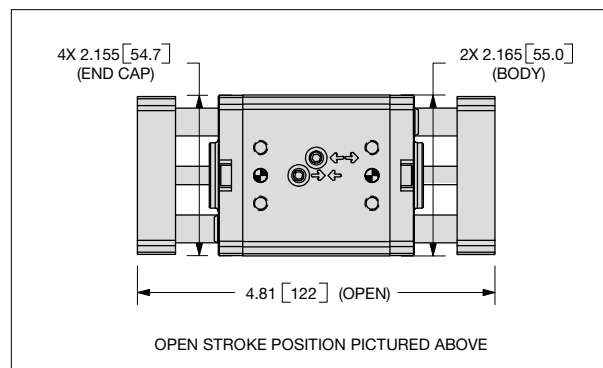
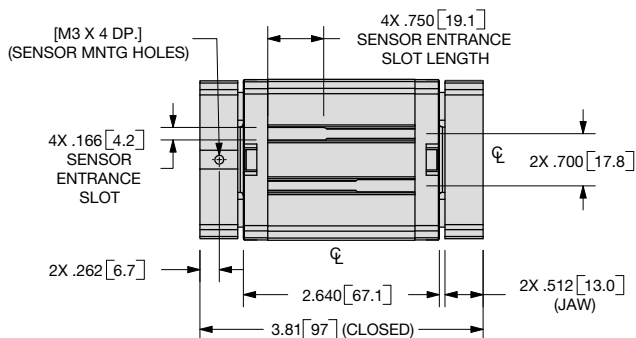

NOTE: DIRECTCONNECT™ DIMENSIONS ARE SHOWN IN BLUE

UNLESS OTHERWISE NOTED ALL  
TOLERANCES ARE AS SHOWN BELOW

	Dimensions are symmetrical about centerline		Third Angle Projection		All Dowel Holes are SF (Slip Fit). Locational Tolerance ±.0005" or (±.013mm)
	Metric Threads Course Pitch		Imperial in. 0.00 = ±.01 0.000 = ±.005 0.0000 = ±.0005		Metric [mm] [0.] = (±.25) [0.0] = (±.13) [0.00] = (±.013)

**How to Order:** (Order Accessories separately from Basic Model)

**BASIC MODEL** **STROKE** **WIPERS** **VITON SEALS**

**DPW-375M - 1 - NS - W - V**

**NON-SYNCHRONOUS**

**JAW SYNCHRONIZATION** **NS** Non-Synchronous Operation  
Leave Blank for Synchronous (standard)  
**WIPERS** **W** Shaft Wipers  
**VITON® SEALS** **V**

## SENSOR ACCESSORIES

	ORDER #	QTY/UNIT
PNP Magneto Resistive Sensor Short Barrel (with Qk. Disc.)*	<b>OHSP-017</b>	<b>1,2,3 or 4</b>
NPN Magneto Resistive Sensor Short Barrel (with Qk. Disc.)*	<b>OHSN-017</b>	<b>1,2,3 or 4</b>
PNP Magneto Resistive Sensor 90° Barrel (with Qk. Disc.)*	<b>OHSP-011</b>	<b>1,2,3 or 4</b>
NPN Magneto Resistive Sensor 90° Barrel (with Qk. Disc.)*	<b>OHSN-011</b>	<b>1,2,3 or 4</b>
Quick Disconnect Cable (2 meters long)*	<b>CABL-010</b>	<b>1,2,3 or 4</b>
Quick Disconnect Cable (5 meters long)*	<b>CABL-013</b>	<b>1,2,3 or 4</b>
PNP Inductive Sensor 3mm (with Qk. Disc.)*	<b>OISP-019</b>	<b>1 or 2</b>
NPN Inductive Sensor 3mm (with Qk. Disc.)*	<b>OISN-019</b>	<b>1 or 2</b>
PNP Inductive Sensor 4mm (with Qk. Disc.)*	<b>OISP-014</b>	<b>1 or 2</b>
NPN Inductive Sensor 4mm (with Qk. Disc.)*	<b>OISN-014</b>	<b>1 or 2</b>
Sensor Mounting Kit for 3mm or 4mm Inductive Sensor	<b>OSMK-117</b>	<b>1</b>

## PNEUMATIC ACCESSORIES

	ORDER #	QTY/UNIT
Seal Repair Kit (Standard Buna-N)	<b>SLKT-339</b>	<b>1</b>
Seal Repair Kit (Viton®)	<b>SLKT-339V</b>	<b>1</b>
Manifold Seal Kit (Viton®)	<b>SLKT-199V</b>	<b>1</b>
Shaft Wiper Seal Kit	<b>SLKT-340</b>	<b>1</b>
Fail Safe Valve M5	<b>OFSV-004</b>	<b>1</b>
Adjustable Flow Control	<b>VLVF-008</b>	<b>1 or 2</b>

\*Sensor and cable sold separately

**SAMPLE ORDER: DPW-375M-1-W-V**

Ex: DPW-375M Gripper, 25.4mm Stroke, Shaft Wipers, Viton Seals

Specifications	DPW-375M-1	
Total Rated Grip Force <b>F</b> @ 100 psi, 7 bar	100 lbs.	445 N
Stroke	1.00 in.	25.4 mm
Pressure Range	40-100 psi	3-7 bar
Cylinder Bore Ø	0.938 in.	23.8 mm
Displacement	0.690 in. <sup>3</sup>	11.3 cm <sup>3</sup>
Weight	1.80 lbs.	0.81 Kg
Temperature Range: Standard Seals	-30°~180° F	-35°~80° C
Viton® Seals	-20°~300° F	-30°~150° C
Actuation	0.16 sec.	0.16 sec.
Accuracy	±0.003 in.	±0.08 mm
Repeatability	±0.001 in.	±0.03 mm
Valve required to actuate	4-way, 2-position	

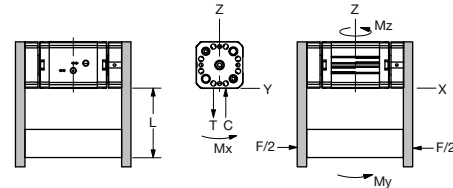
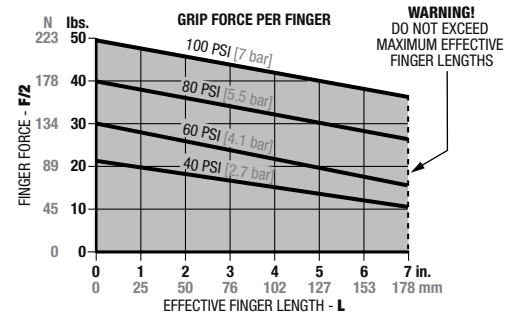

## Loading Capacity†

	Static	Dynamic
Maximum Tensile <b>T</b>	120 lbs. [534 N]	24 lbs. [107 N]
Maximum Compressive <b>C</b>	120 lbs. [534 N]	24 lbs. [107 N]
Maximum Moment <b>M<sub>x</sub></b>	210 in.-lbs. [24 Nm]	42 in.-lbs. [5 Nm]
Maximum Moment <b>M<sub>y</sub></b>	300 in.-lbs. [34 Nm]	60 in.-lbs. [7 Nm]
Maximum Moment <b>M<sub>z</sub></b>	210 in.-lbs. [24 Nm]	42 in.-lbs. [5 Nm]

†Capacities are per set of jaws and are not simultaneous

## Accessory Mounting Technical Data

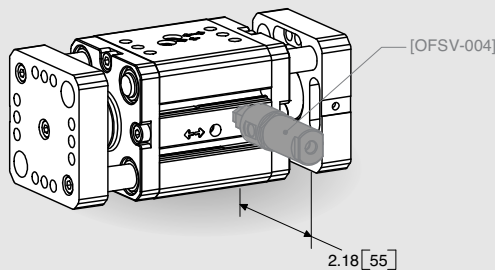

### Failsafe Valves

- Used in applications where it is critical that the part being gripped not be dropped if air pressure is lost
- Mounts directly to gripper
- M5 air port

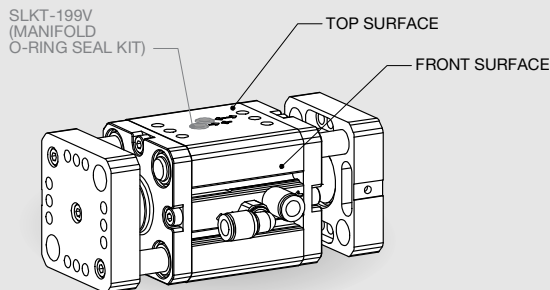

### Multiple Air Port Locations

- 2 standard air port locations (top and front surface)
- Top manifold air ports are supplied plugged
- Seals in manifold kit are Viton®
- Front air ports are tapped for M5 fittings

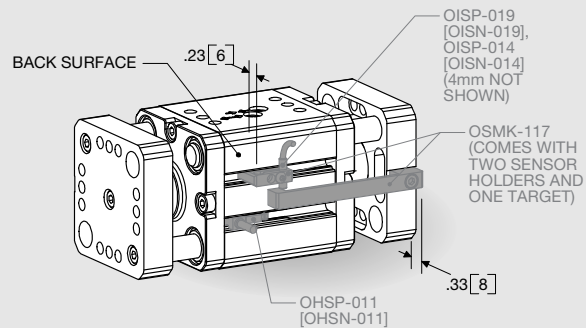

### Sensors

- PNP and NPN Magneto Resistive available
- Sensors are slot mounted, no mounting Kits required
- Low profile underflush sensor version or 90° wire exit sensor version
- Simple adjustment with slotted screw driver
- PNP and NPN inductive available
- Inductive sensor bracket mounts 3mm sensor
- Available with 2M or 5M Quick Disconnect mating cable (order separately)

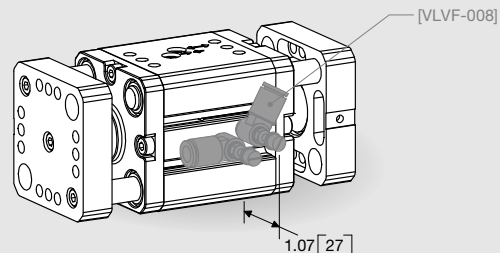

### Flow Controls

- Thumb screw adjust with locking nut for adjusting actuation time
- Available for 6mm OD tubing



# PARALLEL GRIPPERS DPW-375M-2 DIRECTCONNECT WIDE BODY SERIES

DPW SERIES

1.204

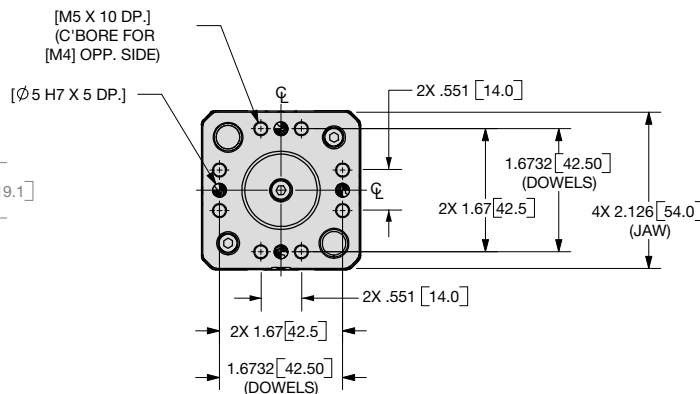
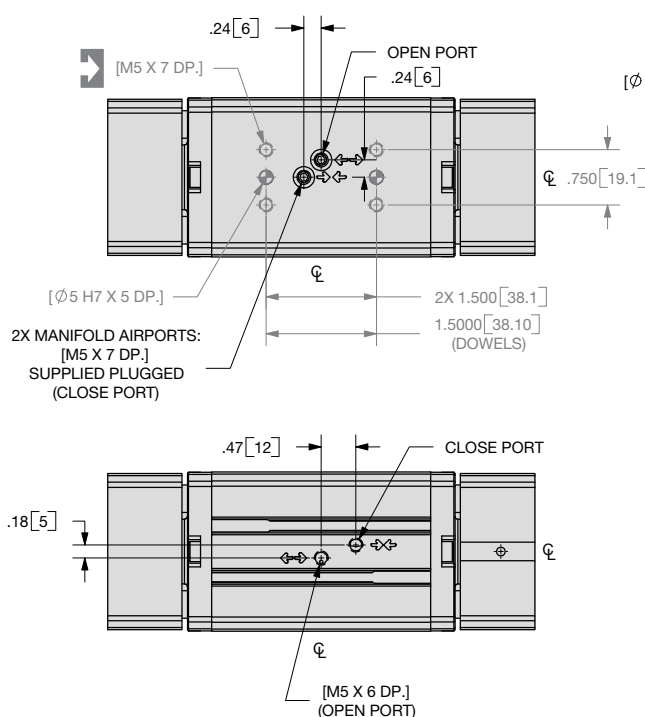
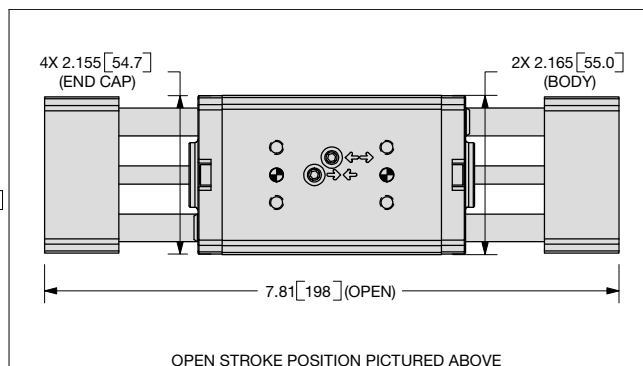
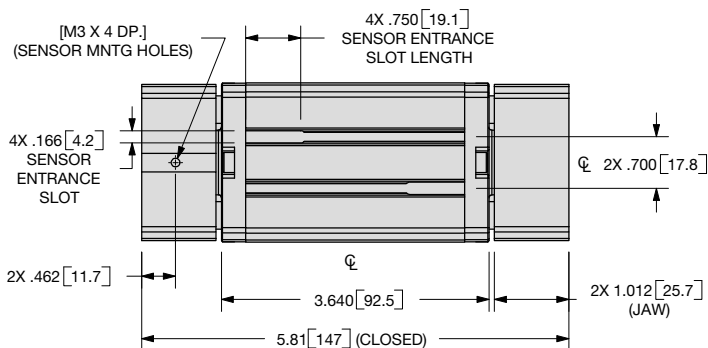

NOTE: DIRECTCONNECT™ DIMENSIONS ARE SHOWN IN BLUE

UNLESS OTHERWISE NOTED ALL TOLERANCES ARE AS SHOWN BELOW

Dimensions are symmetrical about centerline	Third Angle Projection	All Dowel Holes are SF (Slip Fit). Locational Tolerance ±.0005" or (±.013mm)
Metric Threads Course Pitch	<b>Imperial in.</b> 0.00 = ±.01 0.000 = ±.005 0.0000 = ±.0005	<b>Metric (mm)</b> [0.] = (±.25) [0.0] = (±.13) [0.00] = (±.013)

**How to Order:** (Order Accessories separately from Basic Model)

**BASIC MODEL** **STROKE** **WIPERS** **VITON SEALS**  
**DPW-375M - 2 - NS - W - V**  
**NON-SYNCHRONOUS**

**JAW SYNCHRONIZATION** **NS** Non-Synchronous Operation  
Leave Blank for Synchronous (standard)  
**WIPERS** **W** Shaft Wipers  
**VITON® SEALS** **V**

## SENSOR ACCESSORIES

	ORDER #	QTY/UNIT
PNP Magneto Resistive Sensor Short Barrel (with Qk. Disc.)*	<b>OHSP-017</b>	<b>1,2,3 or 4</b>
NPN Magneto Resistive Sensor Short Barrel (with Qk. Disc.)*	<b>OHSN-017</b>	<b>1,2,3 or 4</b>
PNP Magneto Resistive Sensor 90° Barrel (with Qk. Disc.)*	<b>OHSP-011</b>	<b>1,2,3 or 4</b>
NPN Magneto Resistive Sensor 90° Barrel (with Qk. Disc.)*	<b>OHSN-011</b>	<b>1,2,3 or 4</b>
Quick Disconnect Cable (2 meters long)*	<b>CABL-010</b>	<b>1,2,3 or 4</b>
Quick Disconnect Cable (5 meters long)*	<b>CABL-013</b>	<b>1,2,3 or 4</b>
PNP Inductive Sensor 3mm (with Qk. Disc.)*	<b>OISP-019</b>	<b>1 or 2</b>
NPN Inductive Sensor 3mm (with Qk. Disc.)*	<b>OISN-019</b>	<b>1 or 2</b>
PNP Inductive Sensor 4mm (with Qk. Disc.)*	<b>OISP-014</b>	<b>1 or 2</b>
NPN Inductive Sensor 4mm (with Qk. Disc.)*	<b>OISN-014</b>	<b>1 or 2</b>
Sensor Mounting Kit for 3mm or 4mm Inductive Sensor	<b>OSMK-117</b>	<b>1</b>

## PNEUMATIC ACCESSORIES

	ORDER #	QTY/UNIT
Seal Repair Kit (Standard Buna-N)	<b>SLKT-339</b>	<b>1</b>
Seal Repair Kit (Viton®)	<b>SLKT-339V</b>	<b>1</b>
Manifold Seal Kit (Viton®)	<b>SLKT-199V</b>	<b>1</b>
Shaft Wiper Seal Kit	<b>SLKT-340</b>	<b>1</b>
Fail Safe Valve M5	<b>OFSV-004</b>	<b>1</b>
Adjustable Flow Control	<b>VLVF-008</b>	<b>1 or 2</b>

\*Sensor and cable sold separately

**SAMPLE ORDER: DPW-375M-2-W-V**

Ex: DPW-375 M Gripper, 50.8mm Stroke, Shaft Wipers, Viton Seals



# PARALLEL GRIPPERS DPW-375M-2 DIRECT CONNECT WIDE BODY SERIES

DPW SERIES

1.205

Specifications	DPW-375M-2	
Total Rated Grip Force <b>F</b> @ 100 psi, 7 bar	100 lbs.	445 N
Stroke	2.00 in.	50.8mm
Pressure Range	40-100 psi	3-7 bar
Cylinder Bore Ø	0.938 in.	23.8 mm
Displacement	1.382 in³	22.6 cm³
Weight	2.66 lbs.	1.20 Kg
Temperature Range: Standard Seals	-30°~180° F	-35°~80° C
Viton® Seals	-20°~300° F	-30°~150° C
Actuation	0.20 sec.	0.20 sec.
Accuracy	±0.003 in.	±0.08 mm
Repeatability	±0.001 in.	±0.03 mm
Valve required to actuate	4-way, 2-position	

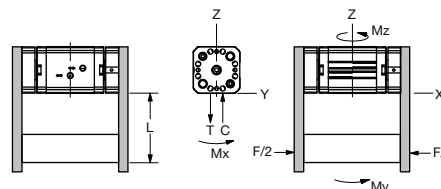
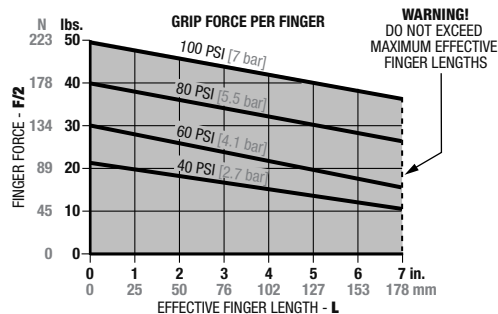

## Loading Capacity†

	Static	Dynamic
Maximum Tensile <b>T</b>	120 lbs. [534 N]	24 lbs. [107 N]
Maximum Compressive <b>C</b>	120 lbs. [534 N]	24 lbs. [107 N]
Maximum Moment <b>M<sub>x</sub></b>	210 in.-lbs. [24 Nm]	42 in.-lbs. [5 Nm]
Maximum Moment <b>M<sub>y</sub></b>	300 in.-lbs. [34 Nm]	60 in.-lbs. [7 Nm]
Maximum Moment <b>M<sub>z</sub></b>	210 in.-lbs. [24 Nm]	42 in.-lbs. [5 Nm]

†Capacities are per set of jaws and are not simultaneous

## Accessory Mounting Technical Data

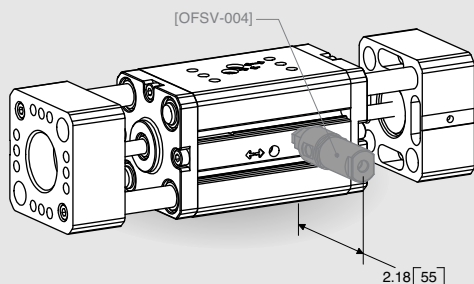

### Failsafe Valves

- Used in applications where it is critical that the part being gripped not be dropped if air pressure is lost
- Mounts directly to gripper
- M5 air port

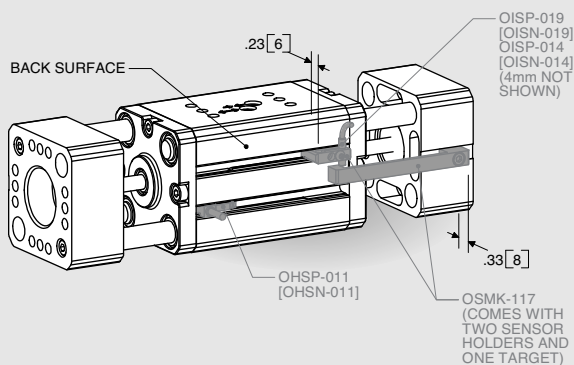

### Sensors

- PNP and NPN Magneto Resistive available
- Sensors are slot mounted, no mounting Kits required
- Low profile underflush sensor version or 90° wire exit sensor version
- Simple adjustment with slotted screw driver
- PNP and NPN inductive available
- Inductive sensor bracket mounts 3mm sensor
- Available with 2M or 5M Quick Disconnect mating cable (order separately)

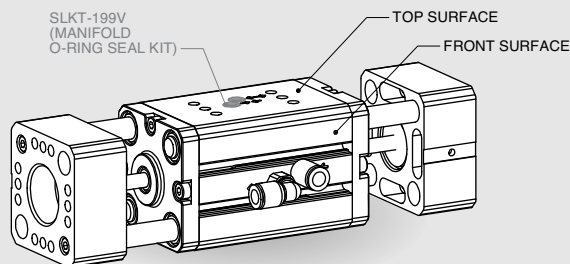

### Multiple Air Port Locations

- 2 standard air port locations (top and front surface)
- Top manifold air ports are supplied plugged
- Seals in manifold kit are Viton®
- Front air ports are tapped for M5 fittings

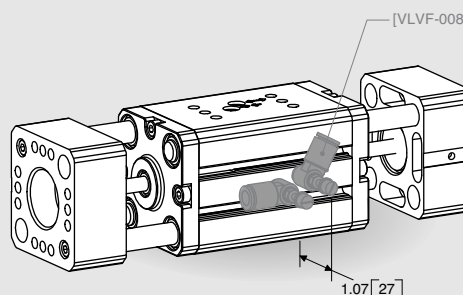

### Flow Controls



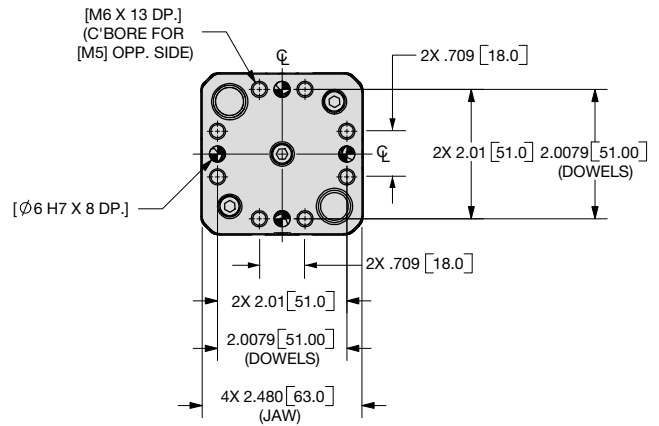
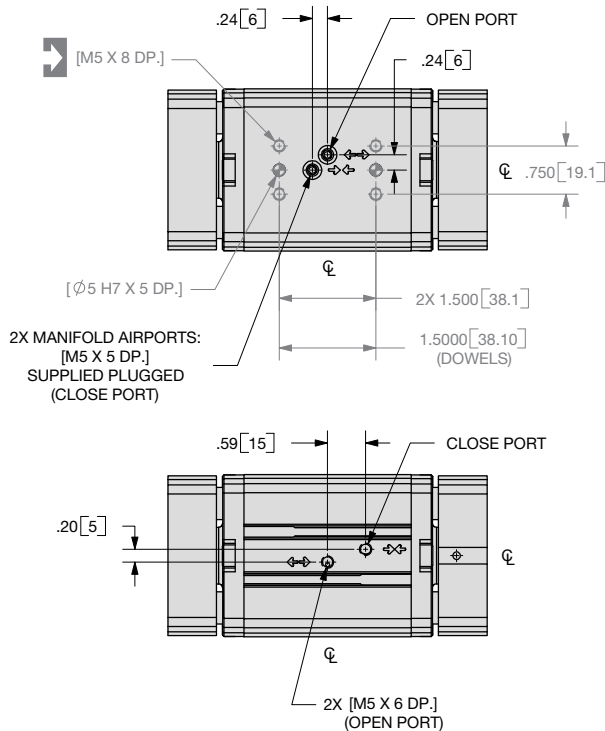
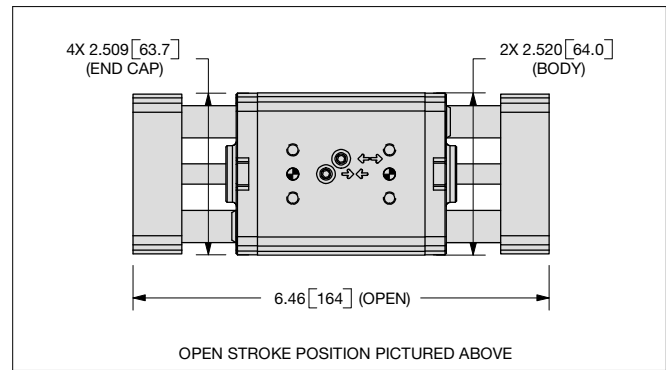
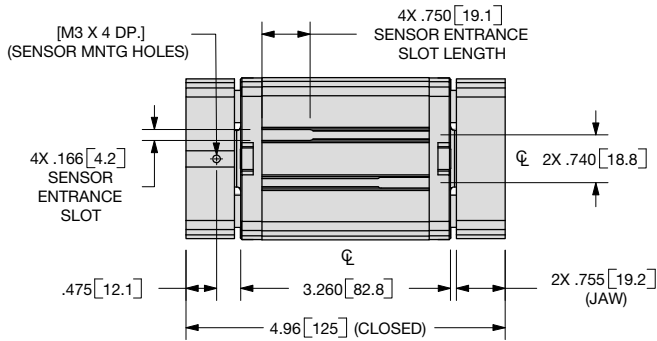

- Thumb screw adjust with locking nut for adjusting actuation time
- Available for 6mm OD tubing

# PARALLEL GRIPPERS DPW-500M-1 DIRECTCONNECT WIDE BODY SERIES



NOTE: DIRECTCONNECT™ DIMENSIONS ARE SHOWN IN BLUE

UNLESS OTHERWISE NOTED ALL  
TOLERANCES ARE AS SHOWN BELOW

		
Dimensions are symmetrical about centerline	Third Angle Projection	All Dowel Holes are SF (Slip Fit). Locational Tolerance ±.0005" or (±.013mm)
	<b>Imperial in.</b> 0.00 = ±.01 0.000 = ±.005 0.0000 = ±.0005	<b>Metric (mm)</b> [0.] = (±.25) [0.0] = (±.13) [0.00] = (±.013)
Metric Threads Course Pitch		

**How to Order:** (Order Accessories separately from Basic Model)

**BASIC MODEL STROKE WIPERS VITON SEALS**

**DPW-500M - 1 - NS - W - V**

**NON-SYNCHRONOUS**

**JAW SYNCHRONIZATION** **NS** Non-Synchronous Operation  
Leave Blank for Synchronous (standard)

**WIPERS** **W** Shaft Wipers  
**VITON® SEALS** **V**

## SENSOR ACCESSORIES

	ORDER #	QTY/UNIT
PNP Magneto Resistive Sensor Short Barrel (with Qk. Disc.)*	<b>OHSP-017</b>	<b>1,2,3 or 4</b>
NPN Magneto Resistive Sensor Short Barrel (with Qk. Disc.)*	<b>OHSN-017</b>	<b>1,2,3 or 4</b>
PNP Magneto Resistive Sensor 90° Barrel (with Qk. Disc.)*	<b>OHSP-011</b>	<b>1,2,3 or 4</b>
NPN Magneto Resistive Sensor 90° Barrel (with Qk. Disc.)*	<b>OHSN-011</b>	<b>1,2,3 or 4</b>
Quick Disconnect Cable (2 meters long)*	<b>CABL-010</b>	<b>1,2,3 or 4</b>
Quick Disconnect Cable (5 meters long)*	<b>CABL-013</b>	<b>1,2,3 or 4</b>
PNP Inductive Sensor 3mm (with Qk. Disc.)*	<b>OISP-019</b>	<b>1 or 2</b>
NPN Inductive Sensor 3mm (with Qk. Disc.)*	<b>OISN-019</b>	<b>1 or 2</b>
PNP Inductive Sensor 4mm (with Qk. Disc.)*	<b>OISP-014</b>	<b>1 or 2</b>
NPN Inductive Sensor 4mm (with Qk. Disc.)*	<b>OISN-014</b>	<b>1 or 2</b>
Sensor Mounting Kit for 3mm or 4mm Inductive Sensor	<b>OSMK-118</b>	<b>1</b>

## PNEUMATIC ACCESSORIES

	ORDER #	QTY/UNIT
Seal Repair Kit (Standard Buna-N)	<b>SLKT-341</b>	<b>1</b>
Seal Repair Kit (Viton®)	<b>SLKT-341V</b>	<b>1</b>
Manifold Seal Kit (Viton®)	<b>SLKT-199V</b>	<b>1</b>
Shaft Wiper Seal Kit	<b>SLKT-342</b>	<b>1</b>
Fail Safe Valve M5	<b>OFSV-004</b>	<b>1</b>
Adjustable Flow Control	<b>VLVF-008</b>	<b>1 or 2</b>

\*Sensor and cable sold separately

**SAMPLE ORDER: DPW-500M-1-W-V**

Ex: DPW-500M Gripper, 38.1mm Stroke, Shaft Wipers, Viton Seals

## Specifications

## DPW-500M-1

Total Rated Grip Force <b>F</b> @ 100 psi, 7 bar .....	180 lbs.	800 N
Stroke .....	1.50 in.	38.1 mm
Pressure Range .....	40-100 psi	3-7 bar
Cylinder Bore Ø .....	1.250 in.	31.8 mm
Displacement .....	1.841 in. <sup>3</sup>	30.2 cm <sup>3</sup>
Weight .....	3.27 lbs.	1.48 Kg
Temperature Range: Standard Seals .....	-30°~180° F	-35°~80° C
Viton® Seals .....	-20°~300° F	-30°~150° C
Actuation .....	0.20 sec.	0.20 sec.
Accuracy .....	±0.003 in.	±0.08 mm
Repeatability .....	±0.001 in.	±0.03 mm
Valve required to actuate .....	4-way, 2-position	

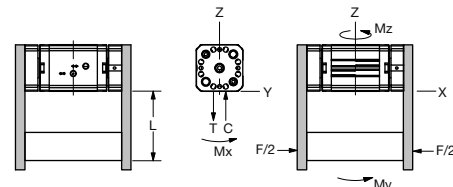
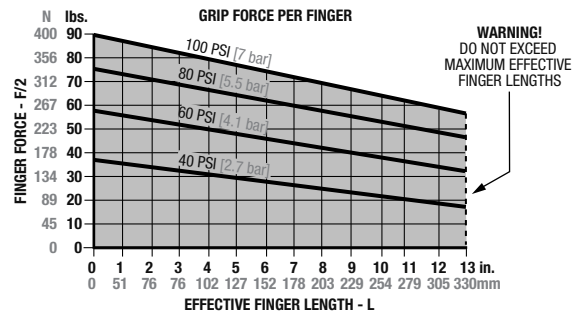

## Loading Capacity†

	Static	Dynamic
Maximum Tensile <b>T</b>	600 lbs. [2668 N]	60 lbs. [267 N]
Maximum Compressive <b>C</b>	600 lbs. [2668 N]	60 lbs. [267 N]
Maximum Moment <b>M<sub>x</sub></b>	600 in.-lbs. [68 Nm]	60 in.-lbs. [7 Nm]
Maximum Moment <b>M<sub>y</sub></b>	900 in.-lbs. [102 Nm]	90 in.-lbs. [10 Nm]
Maximum Moment <b>M<sub>z</sub></b>	600 in.-lbs. [68 Nm]	60 in.-lbs. [7 Nm]

†Capacities are per set of jaws and are not simultaneous

## Accessory Mounting Technical Data

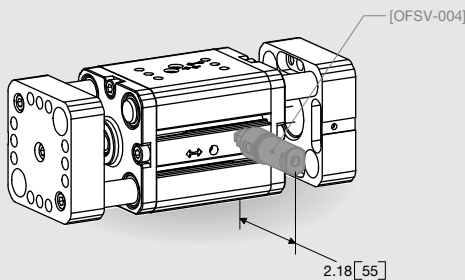

### Failsafe Valves

- Used in applications where it is critical that the part being gripped not be dropped if air pressure is lost
- Mounts directly to gripper
- M5 air port

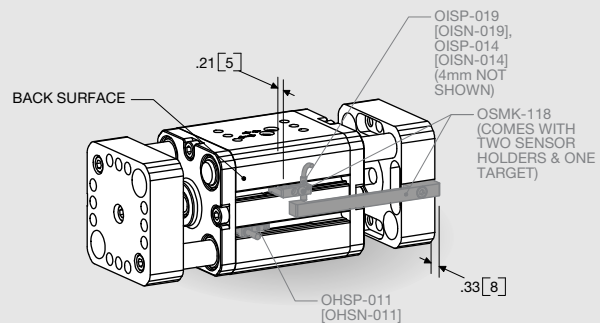

### Sensors

- PNP and NPN Magneto Resistive available
- Sensors are slot mounted, no mounting Kits required
- Low profile underflush sensor version or 90° wire exit sensor version
- Simple adjustment with slotted screw driver
- PNP and NPN inductive available
- Inductive sensor bracket mounts 3mm sensor
- Available with 2M or 5M Quick Disconnect mating cable (order separately)

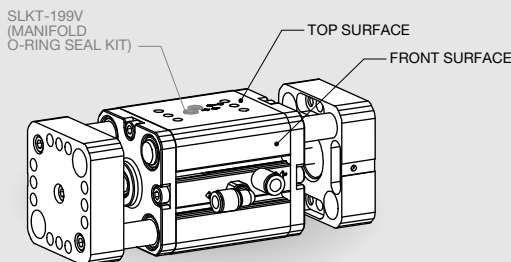

### Multiple Air Port Locations

- 2 standard air port locations (top and front surface)
- Top manifold air ports are supplied plugged
- Seals in manifold kit are Viton®
- Front air ports are tapped for M5 fittings

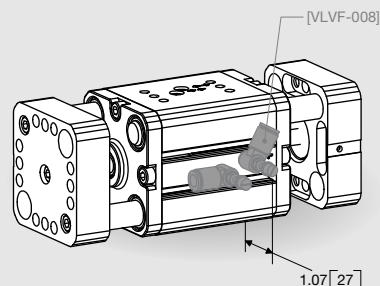

### Flow Controls

- Thumb screw adjust with locking nut for adjusting actuation time
- Available for 6mm OD tubing

# PARALLEL GRIPPERS DPW-500M-2 DIRECTCONNECT WIDE BODY SERIES

DPW SERIES

1.208

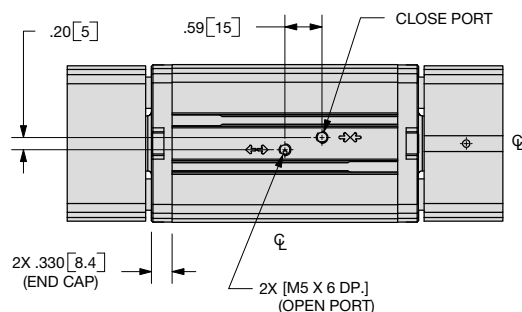
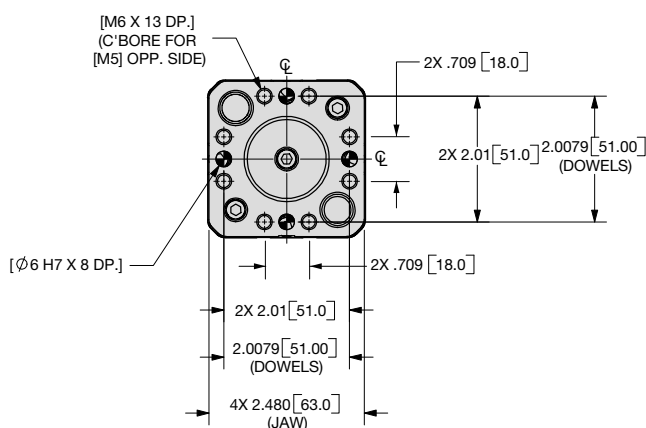
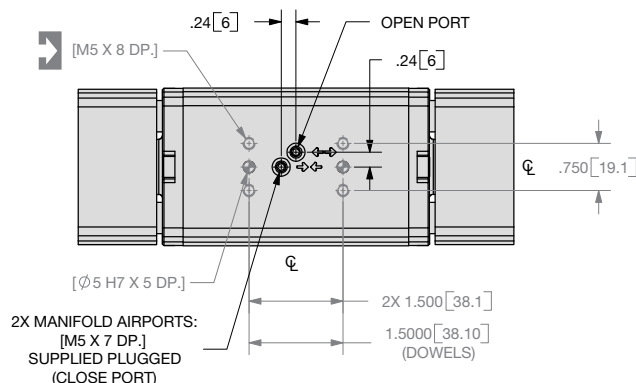
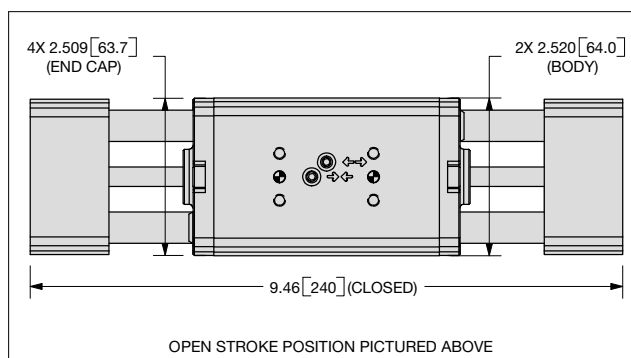
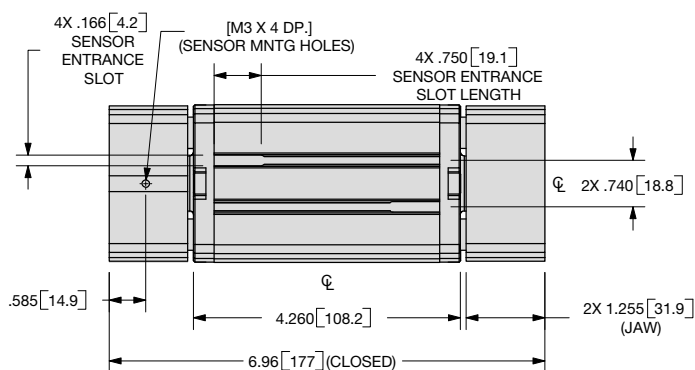

NOTE: DIRECTCONNECT™ DIMENSIONS ARE SHOWN IN BLUE

UNLESS OTHERWISE NOTED ALL TOLERANCES ARE AS SHOWN BELOW

Dimensions are symmetrical about centerline	Third Angle Projection	All Dowel Holes are SF (Slip Fit). Locational Tolerance ±.0005" or (±.013mm)
Metric Threads Course Pitch	<b>Imperial in.</b> 0.00 = ±.01 0.000 = ±.005 0.0000 = ±.0005	<b>Metric (mm)</b> [0.] = (±.25) [0.0] = (±.13) [0.00] = (±.013)

## How to Order: (Order Accessories separately from Basic Model)

BASIC MODEL STROKE WIPERS VITON SEALS

**DPW-500M - 2 - NS - W - V**

NON-ASYNC

**JAW SYNCHRONIZATION** **NS** Non-Synchronous Operation  
Leave Blank for Synchronous (standard)  
**WIPERS** **W** Shaft Wipers  
**VITON® SEALS** **V**

### SENSOR ACCESSORIES

	ORDER #	QTY/UNIT
PNP Magneto Resistive Sensor Short Barrel (with Qk. Disc.)*	<b>OHSP-017</b>	<b>1,2,3 or 4</b>
NPN Magneto Resistive Sensor Short Barrel (with Qk. Disc.)*	<b>OHSN-017</b>	<b>1,2,3 or 4</b>
PNP Magneto Resistive Sensor 90° Barrel (with Qk. Disc.)*	<b>OHSP-011</b>	<b>1,2,3 or 4</b>
NPN Magneto Resistive Sensor 90° Barrel (with Qk. Disc.)*	<b>OHSN-011</b>	<b>1,2,3 or 4</b>
Quick Disconnect Cable (2 meters long)*	<b>CABL-010</b>	<b>1,2,3 or 4</b>
Quick Disconnect Cable (5 meters long)*	<b>CABL-013</b>	<b>1,2,3 or 4</b>
PNP Inductive Sensor 3mm (with Qk. Disc.)*	<b>OISP-019</b>	<b>1 or 2</b>
NPN Inductive Sensor 3mm (with Qk. Disc.)*	<b>OISN-019</b>	<b>1 or 2</b>
PNP Inductive Sensor 4mm (with Qk. Disc.)*	<b>OISP-014</b>	<b>1 or 2</b>
NPN Inductive Sensor 4mm (with Qk. Disc.)*	<b>OISN-014</b>	<b>1 or 2</b>
Sensor Mounting Kit for 3mm or 4mm Inductive Sensor	<b>OSMK-118</b>	<b>1</b>

### PNEUMATIC ACCESSORIES

	ORDER #	QTY/UNIT
Seal Repair Kit (Standard Buna-N)	<b>SLKT-341</b>	<b>1</b>
Seal Repair Kit (Viton®)	<b>SLKT-341V</b>	<b>1</b>
Manifold Seal Kit (Viton®)	<b>SLKT-199V</b>	<b>1</b>
Shaft Wiper Seal Kit	<b>SLKT-342</b>	<b>1</b>
Fail Safe Valve M5	<b>OFSV-004</b>	<b>1</b>
Adjustable Flow Control	<b>VLVF-008</b>	<b>1 or 2</b>

\*Sensor and cable sold separately

### SAMPLE ORDER: DPW-500M-2-W-V

Ex: DPW-500M Gripper, 63.5mm Stroke, Shaft Wipers, Viton Seals



Specifications	DPW-500M-2	
Total Rated Grip Force <b>F</b> @ 100 psi, 7 bar .....	180 lbs.	800 N
Stroke.....	2.50 in.	63.5 mm
Pressure Range.....	40-100 psi	3-7 bar
Cylinder Bore Ø.....	1.250 in.	31.8 mm
Displacement.....	3.068 in³	50.3 cm³
Weight.....	4.39 lbs.	2.0 Kg
Temperature Range: Standard Seals .....	-30°~180° F	-35°~80° C
Viton® Seals .....	-20°~300° F	-30°~150° C
Actuation .....	0.28 sec.	0.28 sec.
Accuracy.....	±0.003 in.	±0.08 mm
Repeatability.....	±0.001 in.	±0.03 mm
Valve required to actuate .....	4-way, 2-position	

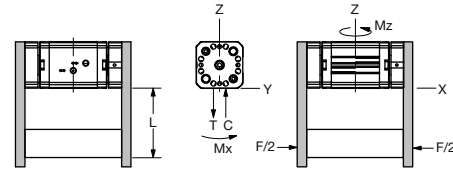
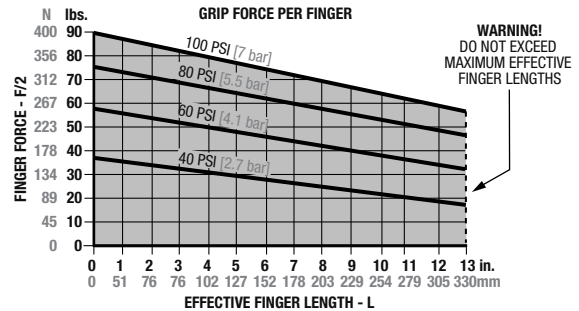

## Loading Capacity†

	Static	Dynamic
Maximum Tensile <b>T</b>	600 lbs. [2668 N]	60 lbs. [267 N]
Maximum Compressive <b>C</b>	600 lbs. [2668 N]	60 lbs. [267 N]
Maximum Moment <b>M<sub>x</sub></b>	600 in.-lbs. [68 Nm]	60 in.-lbs. [7 Nm]
Maximum Moment <b>M<sub>y</sub></b>	900 in.-lbs. [102 Nm]	90 in.-lbs. [10 Nm]
Maximum Moment <b>M<sub>z</sub></b>	600 in.-lbs. [68 Nm]	60 in.-lbs. [7 Nm]

†Capacities are per set of jaws and are not simultaneous

## Accessory Mounting Technical Data

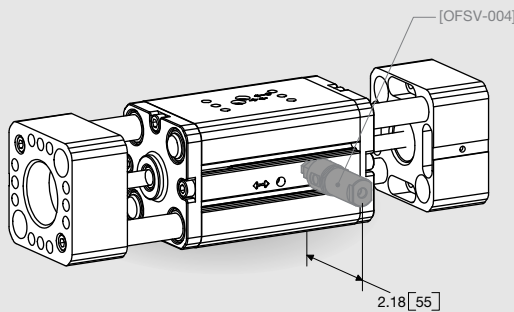

### Failsafe Valves

- Used in applications where it is critical that the part being gripped not be dropped if air pressure is lost
- Mounts directly to gripper
- M5 air port

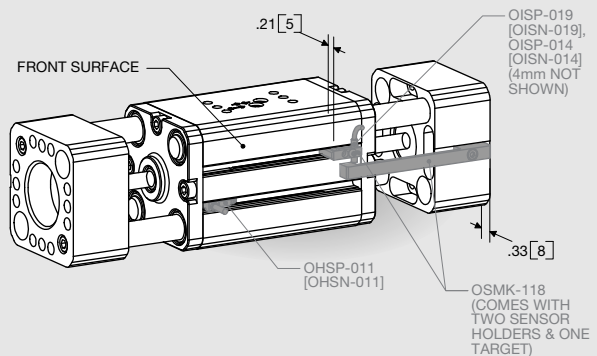

### Sensors

- PNP and NPN Magneto Resistive available
- Sensors are slot mounted, no mounting Kits required
- Low profile underflush sensor version or 90° wire exit sensor version
- Simple adjustment with slotted screw driver
- PNP and NPN inductive available
- Inductive sensor bracket mounts 3mm sensor
- Available with 2M or 5M Quick Disconnect mating cable (order separately)

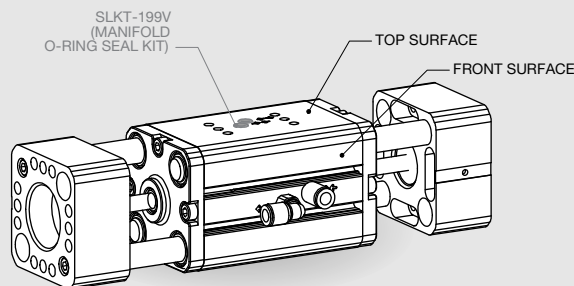

### Multiple Air Port Locations

- 2 standard air port locations (top and front surface)
- Top manifold air ports are supplied plugged
- Seals in manifold kit are Viton®
- Front air ports are tapped for M5 fittings

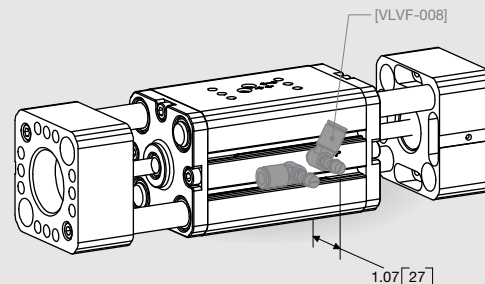

### Flow Controls

- Thumb screw adjust with locking nut for adjusting actuation time
- Available for 6mm OD tubing

# DPW SERIES EXPLODED VIEW

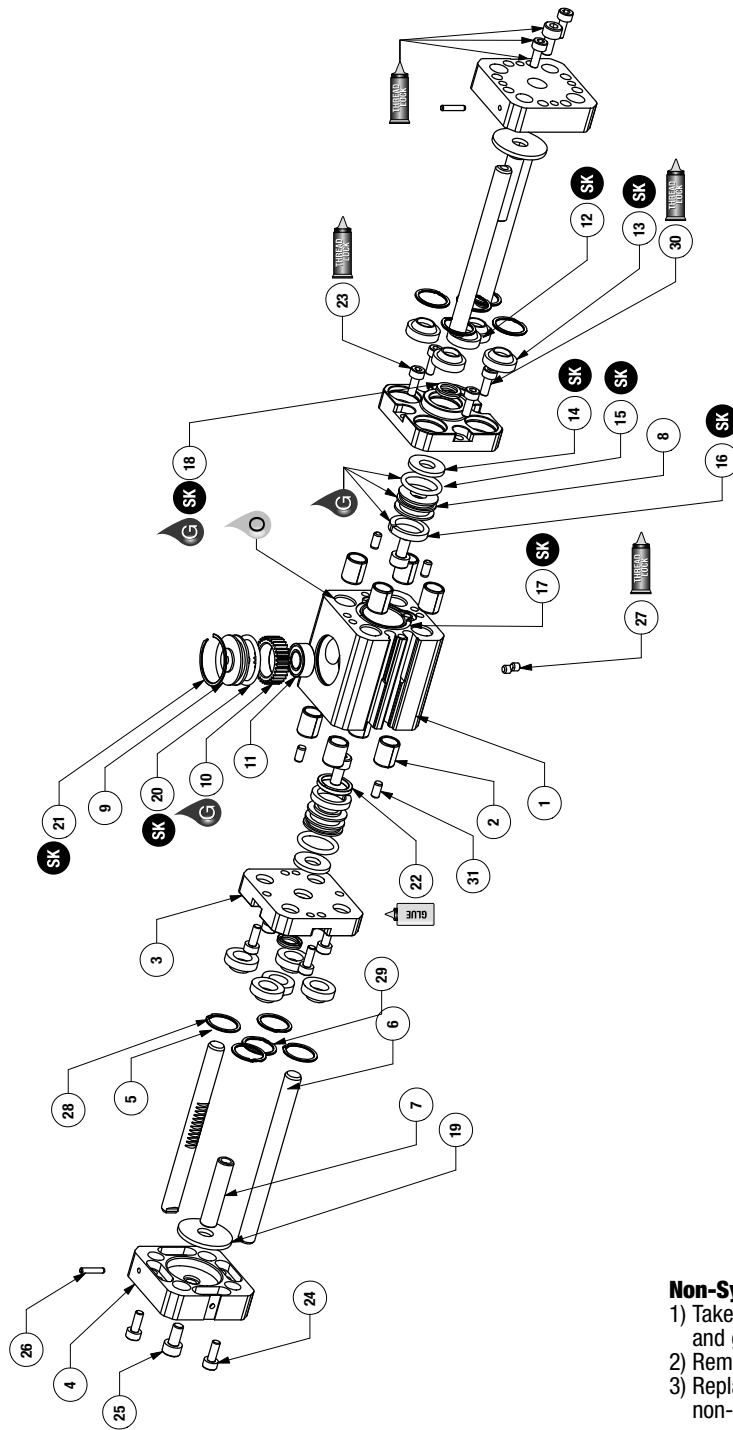

## Assembly Procedure:

- 1) Lubricate and install seals on piston.
- 2) Install pistons and shafts.
- 3) Mount end caps to enclose piston assembly.
- 4) Install tooling plates and shafts.
- 5) Place bearing, shaft, and gear into body and install cap and retaining ring for sync version.
- a) For disassembly, use magnet to pull gear out of body.
- b) Install 2 gear shafts with teeth facing syncing gear. Use dowel to align gear shafts in correct position.

Item	Qty	Name
01	1	Body
02	8	Bushing, Oil Impregnated Bronze
03	2	End Cap
04	2	Jaw
05*	2	Guide Shaft, Rack
06*	2	Guide Shaft (Qty 4 for -NS)
07	2	Piston Rod
08	2	Piston
09	1	Cap, Gear
10*	1	Gear
11*	1	Bearing, Radial
12*	2	Piston Rod Wiper (Shaft Wiper "-W" option only)
13*	8	Shaft Wiper (Shaft Wiper "-W" option only)
14	2	Piston Bumper
15	2	Piston O-ring
16	2	Teflon Ring
17*	2	Body O-ring
18	2	U-cup
19	2	Jaw Bumper
20	1	Gear Cap O-ring
21	1	Retaining Ring
22	1	Magnet
23	8	End Cap Mntg Screw
24	4	Guide Shaft Mntg Screw
25	4	Piston Shaft Mntg Screw
26*	2	Guide Shaft Alignment Dowel
27	2	Manifold Port Plug
28	8	Retainer Ring (Shaft Wiper "-W" Option only)
29	2	Retainer Ring (Shaft Wiper "-W" Option only)
30*	4	End Cap Mntg Screw
31	4	End Cap Dowel Pins

## \*Notes:

- 1) Contact the Robohand Sales Department for a complete spare parts list with order numbers and prices.
- 2) Quantity of #6 is 4 when ordering a Non-synchronous gripper.
- 3) Items #5, #10, #11, and #26 are for synchronous grippers only.
- 4) Items #12 and #13 are for -W option only.
- 5) Item #17 (Body O-ring) shown in body groove.
- 6) Item #23 Quantity is 6 for 375-1 and 375-2 only.
- 7) Item #30 is only used in 375-1 and 375-2.

## Non-Synchronous Procedure:

- 1) Take DPW synchronous gripper and remove the retaining ring and gear cap.
- 2) Remove jaws from gripper.
- 3) Replace gear cap and retaining ring. The gripper is now non-synchronous

## -W Option Assembly Procedure:

- 1) Take out guide shaft and piston rod mounting screws.
- 2) Remove jaws from guide shafts and piston rods.
- 3) Take out end cap mounting screws and pull off end caps. Take out piston.
- 4) Slide out shafts and press wipers in pockets thru front side. Install retaining rings.
- 5) Replace shafts, pistons, and end caps.
- 6) Be sure to apply thread locker to mounting screws. The gripper now has shaft wipers.



Seal Kit  
Items



Thread  
Locker



Krytox™  
Lubricant



Lightweight  
Machine Oil



Teflon™ Based  
Grease



Super  
Bonder



Third Angle  
Projection

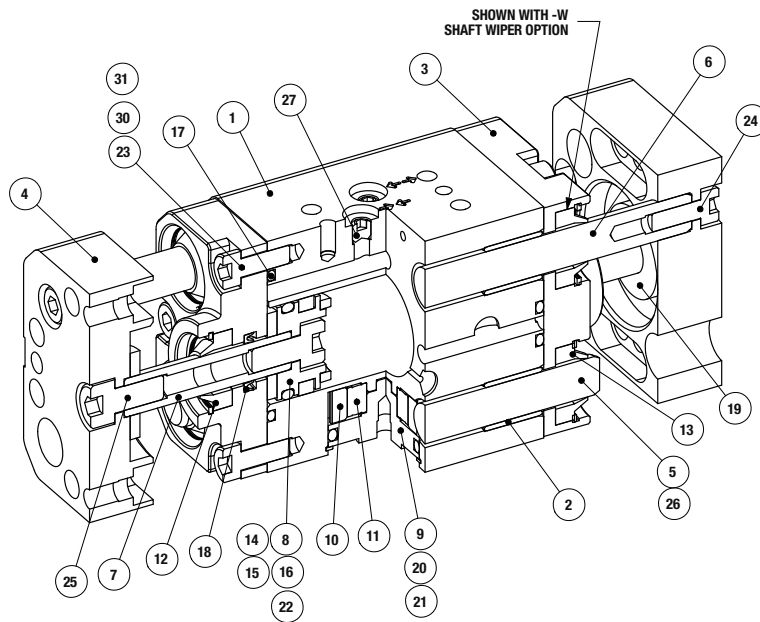

## \*Notes:

- 1) Contact the Robohand Sales Department for a complete spare parts list with order numbers and prices.
- 2) Quantity of #6 is 4 when ordering a Non-synchronous gripper.
- 3) Items #5, #10, #11, and #26 are for synchronous grippers only.
- 4) Items #12 and #13 are for -W option only.
- 5) Item #17 (Body O-ring) shown in body groove.
- 6) Item #23 Quantity is 6 for 375-1 and 375-2 only.
- 7) Item #30 is only used in 375-1 and 375-2.

Item	Qty	Name
01	1	Body
02	8	Bushing, Oil Impregnated Bronze
03	2	End Cap
04	2	Jaw
05*	2	Guide Shaft, Rack
06*	2	Guide Shaft (Qty 4 for NS)
07	2	Piston Rod
08	2	Piston
09	1	Cap, Gear
10*	1	Gear
11*	1	Bearing, Radial
12*	2	Piston Rod Wiper (Shaft Wiper "-W" option only)
13*	8	Shaft Wiper (Shaft Wiper "-W" option only)
14	2	Piston Bumper
15	2	Piston O-Ring
16	2	Teflon Ring
17*	2	Body O-Ring
18	2	U-cup
19	2	Jaw Bumper
20	1	Gear Cap O-ring
21	1	Retaining ring
22	1	Magnet
23	8	End Cap Mntg Screw
24	4	Guide Shaft Mntg Screw
25	4	Piston Shaft Mntg Screw
26*	2	Guide Shaft Alignment Dowel
27	2	Manifold Port Plug
28	8	Retainer Ring (Shaft Wiper "-W" Option only)
29	2	Retainer Ring (Shaft Wiper "-W" Option only)
30*	4	End Cap Mntg Screw
31	4	End Cap Dowel Pins

## Accessory Installation & Adjustment Instructions

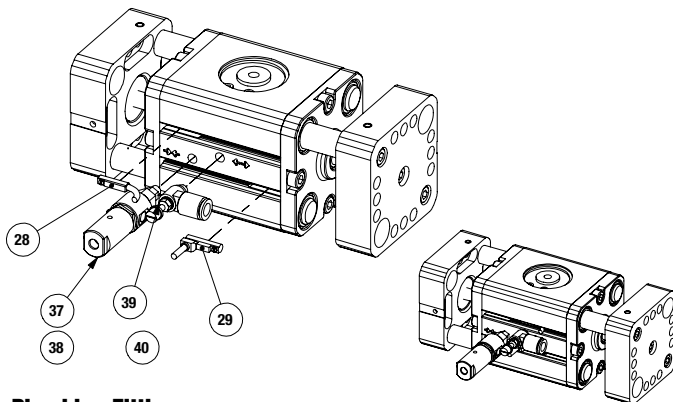

### Plumbing Fittings:

- 1) Flow Controls #39 or #40 can be inserted and used in any open or closed airport to help control the stroke actuation.
- 2) Fail-Safe Valve #37 or #38 can be used in either the open or closed airport to help limit the possibility of dropping the part if air pressure is lost.

### Magneto-Resistive Sensors:

- 1) Insert sensors #28 or #29 into the opening at the end of the profile slot and lock the sensor into position with the integrated screw.

### Inductive Sensors:

- 1) Mount inductive sensor target (#32) to jaw using mounting screw (#36).
- 2) Insert sensor bracket (#33) into slot of body.
- 3) Insert sensor (#30 or #31) into appropriate 3mm or 4mm opening in bracket and adjust sensor depth so that sensor light indicates target (#32).
- 4) Tighten sensor locking screw (#34).
- 5) Position sensor bracket for desired stroke detection.
- 6) Tighten sensor bracket with set screw (#35) to lock stroke detection position.

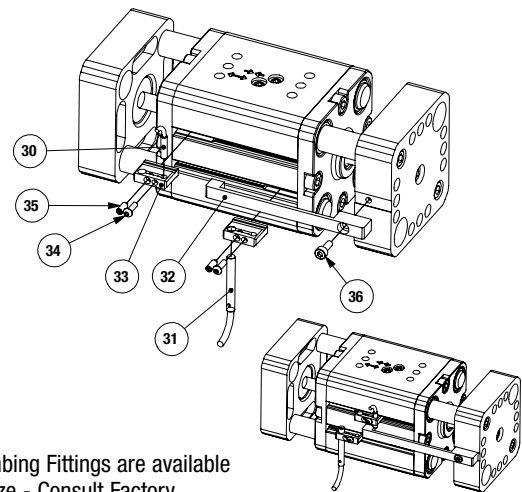

Other Plumbing Fittings are available for each size - Consult Factory

Item	Qty	Name
28	1,2	Magneto Resistive Sensor (short barrel) w/Qk. Disconnect
29	1,2	Magneto Resistive Sensor (90° barrel) w/Qk. Disconnect
30	1,2	Inductive Sensor (3mm) w/Qk. Disconnect
31	1,2	Inductive Sensor (4mm) w/Qk. Disconnect (DPW-375 & 500 only)
39	1,2	Adjustable Flow Control (Imperial) #10-32 elbow - 1/4" OD Push-in Style
40	1,2	Adjustable Flow Control (Metric) M5 elbow - 6mm OD Push-in Style
37	1	Fail Safe Valve (Imperial) #10-32
38	1	Fail Safe Valve (Metric) M5

## DPW SERIES SPECIALS

**Smaller or Larger Bores**  
**Metallic Rod Scrapers**  
**Extended Strokes**  
**Alternate Materials**  
**and more...**

Drawings are for concept only.  
Contact Robohand Tech Support  
with project requirements.

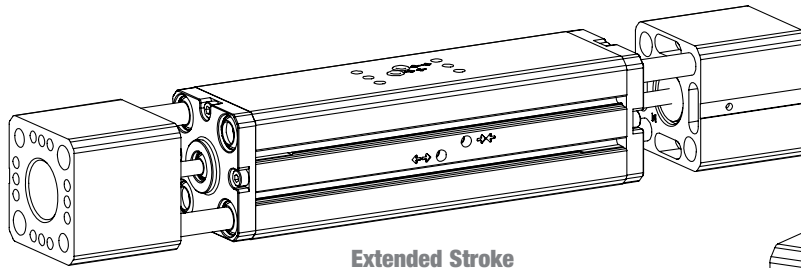

**Extended Stroke**

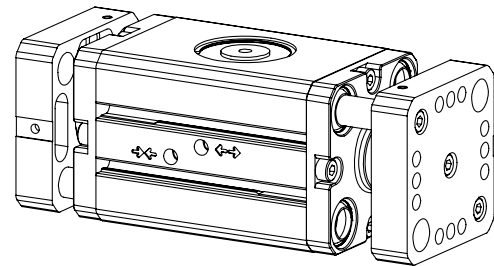

**Fixed Jaw**

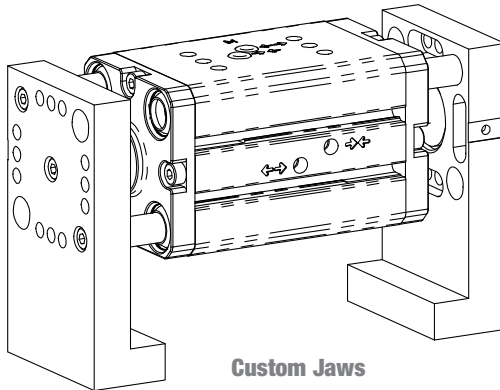

**Custom Jaws**

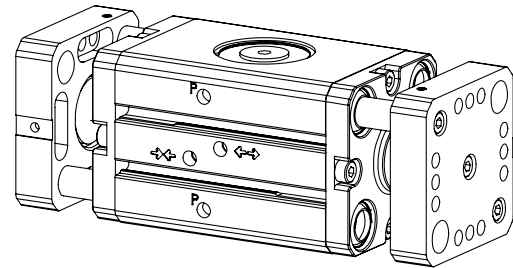

**Purge Port**

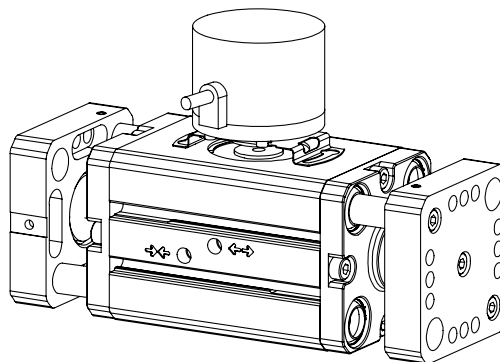

**Multi-Positioning Sensing**

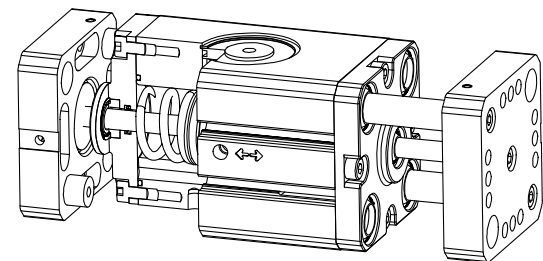

**Spring Assist**