

## Control Module & Repair Parts

### Two-Hand Control Module

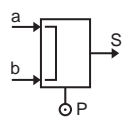

PXPA11

| Part Number | Connections   |
|-------------|---------------|
| PXPA11      | 5/32" Instant |

### Dimensions

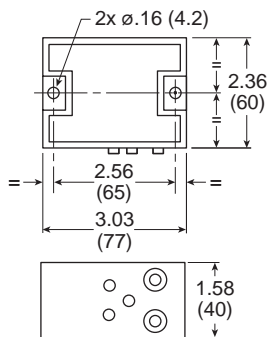

PXPA11

### Specifications

#### Air Quality –

Standard Shop Air, Lubricated or Dry, 40µm Filtration

Flow at 90 PSI (6 bar) in SCFM (l/mn ANR) ..... 7 (200)

#### Materials –

Body ..... Polyamide

Operating Head ..... Zinc Alloy & Plastic

Nominal Bore Ø in Inches (mm) ..... 7/64" (2.5)

Number of Operations with Dry Air at 90 PSI (6 bar) and 68°F (20°C) - Frequency 1 Hz ..... 1 million Operations

Operating Positions ..... All Positions

Operating Pressure ..... 40 to 115 PSIG (3 to 8 bar)

#### Ports –

5/32" Instant for Semi-Rigid Nylon or Polyurethane Tube

#### Temperature –

Operating ..... 32°F to 122°F (0°C to + 50°C)

Storage ..... -22°F to 140°F (-30°C to + 60°C)

#### Vibration resistance:

Conforms to section 19-2 of bureau Véritas regulations (November 1987)

### WARNING

These devices should **NOT** be used in any application involving rotary clutch presses. Two hand control modules do not of themselves insure the safety of any machine. Users and original equipment manufacturers are responsible for making sure that installations meet all relevant safety regulations.

**Notes:** These two-hand control modules provide an output signal upon nearly concurrent operation of two pushbuttons.

### Two-Hand Control Module Guard



PPRL15

| Part Number | Base Component |
|-------------|----------------|
| PPRL15      | PXPC111        |

### Two Hand Repair Parts

| Part Number | Quantity Required | Description                |
|-------------|-------------------|----------------------------|
| PXPA11      | 1                 | Control Module             |
| PXBB3111B   | 2                 | Valve Body & Mounting Ring |
| ZB4BR*      | 2                 | Push Button                |
| PPRL15      | 2                 | Control Module Guard       |

\* 2 = Black, 3 = Green, 4 = Red