



Parker Hannifin Corporation
Pneumatic Division North America
8676 East M89
Richland, MI 49083

Office 269 629 5000
Fax 269 629 5385

Pressure Protection Valve



Features:

- Multiple connection options
- Composite & Brass options available
- DOT fittings included
- High flow
- Built-in screen
- Compact & lightweight
- Integrated swivel function

Technical Description

Pressure protection valves (PPV) insure that the air brakes, which are supplied from the primary reservoir, always have adequate pressure to function normally. This is a normally closed pressure sensing valve which allows air to flow freely in both directions as long as the upstream (primary) reservoir pressure is above the set point of the valve. Typical set points range from 55 ± 5 psi to 85 ± 5 psi. If a downstream failure occurs or during start up, the primary tank pressure may drop, thus causing the PPV outlet to shut off, in order to maintain the primary reservoir pressure.

Specifications:

- Flow.....104 SCFM at 100 psi inlet
(See table)
- Port Size..... inlet
M22 (Standard)
3/8" & 1/2" NPT also available
outlet
1/4"-1/2" DOT (standard)
3/8" & 1/2" NPT also available
- Operating Pressure...150 PSI max
(10 bar)
- Temperature.....-40F to 200F
(-40C to 93C)
- Materials:
 - Connector.....Brass
 - Plastic
 - Body.....Brass
 - Seat.....Steel
 - Slide guide.....Plastic
 - Spring.....Stainless Steel
 - Seals.....Buna N
- Weight.....0.26 lbs

PPV Comparison 100 PSIG inlet

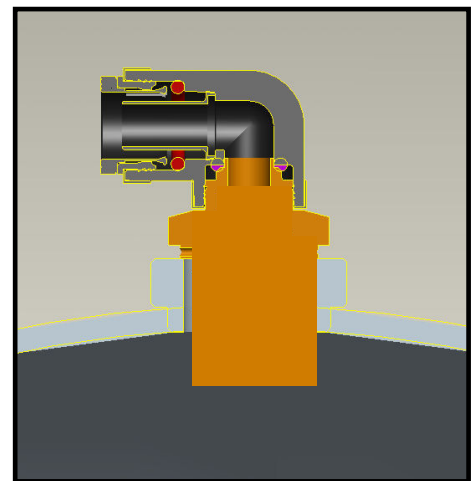
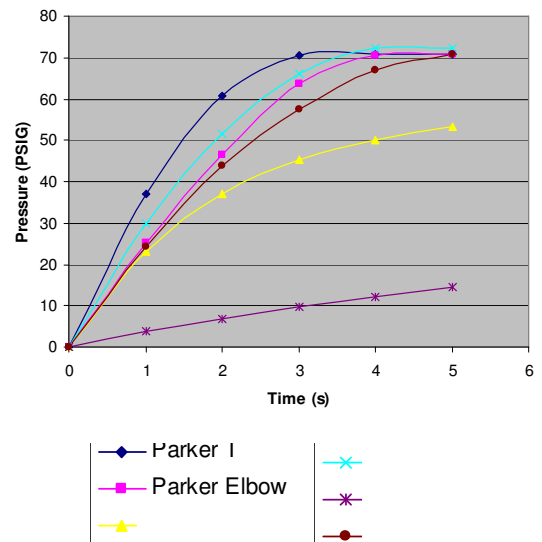

Dimensions:

90 degree elbow configuration shown

