

**A**

**L255 Mist Lubricators – Hi-Flow**



**Features**

- Port Blocks (PB) Available to Provide 1-1/2" Port Extension to 1" Ported Bodies
- Proportional Oil Delivery Over a Wide Range of Air Flows
- Bowl Can be Filled While Air Line is Under Pressure
- Transparent Sight Dome for 360° Visibility
- All Hardware Necessary for Modular Connection to Other QUBE 255 Series is Included
- High Flow: 3/4" - 230 SCFM<sup>§</sup>  
 1" - 250 SCFM<sup>§</sup>

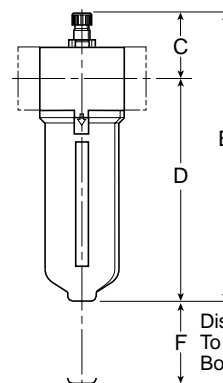
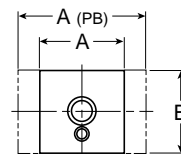

Port Size	NPT Metal Bowl / Sight Gauge / Manual Drain
3/4"	<b>L255-06W</b>
1"	<b>L255-08W</b>

L255 Lubricator Dimensions			
A	A (PB)	B	C
3.62 (92)	5.91 (150)	3.62 (92)	2.81 (71)
D	E	F	
9.00 (229)	11.81 (300)	4.92 (125)	

**Bold Items are Most Popular.**

For other models refer to ordering information below.

§ SCFM = Standard Cubic Feet Per Minute at 90 PSIG Inlet, and 5 PSIG Pressure Drop.

Inches  
(mm)

**Ordering Information**

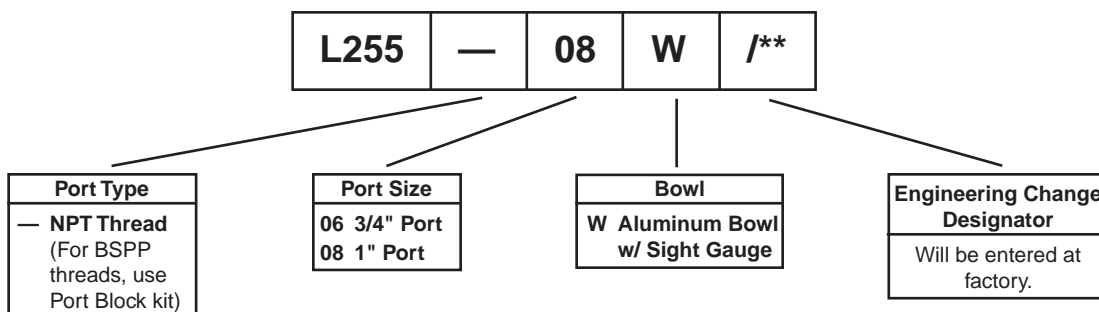

**BOLD ITEMS ARE MOST POPULAR.**



**Technical Information**

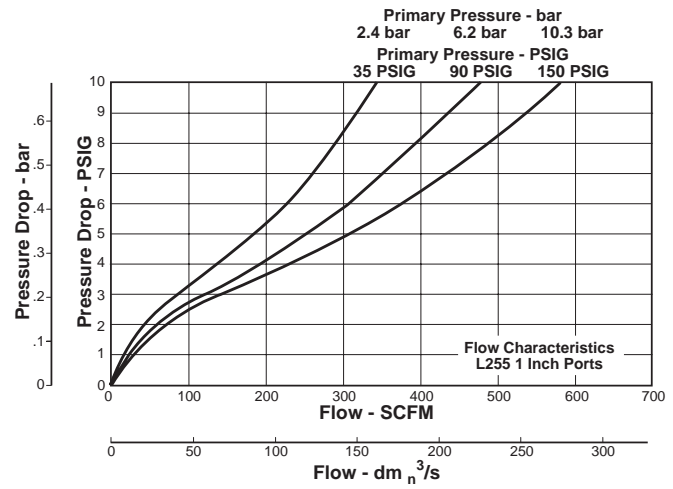
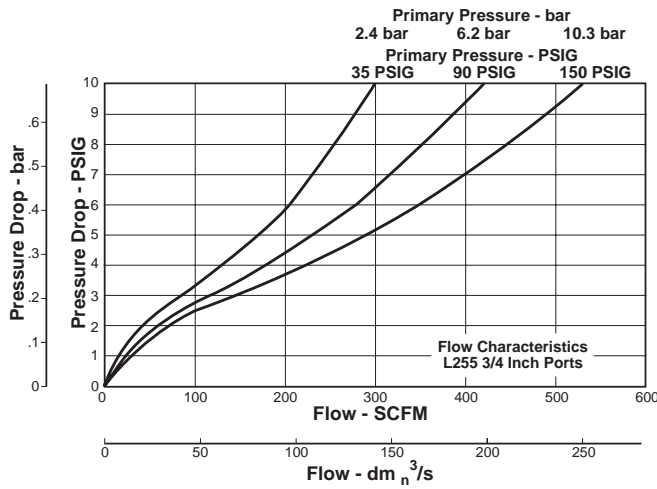

**L255 Lubricator Kits & Accessories**

- Adjustment Knob ..... P04121
- Bowl Kits –**
- Metal Bowl – Sight Gauge / Manual Drain.....P3NKA00BSM
- Drain Kit –**
- Manual Drain .....PS512
- Fill Cap Kit** ..... P3NKA00PL
- Sight Dome Kit –**
- Polycarbonate.....PS740
- Nylon ..... PS740N
- Sight Gauge Kit**..... P3NKA00PE
- Oil –**
- 1 Gal. .... F442002
- 12 Quart Case ..... F442003
- 4 Gallon Case..... F442005
- Pressure Fill Adapter Kit** ..... P3NKA00PK
- Service Kit**..... P3NKA00RL
- Mounting Bracket Kit** ..... P3NKA00MW
- Port Block Kit (1-1/2" NPT Ports)** ..... P3NKB9BCL

**Specifications**

- Bowl Capacity** ..... 18.0 Ounces
- Minimum Flow for Lubrication** ..... 6.6 SCFM At 100 PSIG
- Pressure & Temperature Rating** ..... 0 to 250 PSIG (0 to 17.2 bar)  
 32°F to 175°F (0°C to 80°C)
- Suggested Lubricant** ..... F442 Oil
- Petroleum-based oil of 100 to 200 SUS viscosity at 100°F and an aniline point greater than 200°F
- (DO NOT USE OILS WITH ADDITIVES, COMPOUNDED OILS CONTAINING SOLVENTS, GRAPHITE, DETERGENTS, OR SYNTHETIC OILS.)
- Weight –**
- 3/4" ..... 3.5 lb. (1.6 kg)
- 1" ..... 3.5 lb. (1.6 kg)

**Materials of Construction**

- Body, Bowl** ..... Aluminum
- Drains: Manual Drain** ..... Plastic
- Injector Meter Block & Base Assembly** ..... Plastic
- Seals** ..... Nitrile
- Sight Dome** ..... Polycarbonate
- Sight Gauge** ..... Polyamide (Nylon)

