

Snap-tite NGV1 Profile High Flow Receptacle



Snap-tite's high flow receptacles are designed for permanent mounting to heavy duty natural gas vehicles (CNG).

Snap-tite's high flow receptacle utilizes the NGV1 profile which allows complete interchangeability to any nozzle conforming to the NGV1 standard.

Features

- ▶ Heavy duty construction
- ▶ Superior poppet check valve design prevents gas flow when the nozzle is disconnected
- ▶ Leak free regardless of temperature and pressure
- ▶ Connects to any NGV1 compliant nozzle
- ▶ Quick and efficient performance
- ▶ Excellent flow characteristics
- ▶ Polyurethane crimped seal eliminates erosion and washout

Working Pressure: 3000 psi (207 bar) and
3600 psi (248 bar)

Burst Pressure: 25,000 psi (1724 bar)

Temperature Range: -40°F (-40°C) to
250°F (121°C)

Weight: .70 lbs. (.32 kgs)

Flow Rate: 3200 SCFM (5400 Nm³/hr)

Material: 316 Stainless Steel

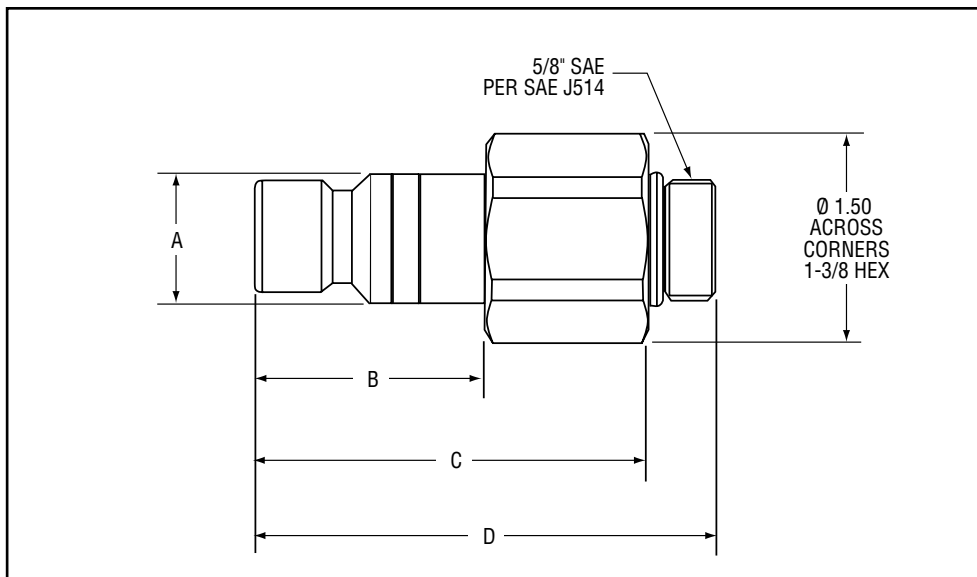
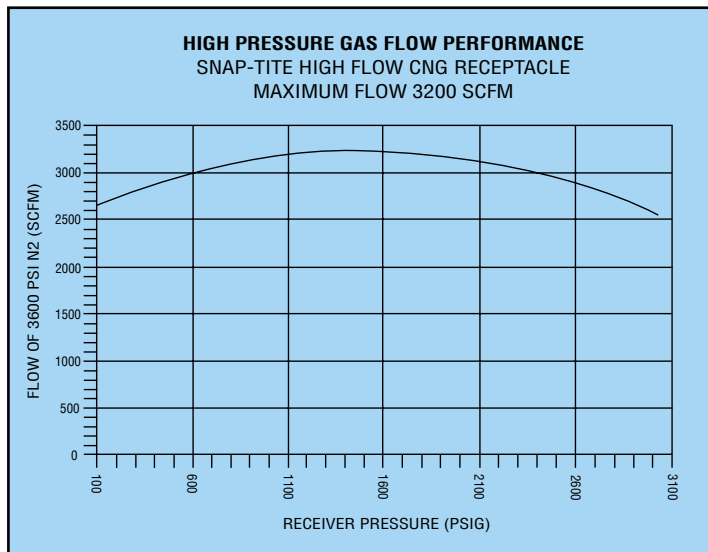

PART NUMBER	A	B	C	D
HNGVN5-P30	.984 (25)	1.69 (43)	2.88 (73.2)	3.38 (85.9)
HNGVN5-P36	.945 (24)	1.69 (43)	2.88 (73.2)	3.38 (85.9)

See Page 16 (How to Order)

in (mm)