

## General Description

Series GF valves isolate gages from damage and inaccurate readings caused by line pressure surges and hydraulic hammer.

## Operation

The GF uses a capillary orifice to smooth out line pulsations and surges without the use of any moving parts.

## Features

- One piece construction.
- The GF requires no adjustment or maintenance.

## Specifications

<b>Maximum Operating Pressure</b>	207 Bar (3000 PSI)
-----------------------------------	--------------------

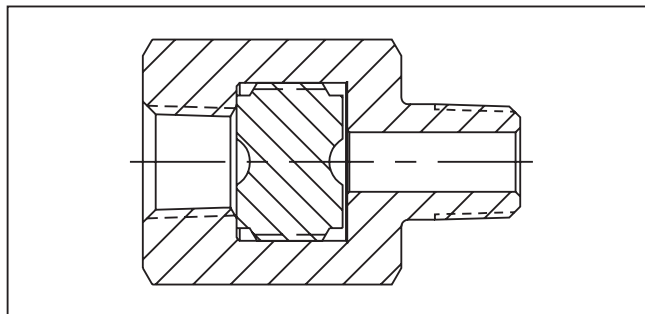
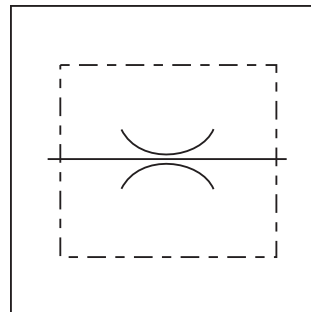

## Ordering Information

Options	
Code	Description
Omit	NPTF/SAE
★9	BSPP

★ Code 9 can be used with size 400

Series GF	
Size	
Code	Description
400	1/4"
420	7/16 - 20 UNF (SAE 4)

Material S	
Code	Description
S	Steel

Design Series  
 NOTE:  
 Not required when ordering.

**Weight:** 0.6 kg (1.3 lbs.)

## Dimensions

Inch equivalents for millimeter dimensions are shown in (\*\*)

