

Door Guide System

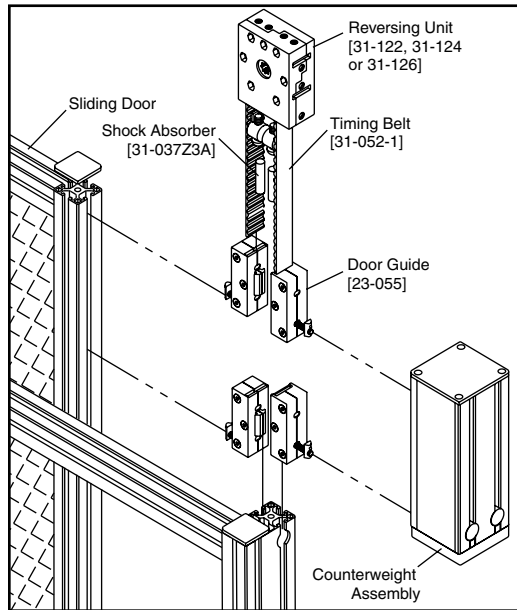

- 1 Assembly of the Door Guide System
- 2 Sliding Door with two counterweights
- 3 Assembly of the Door Guide
- 4-5 Counterweight Assemblies 80x80 and 160x80

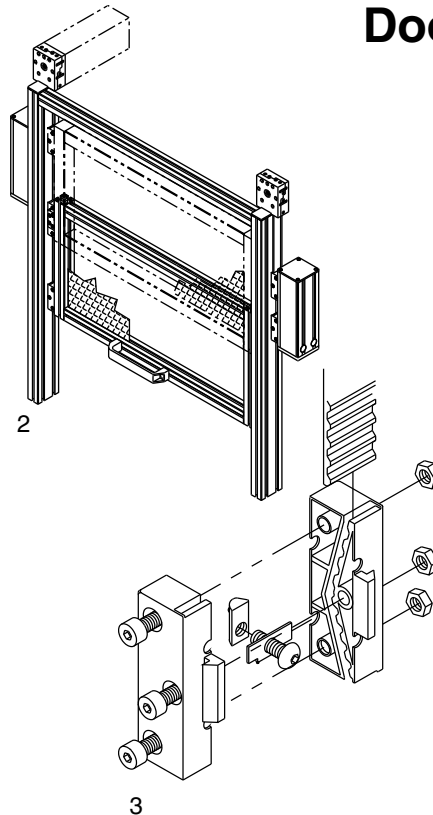

Application

Door guides are used to build doors that operate between two vertical 40 series profiles. The weight of the door may be counter-balanced by one or two counterweights that are connected to the door space with door guides, timing belt 25T10 and reversing unit 40.

The size of the counterweight is determined by the weight of the door. The operation of the door may be motorized by attachment of a suitable drive to one of the reversing units.

Door Guides

Four guides are usually attached to the door, and slide in the inside slots of the vertical 40 series profiles. Two guides are attached to each of the counterweights, and slide in the outer slots of the vertical frame profiles.

Ordering Information

Description	Unit	Weight	Part #
Door Guide	1 set	0.12 kg	23-055
Closure Plate 80x80	1 set	0.48 kg	21-155
Closure Plate 160x80	1 set	0.96 kg	21-156

Counterweights

Duct wall support and wall profiles are used to build the counterweight. A closure plate attached with four M6 Profile-to-Wall Fasteners forms the bottom of the counterweight. Heavy metal scrap may be used as filler material. Suitable conduit cap is used to close the top of the counterweight.

Closure Plate

St, black epoxy finish
Complete with fastening set

Technical Data

Door Guide: Polyoxymethylen, black

Complete with the following:
Steel plate insert, M6x25 BHCS,
M6 T-slot nut St, three M6x25 SHCS,
and three M6 hex nuts

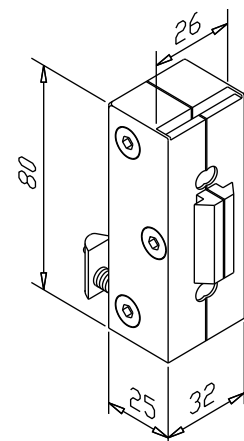

23-055

