

# Conduit Elements

Conduit profiles provide a convenient way to integrate cable, hose and control components to an IPS structural assembly or linear system.

These anodized aluminum profiles are modular and provide great flexibility and are easy to assemble. The dimensions are based on 40mm increments and are compatible with all standard IPS elements.

Assembled conduit sections may be attached to any IPS profile using standard T-slot fastening methods. Reference grooves allow for accurate positioning of any necessary holes or machining.

IPS conduit profiles offer snap-together assembly that can be secured with optional locking screws.

## Modular Dimensions

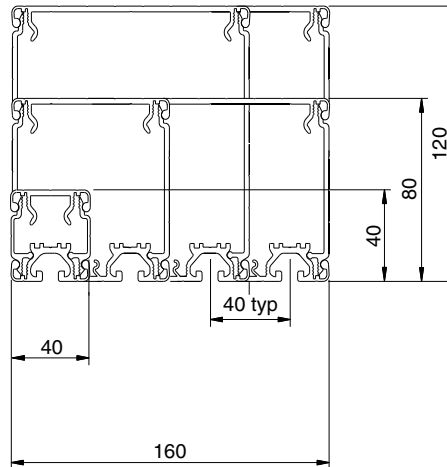

The conduit is made up of high tensile strength aluminum elements:

- Wall duct profile 40, 80 and 120
- Conduit support profile 40, 80, 120 and 160 (with or without T-slot)

Wall duct profiles of any required length are snapped into a support profile. Another support profile closes the duct with a "snap in" fit. The conduit may be secured with screws where necessary.

## Assembly of Conduit Elements

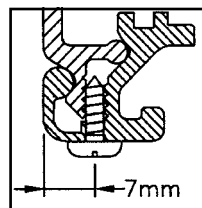
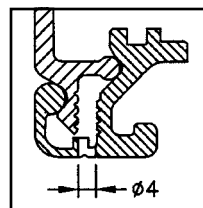
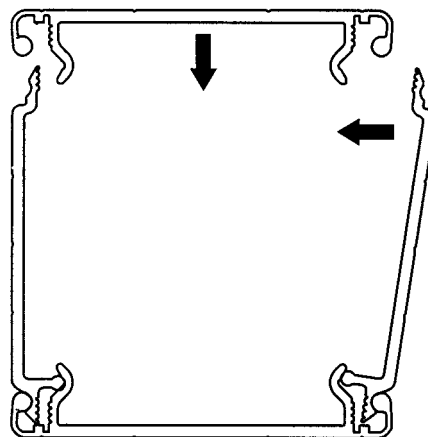

1 Scored groove for locating locking screw (24-695) in Support Profile.

2 Locking screw turned into the pre-extruded threads of the support wall profiles.

# Conduit Cross Section Guide

Type	Item #	Dimensions H x W [mm]	Qty	Wall Part#	Qty	Support Part #1	Qty	Support Part #2	Area [cm <sup>2</sup> ]	Area [inch <sup>2</sup> ]
Conduits Without T-Slots	1	40x40	2	15-042	2	15-040	—	—	16.00	2.48
	2	40x80	2	15-042	2	15-080	—	—	32.00	4.96
	3	40x120	2	15-042	2	15-120	—	—	48.00	7.44
	4	40x160	2	15-042	2	15-160	—	—	64.00	9.92
	5	80x40	2	15-082	2	15-040	—	—	32.00	4.96
	6	80x80	2	15-082	2	15-080	—	—	64.00	9.92
	7	80x120	2	15-082	2	15-120	—	—	96.00	14.88
	8	80x160	2	15-082	2	15-160	—	—	128.00	19.84
	9	120x40	2	15-122	2	15-040	—	—	48.00	7.44
	10	120x80	2	15-122	2	15-080	—	—	96.00	14.88
	11	120x120	2	15-122	2	15-120	—	—	144.00	22.32
	12	120x160	2	15-122	2	15-160	—	—	192.00	29.76
Conduits With T-Slots on one Side	13	40x40	2	15-042	1	15-040	1	15-041	9.20	1.43
	14	40x160	2	15-042	1	15-160	1	15-161	36.80	5.70
	15	80x40	2	15-082	1	15-040	1	15-041	25.20	3.91
	16	80x160	2	15-082	1	15-160	1	15-161	100.80	15.62
	17	120x40	2	15-122	1	15-040	1	15-041	41.20	6.39
	18	120x160	2	15-122	1	15-160	1	15-161	164.80	25.54
Conduits with T-Slots on Both Sides	19	80x160	2	15-082	2	15-161	—	—	73.60	11.41
	20	120x160	2	15-122	2	15-161	—	—	137.60	21.33
Conduits with Partitions	21	40x160	5	15-042	1	15-160	1	15-041	36.80	5.70
	22	80x160	5	15-082	1	15-160	1	15-161	100.80	15.62
	23	160x160	5	15-122	1	15-160	1	15-161	164.80	25.54

# Cross Sections

**Conduits without T-slots**

- 1 40x40
- 2 40x80
- 3 40x120
- 4 40x160
- 5 80x40
- 6 80x80
- 7 80x120
- 8 80x160
- 9 120x40
- 10 120x80
- 11 120x120
- 12 120x160

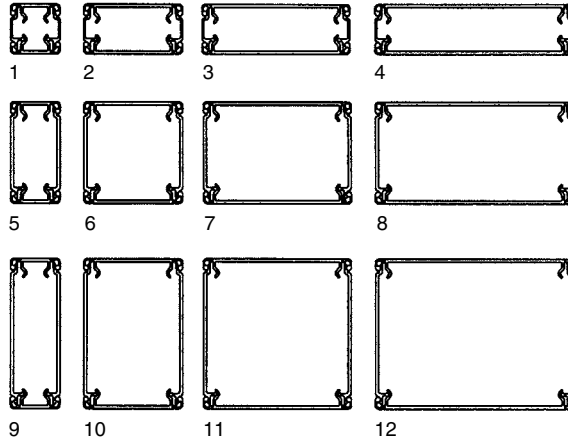

**Conduits with T-slots on one side**

- 13 40x40
- 14 40x160
- 15 80x40
- 16 80x160
- 17 120x40
- 18 120x160

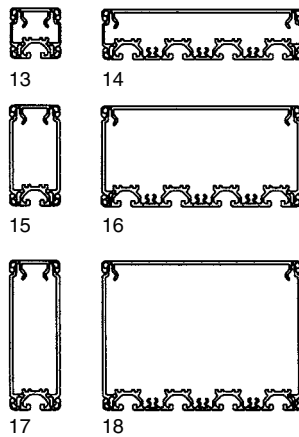

**Conduits with T-slots on both sides**

- 19 80x160
- 20 120x160

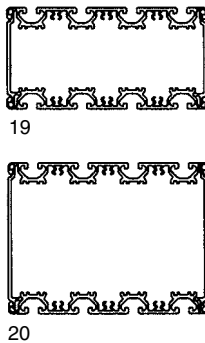

**Conduits with Partitions**

- 21 40x160
- 22 80x160
- 23 160x160

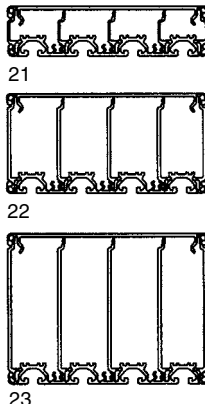

## Conduit Support

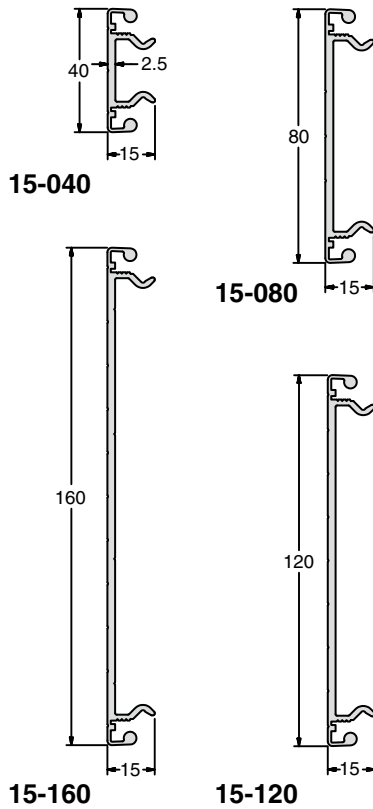

### Application

Bottom or cover components for conduit assemblies. Wall Duct profiles snap in for fast applications. Locking screw (24-695) can be added to secure the assembly and provide ground continuity between profiles members.

### Technical Data

Aluminum, Clear Anodized	
Weight	kg/pc
15-040	1.96
15-080	3.04
15-120	3.92
15-160	5.00

### Ordering Information

Description	Unit	Part #
Conduit Support 40	4m each	15-040
Conduit Support 80	4m each	15-080
*Saw Cut Needed for Cut to Length		19-001
Conduit Support 120	4m each	15-120
Conduit Support 160	4m each	15-160
*Saw Cut Needed for Cut to Length		19-002

*Sold in full pieces only.*

## Conduit Support with T-Slot

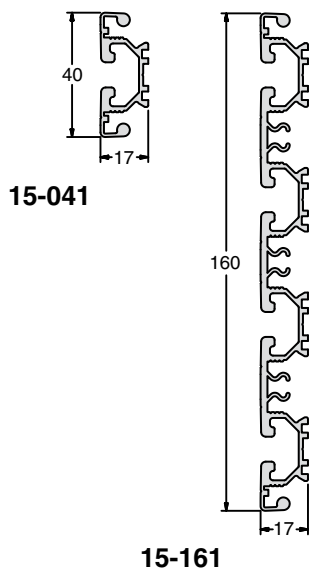

### Application

Bottom or cover components for conduit assemblies with 40 Series T-Slots on external face for mounting with standard hardware. Wall Duct Profiles can be used to create partitions.

### Technical Data

Aluminum, Clear Anodized	
Weight	kg/pc
15-041	2.40
15-161	9.16

### Ordering Information

Description	Unit	Part #
Conduit Support 40 W/ T-Slot	4m each	15-041
*Saw Cut Needed for Cut to Length		19-001
Conduit Support 160 W/T-Slot	4m each	15-161
*Saw Cut Needed for Cut to Length		19-002

*Sold in full pieces only.*

## Wall Duct Profiles

### Application

This profile creates the sides of the conduit assembly and can be used to create partitioned spaces within assemblies using T-Slotted top and bottom supports.

### Technical Data

Aluminum, Clear Anodized

Weight	kg/pc
15-042	0.84
15-082	2.20
15-122	3.24

### Ordering Information

#### Description

Conduit Wall Duct 40

Conduit Wall Duct 80

Conduit Wall Duct 120

\*Saw Cut Needed for Cut to Length

*Sold in full pieces only.*

#### Unit

4m each

4m each

4m each

#### Part #

15-042

15-082

15-122

19-001

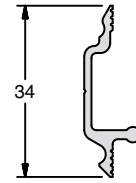

**15-042**

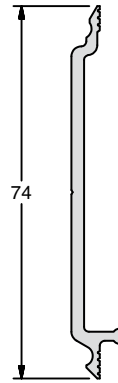

**15-082**

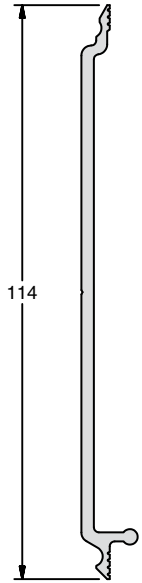

**15-122**

# Conduit End Caps

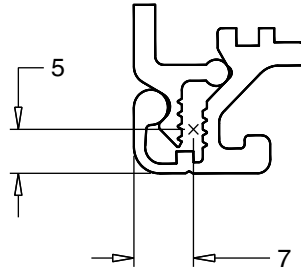
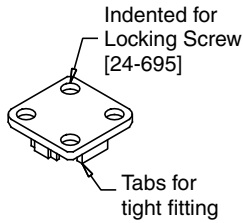

Recommended location of 5mm hole for locking screw on custom conduit caps (note orientation).

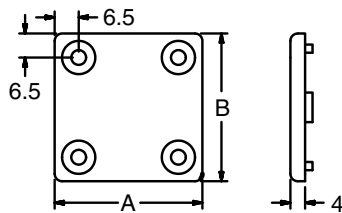

## Application

### End Caps

Face covering for sealing the end openings of conduit assemblies. Not for use on 40 Series profiles.

### Locking Screw

Securely fastens support and wall profiles and breaks the anodized coating creating a positive ground between profile members.

## Technical Data

End Caps  
 Glass-filled nylon, Black

Locking Screw  
 Steel, Galvanized  
 4.2 x 9.5mm, DIN 7971

## Ordering Information

Description [AxB]	Unit	Part #	Weight
Conduit Cap 40x40	1 pc	15-803	8g
Conduit Cap 40x80	1 pc	15-804	14g
Conduit Cap 40x120	1 pc	15-810	30g
Conduit Cap 40x160	1 pc	15-806	30g
Conduit Cap 80x80	1 pc	15-805	30g
Conduit Cap 80x120	1 pc	15-811	50g
Conduit Cap 80x160	1 pc	15-807	58g
Conduit Cap 120x120	1 pc	15-812	70g
Conduit Cap 120x160	1 pc	15-813	90g
Locking Screw 4.2 x 9.5	1 pc	24-695	2g