

SC² Series SC 190 to SC 925
Soft Contact and Self-Compensating



SC² Series Miniature Shock Absorbers

provide dual performance benefits. They offer **soft contact deceleration** where initial impact reaction forces are very low, with the advantages of **self-compensation** to react to changing energy conditions, without adjustment. They have long stroke lengths, **SC² 925 with 1.58 inch (40 mm) superstroke**, to provide smooth deceleration and low reaction forces.

With the addition of the **optional side load adapter** (SC² 190M, 300M, and 650M models only), SC² Series shock absorbers can handle side loads up to 25°. SC² Series shock absorbers are fully interchangeable with the adjustable MA range.

Applications include: material handling, medium robotics, machine tools, pick and place systems, rodless cylinders and packaging equipment.

Ordering Information

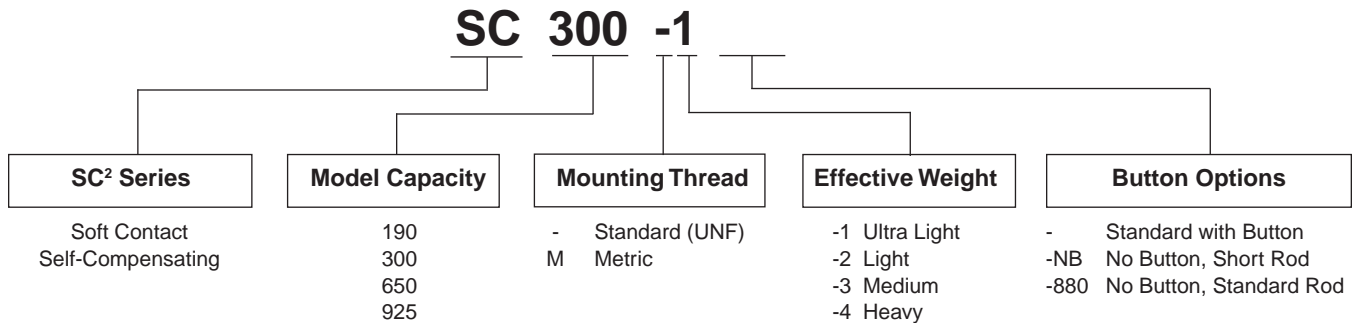

SC² Series SC 190 to SC 925
Soft Contact and Self-Compensating

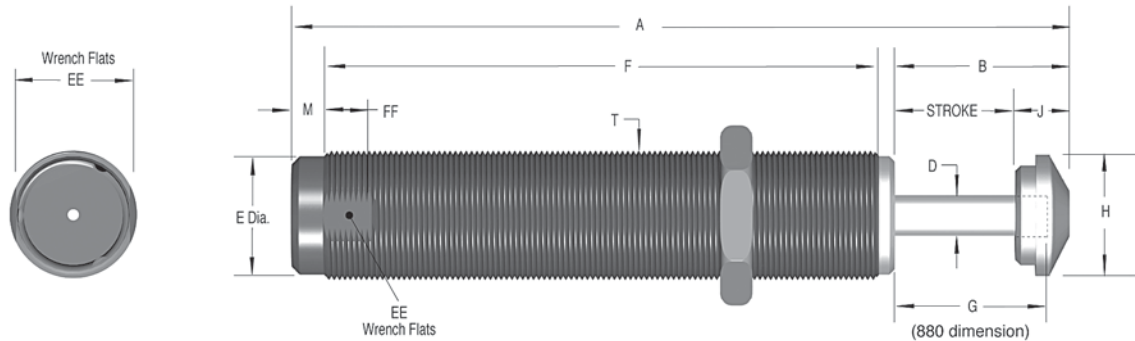

Dimensions In Inches (Millimeters)													
Model	Stroke	A	B	D	E	F	G	H	J	M	T	EE	FF
SC 190 SC 190M	.63 (16.0)	4.50 (114.3)	1.06 (26.9)	.16 (4.1)	.46 (11.7)	3.00 (76.2)	.88 (22.4)	.47 (11.9)	.43 (11.0)	.28 (7.1)	9/16-18 UNF M14x1.5	1/2 (12.0)	.50 (12.7)
SC 300 SC 300M	.75 (19.1)	4.62 (117.5)	1.18 (30.0)	.19 (4.8)	.66 (16.8)	3.09 (78.5)	1.00 (25.4)	.66 (16.8)	.43 (11.0)	.28 (7.1)	3/4-16 UNF M20x1.5	11/16 (18.0)	.50 (12.7)
SC 650 SC 650M	1.00 (25.4)	5.62 (142.6)	1.43 (36.3)	.25 (6.3)	.87 (22.1)	3.83 (97.3)	1.25 (31.8)	.90 (22.9)	.43 (11.0)	.28 (7.1)	1-12 UNF M25x1.5	7/8 (23.0)	.50 (12.7)
SC 925 SC 925M	1.58 (40.0)	7.44 (189.1)	2.01 (51.1)	.25 (6.3)	.87 (22.1)	5.1 (129.5)	1.82 (46.4)	.90 (22.9)	.43 (11.0)	.28 (7.1)	1-12 UNF M25x1.5	7/8 (23.0)	.50 (12.7)

Specifications							
Model	Soft Contact We Effective Weight lbs (kg)	Self-Compensating We Effective Weight lbs (kg)	E3 Energy per Cycle in lbs (Nm)	E4 Energy per Hour in lbs/hour (Nm/hour)	Return Force lbs (N)	Return Time sec	Shipping Weight lbs (kg)
SC 190-1 SC 190-2 SC 190-3 SC 190-4	5 - 13 (2 - 6) 12 - 38 (5 - 18) 30 - 90 (14 - 41) 75 - 200 (34 - 91)	3 - 15 (1.4 - 7) 8 - 40 (4 - 18) 20 - 100 (9 - 45) 50 - 225 (23 - 102)	225 (25) *300 (33)	300,000 (34,000)	0.90 - 1.90 (4.00 - 8.95)	0.25	0.18 (0.08)
SC 300-1 SC 300-2 SC 300-3 SC 300-4	5 - 15 (2 - 7) 15 - 50 (7 - 23) 50 - 150 (23 - 68) 150 - 400 (68 - 181)	3 - 18 (1.4 - 8) 10 - 60 (5 - 27) 30 - 180 (14 - 82) 70 - 450 (32 - 204)	300 (33) *500 (56)	400,000 (45,000)	1.05 - 2.15 (4.67 - 9.56)	0.10	0.25 (0.11)
SC 650-1 SC 650-2 SC 650-3 SC 650-4	24 - 80 (11 - 36) 75 - 250 (34 - 113) 240 - 800 (109 - 363) 800 - 2400 (363 - 1089)	17 - 100 (8 - 45) 50 - 300 (23 - 136) 150 - 900 (68 - 408) 450 - 2600 (204 - 1180)	650 (73) *1,000 (113)	600,000 (68,000)	2.40 - 6.87 (10.67 - 30.55)	0.20	0.67 (0.31)
SC 925-1 SC 925-2 SC 925-3 SC 925-4	50 - 160 (22 - 72) 130 - 460 (59 - 208) 400 - 1,350 (181 - 612) 1200 - 4300 (544 - 1952)	30 - 200 (14 - 90) 90 - 600 (40 - 272) 250 - 1,600 (113 - 726) 750 - 4600 (340 - 2088)	975 (110) *1,700 (192)	800,000 (90,000)	2.40 - 7.40 (10.67 - 30.55)	0.40	0.87 (0.39)

Technical Data
Impact velocity range: 0.5 to 12 ft/sec (0.15 to 3.66 m/sec)
Operating temperature: 32° to 150°F (0° to 66°C)
Mechanical stop: Integral mechanical stop built into front of units.
Oil type: #5
Materials: Steel body with black oxide finish. Hardened stainless steel piston rod.

Technical data applies to standard and metric threaded models.
 Maximum side load depends on application. For additional information contact The Actuator Division.
 Lock nut included with each shock absorber.