

# Chelsea® 435 Series

Two Gear Mechanical P.T.O.



## Overview:

The Chelsea 435 P.T.O. is another example of why Chelsea P.T.O. technology is the best in the business. This economical workhorse features a cast iron housing and tapered cone bearing on the output shaft, giving it a high torque rating and long service life. The deep reach gear design allows it to mount to Hino LF06S and LJ06S transmissions without the need for special adapters. The space saving air shift cover provides maximum clearance under the truck. Seven output options and two shift options make this one versatile P.T.O. Take advantage of over 65 years of Chelsea P.T.O. technology to increase performance and lower costs.

- Aerial
- Snow & Ice Removal
- Fire and Rescue
- Dump Truck and Trailer
- Service Trucks

## Contact Information:

Parker Hannifin Corporation  
**Chelsea Products Division**  
8225 Hacks Cross Road  
Olive Branch, MS 38654 USA

**Phone: 1-888-PH4-TRUK**  
**(1-888-744-8785)**

**Fax: 1-662-895-1069**  
**chelseacustserv@parker.com**

[www.parker.com/chelsea](http://www.parker.com/chelsea)



## Product Features and Benefits:

- Deep reach housing design eliminates the need for special adapters
- Torque ratings up to 175 Lbs. ft.
- Rotatable pump flanges for maximum clearance
- Seven (7) output options
- Two (2) Shift options
- Two Year warranty



ENGINEERING YOUR SUCCESS.

## Model Number Designator

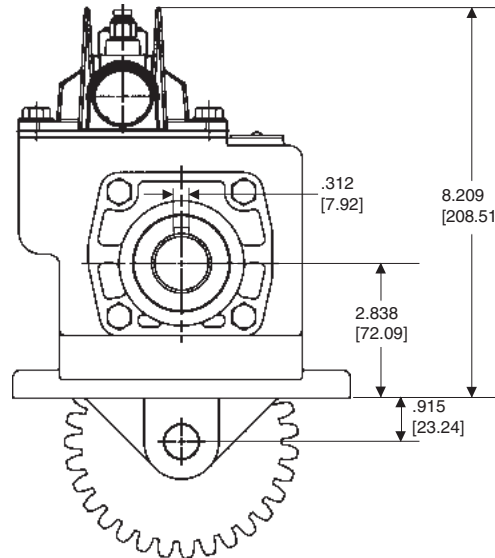
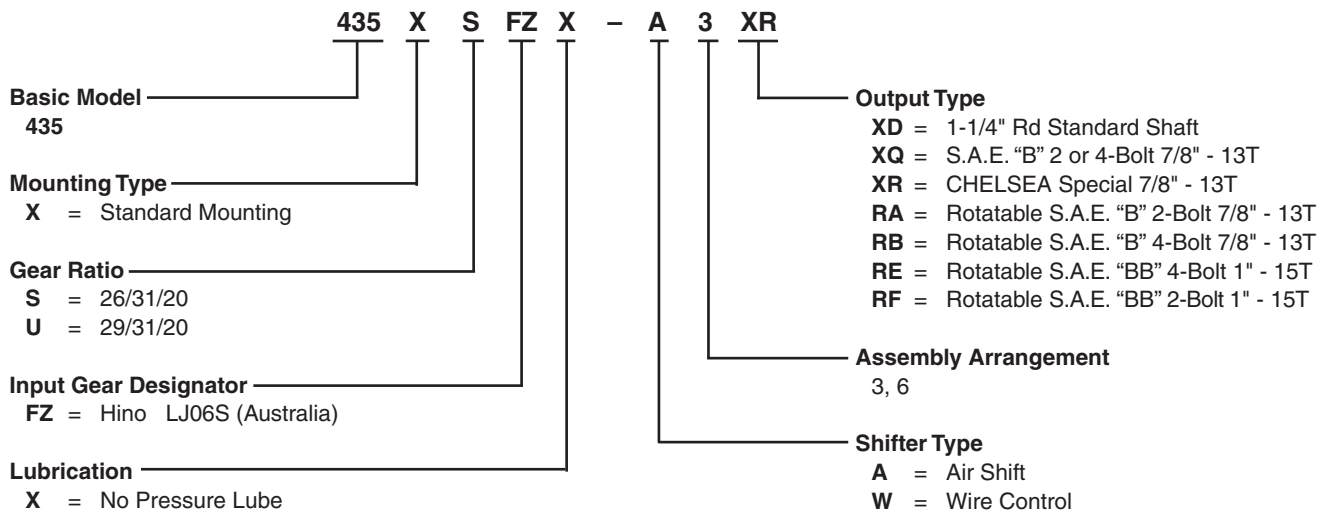

### Series Specifications Chart – 435 Series

	435*S	435*U
Standard Output Shaft Size	1-1/4" Round w/key	
Intermittent Torque Rating (Lbs. ft.)	175	175
Intermittent Torque Rating (N.m.)	237	237
Horsepower Rating for Intermittent Service		
At 500 R.P.M. of the Output Shaft (HP)	17	17
At 1000 R.P.M. of the Output Shaft (HP)	33	33
At 500 R.P.M. of the Output Shaft (Kw)	12	12
At 1000 R.P.M. of the Output Shaft (Kw)	25	25
Approximate Weight:	37 lbs. [17 kg]	