

Chelsea® 290 Series

Two Gear Mechanical P.T.O.



Overview:

The Chelsea 290 P.T.O. is another example of why Chelsea P.T.O. technology is the best in the business. This economical workhorse features a cast iron housing and tapered cone bearing on the output shaft, giving it a high torque rating and long service life. The deep reach gear design allows it to mount to Eaton Fuller 4106 transmissions and Mack T2060A transmissions without the need for special adapters. The space saving air shift cover provides maximum clearance under the truck. The 290 Series features sixteen output options which includes our popular 360° rotatable flange that will provide you with optimum pump clearance. Three internal speed ratios and five shift options make this one versatile P.T.O. Take advantage of over 65 years of Chelsea P.T.O. technology to increase performance and lower costs.

- Aerial
- Snow & Ice Removal
- Fire and Rescue
- Dump Truck and Trailer
- Service Trucks



Contact Information:

Parker Hannifin Corporation
Chelsea Products Division
8225 Hacks Cross Road
Olive Branch, MS 38654 USA

Phone: 1-888-PH4-TRUK
(1-888-744-8785)

Fax: 1-662-895-1069
chelseacustserv@parker.com

www.parker.com/chelsea

Product Features and Benefits:

- Deep reach housing design eliminates the need for special adapters
- Two Year warranty
- Torque ratings up to 175 Lbs. ft.
- 16 output options
- Rotatable pump flanges for maximum clearance
- 3 Speed ratios
- 5 Shift options



ENGINEERING YOUR SUCCESS.

Model Number Designation

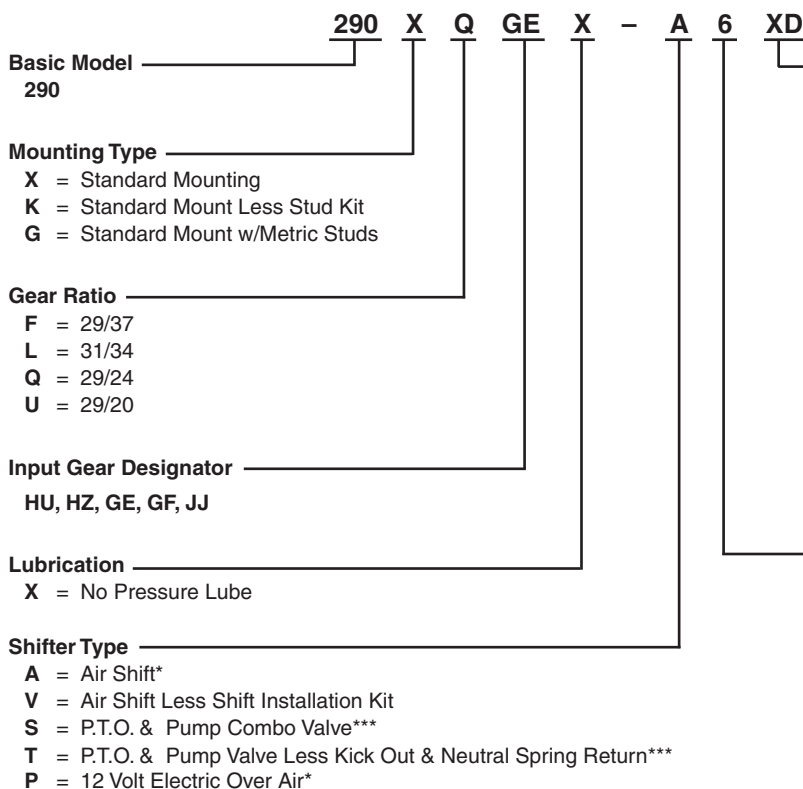

Output Designation

- XD** = 1-1/4" Rd Standard Shaft
- XE** = S.A.E. "A" 2 or 4-Bolt 5/8" - 9T
- XG** = S.A.E. "A" 2-Bolt 3/4" Rd
- XJ** = S.A.E. "A" 2-Bolt 3/4" Rd
- XK** = S.A.E. "B" 2 or 4-Bolt 7/8" - 13T**
- XR** = CHELSEA Special 7/8" - 13T
- XX** = Tapered Output Shaft
- XY** = DIN 5462 8T
- AF** = S.A.E. "BB" 2 or 4-Bolt 1" - 15T
- AK** = S.A.E. "B" 2-Bolt 7/8" - 13T
- RA** = Rotatable S.A.E. "B" 2-Bolt 7/8" - 13T
- RB** = Rotatable S.A.E. "B" 4-Bolt 7/8" - 13T
- RC** = Rotatable S.A.E. "A" 2-Bolt 5/8" - 9T
- RE** = Rotatable S.A.E. "BB" 4-Bolt 1" - 15T
- RF** = Rotatable S.A.E. "BB" 2-Bolt 1" - 15T
- RY** = Rotatable DIN 5462 8T

Assembly Arrangement

3, 4, 5, 6

*Includes mounting parts

**Available on "Q" ratio only

***Includes installation kit, console sold separately

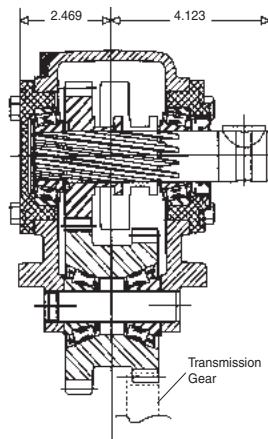
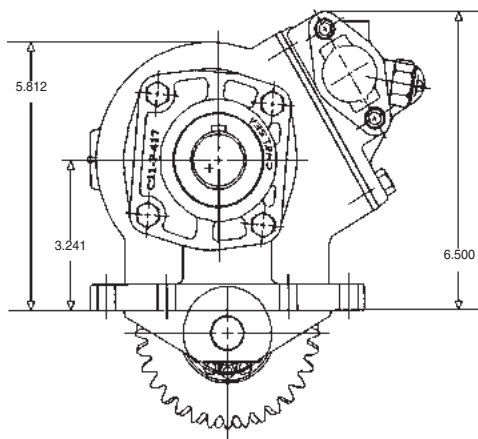

Series Specifications Chart – 290 Series

	290*F	290*L	290*Q	290*U
Standard Output Shaft Size	1-1/4" Round w/key			
Intermittent Torque Rating (Lbs. ft.)	175	175	175	175
Intermittent Torque Rating (N.m.)	237	237	237	237
Horsepower Rating for Intermittent Service				
At 500 R.P.M. of Output Shaft (HP)	17	17	17	17
At 1000 R.P.M. of Output Shaft (HP)	33	33	33	33
At 500 R.P.M. of Output Shaft (Kw)	12	12	12	12
At 1000 R.P.M. of Output Shaft (Kw)	25	25	25	25
Approximate Weight:	37 lbs. [16.8 kg]			