

Chelsea® 221 Series

Two Gear Mechanical P.T.O.



Overview:

The Chelsea 221 P.T.O. is another example of why Chelsea P.T.O. technology is the best in the business. This economical workhorse features a cast iron housing and tapered cone bearing on the output shaft, giving it a high torque rating and long service life. The space saving air shift cover provides maximum clearance under the truck. The 221 has strong tapered output bearings instead of needle bearings for greater load bearing capability. The 221 Series P.T.O. features thirty-three output options including Chelsea's popular 360° rotatable flange. Three internal speed ratios and ten shift options plus a self-lube option for transmissions that have problems getting lubrication to the P.T.O. make this one versatile P.T.O. Take advantage of over 65 years of Chelsea P.T.O. technology to increase performance and lower costs.

- Dump Trucks
- Aerial Devices
- Tow and Recovery

Contact Information:

Parker Hannifin Corporation
Chelsea Products Division
8225 Hacks Cross Road
Olive Branch, MS 38654 USA

Phone: 1-888-PH4-TRUK
(1-888-744-8785)

Fax: 1-662-895-1069
chelseacustserv@parker.com

www.parker.com/chelsea



Product Features and Benefits:

- Low speed, heavy duty applications on both Manual and Automatic transmissions
- Available with both a standard housing or a special low-profile housing
- Pressure Lube option
- Wide range of pump flanges
- 33 Output options
- 10 Shift options
- Two Year Warranty
- Torque rating up to 250 Lbs ft.



ENGINEERING YOUR SUCCESS.

Model Number Designation

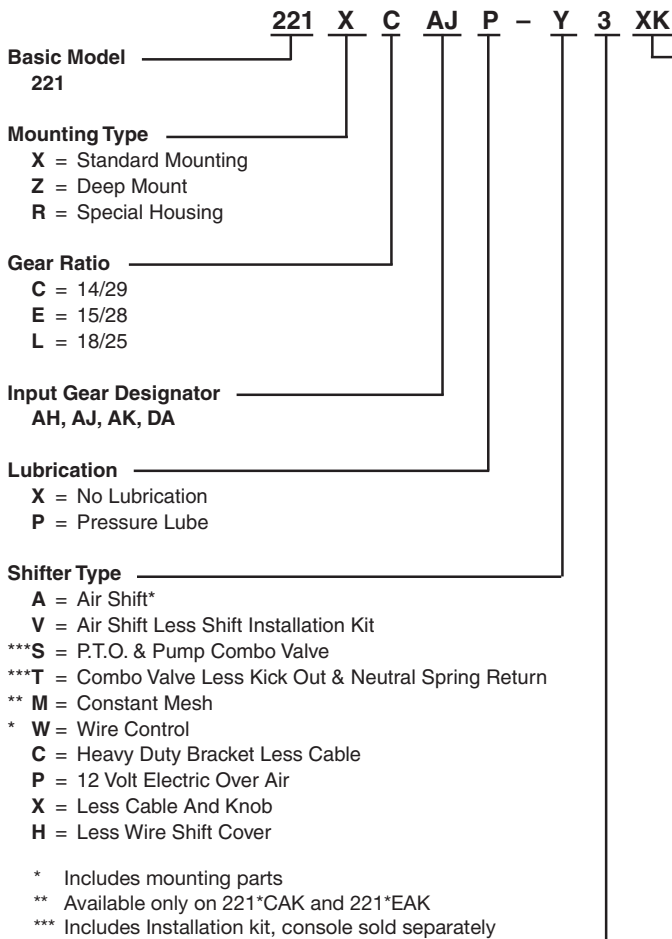

Output Designation

XD = 1-1/4" Rd Standard Shaft
XE = S.A.E. "A" 2 or 4-Bolt 5/8" - 9T
XG = S.A.E. "A" 2-Bolt 3/4" Rd
XJ = S.A.E. "A" 2-Bolt 3/4" Rd
XK = S.A.E. "B" 2 or 4-Bolt 7/8" - 13T
XQ = S.A.E. "B" 2 or 4-Bolt 7/8" - 13T
XR = CHELSEA Special 7/8" - 13T
XX = Tapered Output Shaft
XY = DIN 5462 8T
AK = S.A.E. "B" 2-Bolt 7/8" - 13T
AF = S.A.E. "BB" 2 or 4-Bolt 1" - 15T
AZ = S.A.E. "B" 4-Bolt 1-1/4" - 14T
RA = Rotatable S.A.E. "B" 2-Bolt 7/8" - 13T
RB = Rotatable S.A.E. "B" 4-Bolt 7/8" - 13T
RC = Rotatable S.A.E. "A" 2-Bolt 5/8" - 9T
RE = Rotatable S.A.E. "BB" 4-Bolt 1" - 15T
RF = Rotatable S.A.E. "BB" 2-Bolt 1" - 15T
RY = Rotatable DIN 5462 8T
GA = Greaseable Rot. "B" 2-Bolt 7/8" - 13T
GB = Greaseable Rot. "B" 4-Bolt 7/8" - 13T
GF = Greaseable S.A.E. "BB" 2 or 4-Bolt 1" - 15T
GH = Greaseable Rot. S.A.E. "BB" 2-Bolt 1" - 15T
GK = Greaseable S.A.E. "B" 2 or 4-Bolt 7/8" - 13T
GP = Greaseable S.A.E. "B" 2 or 4-Bolt 7/8" - 13T
GQ = Greaseable S.A.E. "B" 2 or 4-Bolt 7/8" - 13T
GR = Greaseable CHELSEA Special 7/8" - 13T
GY = Greaseable DIN 5462 8T
GZ = Greaseable S.A.E. "B" 4-Bolt 1-1/4" - 14T
LA = S.A.E. "B" 2-Bolt w/Self Lube Pump 7/8" - 13T
LB = S.A.E. "A" 2-Bolt w/Self Lube Pump 7/8" - 13T
LC = S.A.E. "B" 2 or 4-Bolt w/Self Lube 7/8" - 13T
LD = 1-1/4" Rd w/Self Lube Pump
LF = S.A.E. "B" 2 or 4-Bolt w/Self Lube 7/8" - 13T

Assembly Arrangement

3, 4, 5, 6

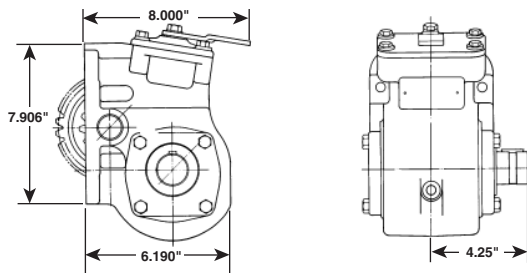

221R

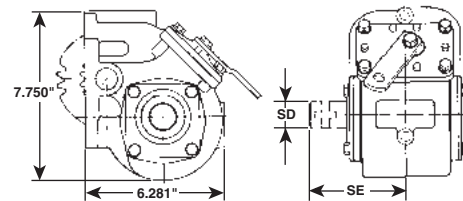

221X & 221Z

Specifications Chart – 221 Series

	221*C	221*E	221*L
Standard Output Shaft Size	1-1/4" Round w/key		
Intermittent Torque Rating (Lbs. ft.)	250	250	200
Intermittent Torque Rating (N.m.)	339	339	271
Horsepower Rating for Intermittent Service			
At 500 R.P.M. of Output Shaft (HP)	24	24	19
At 1000 R.P.M. of Output Shaft (HP)	48	48	38
At 500 R.P.M. of Output Shaft (Kw)	18	18	14
At 1000 R.P.M. of Output Shaft (Kw)	36	36	28
Approximate Weight:	30 lbs. [13.6 kg]		